

oor

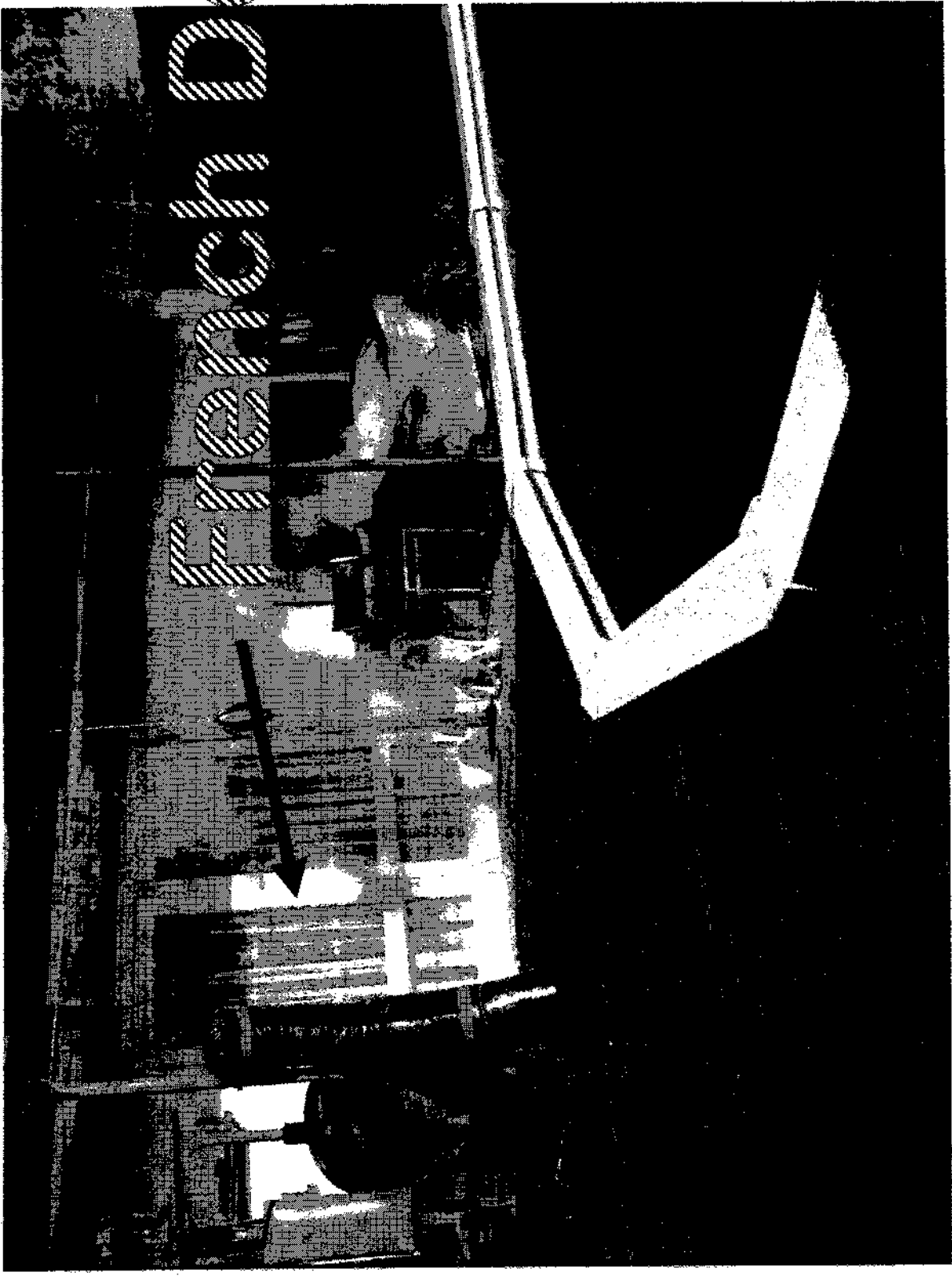

A 21

2/38 Lavelle Road

Exemption Application Form for Spa & Swimming Pools



Send to: Chief Executive
Waitakere City Council
Private Bag 93109
Henderson
WAITAKERE CITY 1231

For more information:
Civic Centre, Waipareira Avenue,
Henderson
Telephone (09) 839 0400
Facsimile (09) 836 8001

9 MAY 2006

Owners Name: Mr Paul William Andrew

Address of pool: 6 River Rd Te Atata Peninsula

Hereby make application for an exemption from the standard fencing controls relating to pools. I propose to make or have already made the following arrangements for the security of my pool:

- 1. New Plans of 6 River Road were drawn up for Council as these were lost or burnt in fire by Council. These new house plans were renovations to be done.
- 2. Council approved on these plans the French Doors. These plans and information given by Council were followed and a Inspector approved these doors.
- 3. We feel we have complied with everything Council has asked and the area is an extremely safe area, as only an adult can open these doors.

Reasons why proposal should be granted: (See reverse) Council's Information on our House Plans are as follows - Final Inspection 26/09/06

Pool Fencing: All existing gates and fences to remain
New Access to Pool 4.2m
New French doors to be fitted with Latches - 1800mm above F.F.L. to abide with the Fencing of Pools Act 1987.

Address for Correspondence: 6 River Rd, Te Atata Peninsula

Application fee: \$250 (one off)

Signature: [Signature]

Telephone Number: 8341433

Date: 9/05/06

RECEIPT C.C. 5457
DATE PAID \$250.00
9/5/06

Note the explanation and requirements on the reverse of this form.

Office Use Only

Site Address: 6 River Rd Te Atata Peninsula

SWP No: 94000370

ABA No: _____
(if applicable)

CONDITIONS OF BUILDING CONSENT ABA 20031051

The above Building Consent has been approved today subject to the following conditions:-

1. To notations on plans.
2. The applicant shall take all steps necessary to avoid damaging the street, footpath or verge area and shall reinstate any damage to those areas to the satisfaction of Council.
3. Where one is not already constructed, the owner shall construct to a standard satisfactory to Council a vehicle crossing between the carriageway and the owner's land.

When excavating for the crossing the owner shall take all steps necessary to avoid damaging Council's watermain, which is generally located in the berm area with 450mm minimum cover. Where more than 250mm is being excavated the depth and location of the watermain should be confirmed by hand digging prior to commencement of excavation. (For further information please contact Council on phone 836-8045). In the event of any damage to the watermain the cost of any repairs will be charged to the owner.

WATERWAY

bdry 16240

IMPORTANT NOTES

All Building consent documents must be kept on site during construction.
Unless the siting or the proposed building is certified by a registered surveyor all boundary pegs are to be flagged prior to work commencing.
A fence on an established site may be taken as the boundary on the written agreement of all neighbours

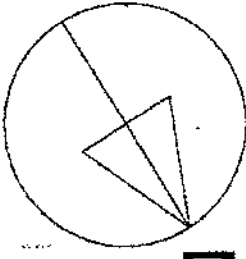

N

POOL FENCING -
ALL EXSTG GATES AND FENCES TO REMAIN.
NEW ACCESS TO POOL AREA:
NEW FRENCH DRs TO BE FITTED WITH LATCHES @ 1800mm ABOVE F.F.L. TO ABIDE WITH THE FENCING OF POOLS ACT 1987

SITE AND IMPERMEABLE COVERAGE: - UNCHANGED

PLUMBING AND DRAINAGE:
NO CHANGE TO EXSTG SERVICES

CLIENT
P & D ARCHER
ADDRESS
6 RIVER RD
TE ATATU NTH
DRAWING TITLE
SITE PLAN
Scale 1:200
Drawn by:
D Heane

10 APR 2009

SITE PLAN
Scale 1:200

SHFFT

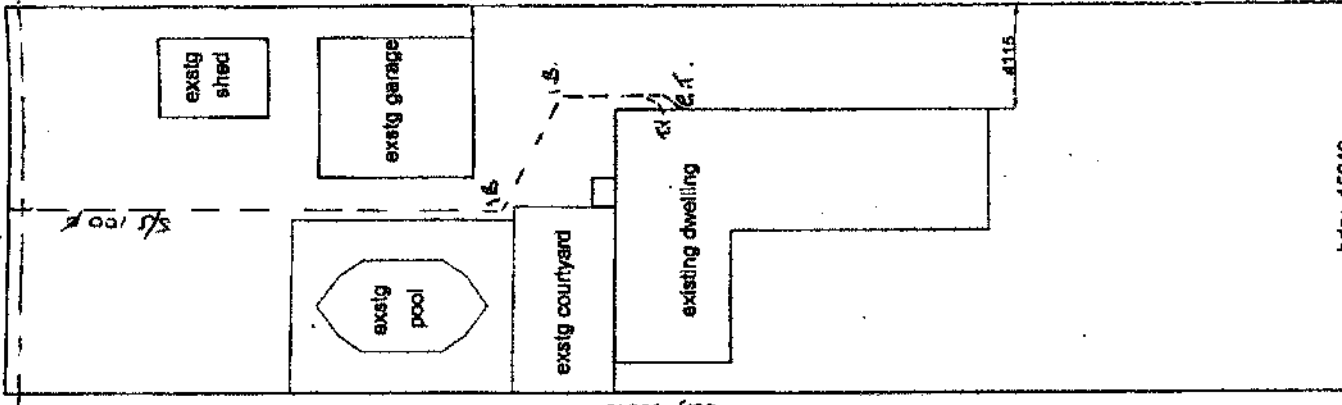

5/16/07
10/6/09 3:56 PM
D Heane

Outward-swinging door

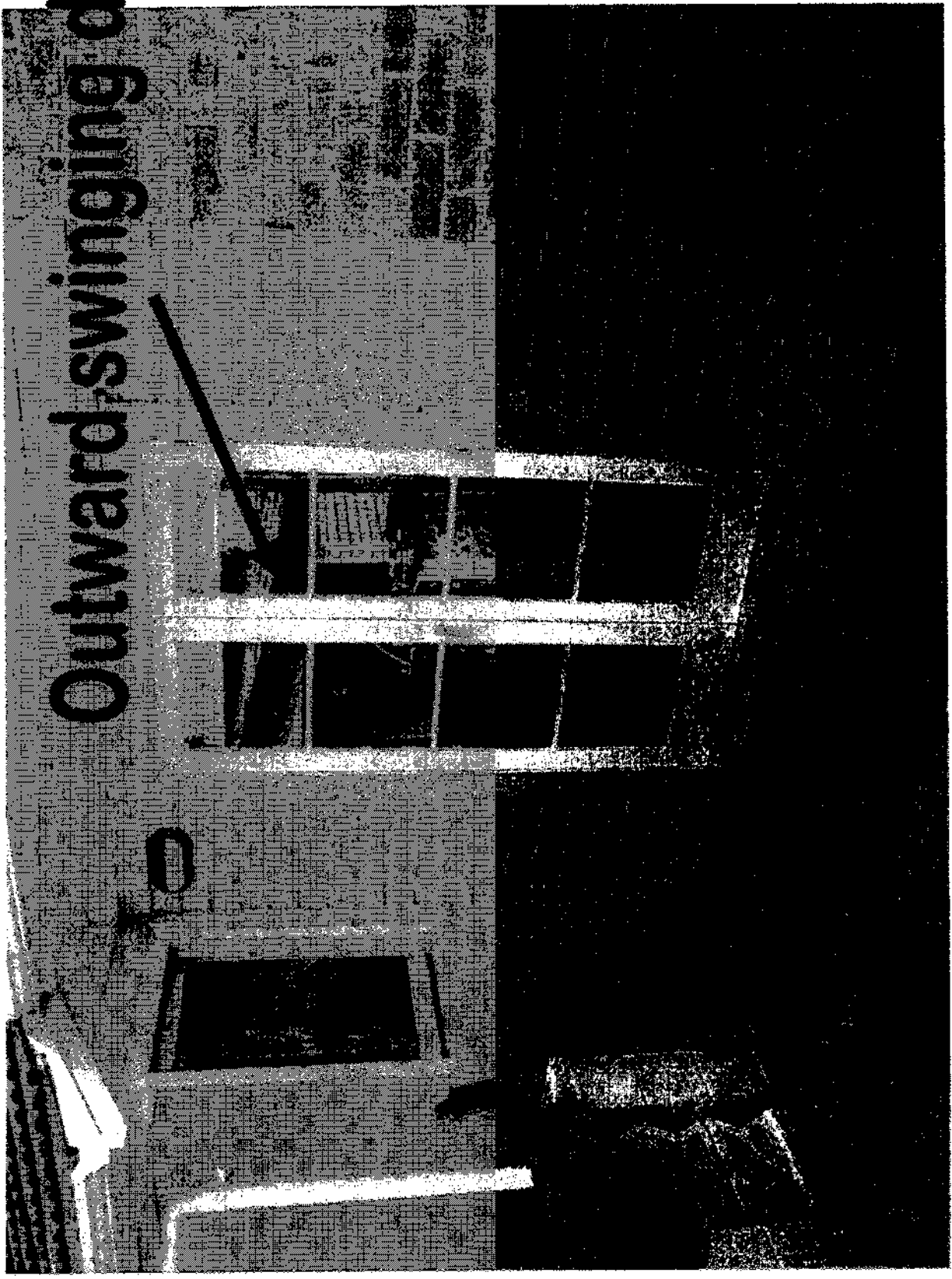

6 River Road

A 25

31 MAY 2006

Exemption Application Form for Spa & Swimming Pools

CHEQUE FOR
\$ 250.00
TO CASHIERS



Send to: Chief Executive
Waitakere City Council
Private Bag 93109
Henderson
WAITAKERE CITY 1231

For more information: ~~CH. AMARIN~~
Civic Centre, Waipareira Avenue,
Henderson
Telephone (09) 839 0400
Facsimile (09) 836 8001

666296

99 00045 23 DA

Owners Name: STEPHEN RONALD WILLS & KAREN JANET WILLS

Address of pool: 153A COLWILL RD MASSEY

Hereby make application for an exemption from the standard fencing controls relating to pools. I propose to make or have already made the following arrangements for the security of my pool:

- ① OUR SPA POOL IS COMPLETELY ENCLOSED BY 4 WALLS.
- ② IT HAS A LOCKABLE SPA POOL COVER
- ③ THE INTERNAL DOOR TO THE SPA ROOM FROM THE GARAGE IS ALWAYS LOCKED UNLESS IN USE.
- ④ THE EXTERNAL DOOR IS PERMANENTLY PADLOCKED & IS NEVER OPENED. IT IS ALSO SELF CLOSING & SELF LOCKING FROM THE INSIDE.

Reasons why proposal should be granted: (See reverse)

IN THE PAST WE HAVE ALWAYS HAD A CODE OF COMPLIANCE FOR THE SPA POOL.
NOW THIS TIME WE WERE TOLD IT DOESN'T COMPLY - YET WE HAVE NOT CHANGED ANYTHING TO THE SPA.

Address for Correspondence: 153A COLWILL RD.

Application fee: \$250 (one off)

Signature: SR Wills

Telephone Number: 09 270 6835 (WORK) or mobile 027 224 1690

Date: 26/5/06

Note the explanation and requirements on the reverse of this form.

- ⑤ OUR PROPERTY IS FULLY FENCED ALSO - MINIMUM HEIGHT IS 1.8M HIGH.

Office Use Only	
Site Address:	
SWP No:	
ABA No: (If applicable)	

Chief Executive	
Corporate Services	
City Services Rosette	
Consultancy Services	
ECO - WATER	
Strategic Group	
Consent Services	
Field Services	<input checked="" type="checkbox"/>

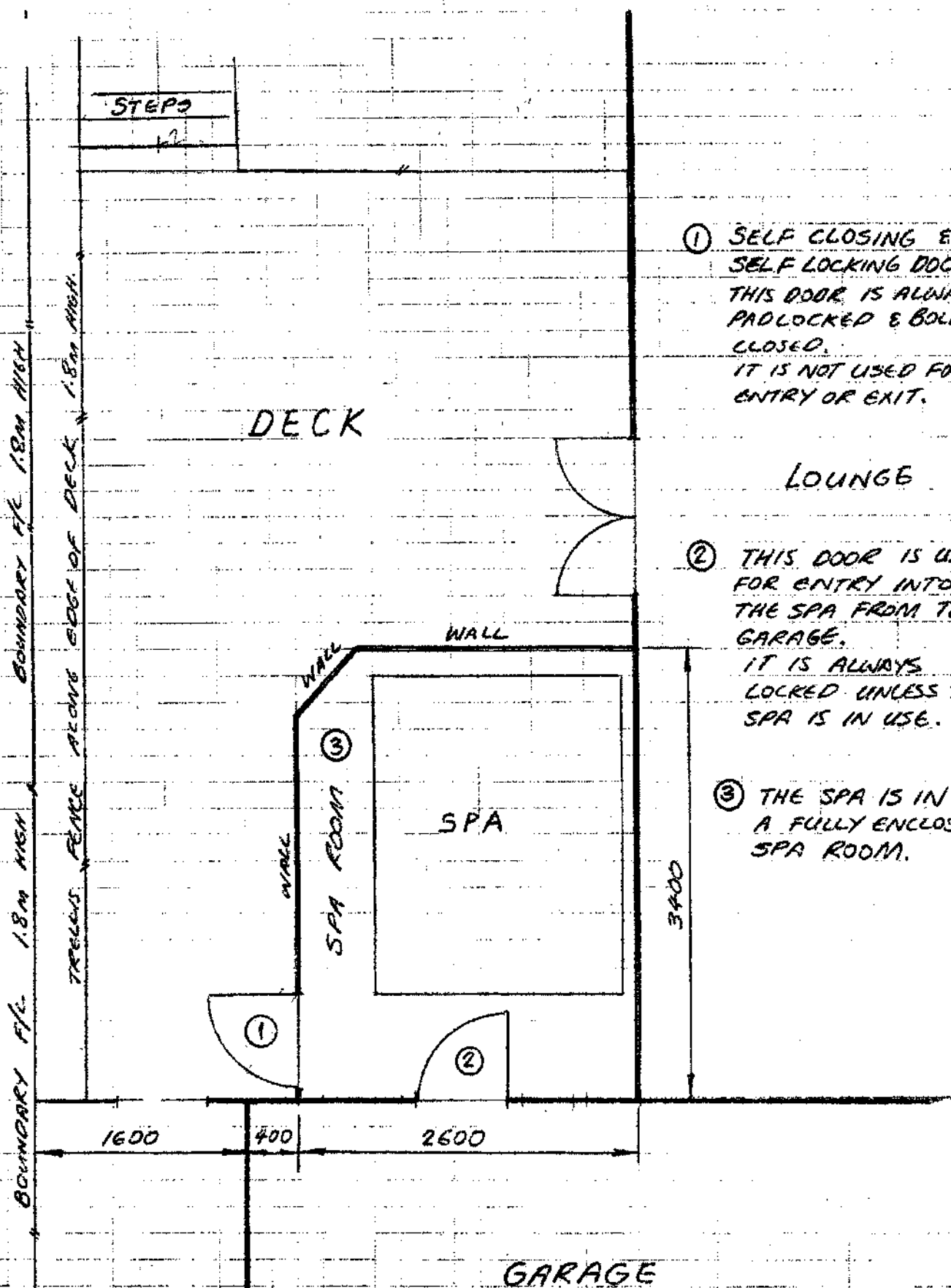

① SELF CLOSING & SELF LOCKING DOOR. THIS DOOR IS ALWAYS PADLOCKED & BOLTED CLOSED. IT IS NOT USED FOR ENTRY OR EXIT.

② THIS DOOR IS USED FOR ENTRY INTO THE SPA FROM THE GARAGE. IT IS ALWAYS LOCKED UNLESS THE SPA IS IN USE.

③ THE SPA IS IN A FULLY ENCLOSED SPA ROOM.

PLAN OF SPA FENCING
 AT 153A COLWILL RD
 MASSEY

Inward swinging door

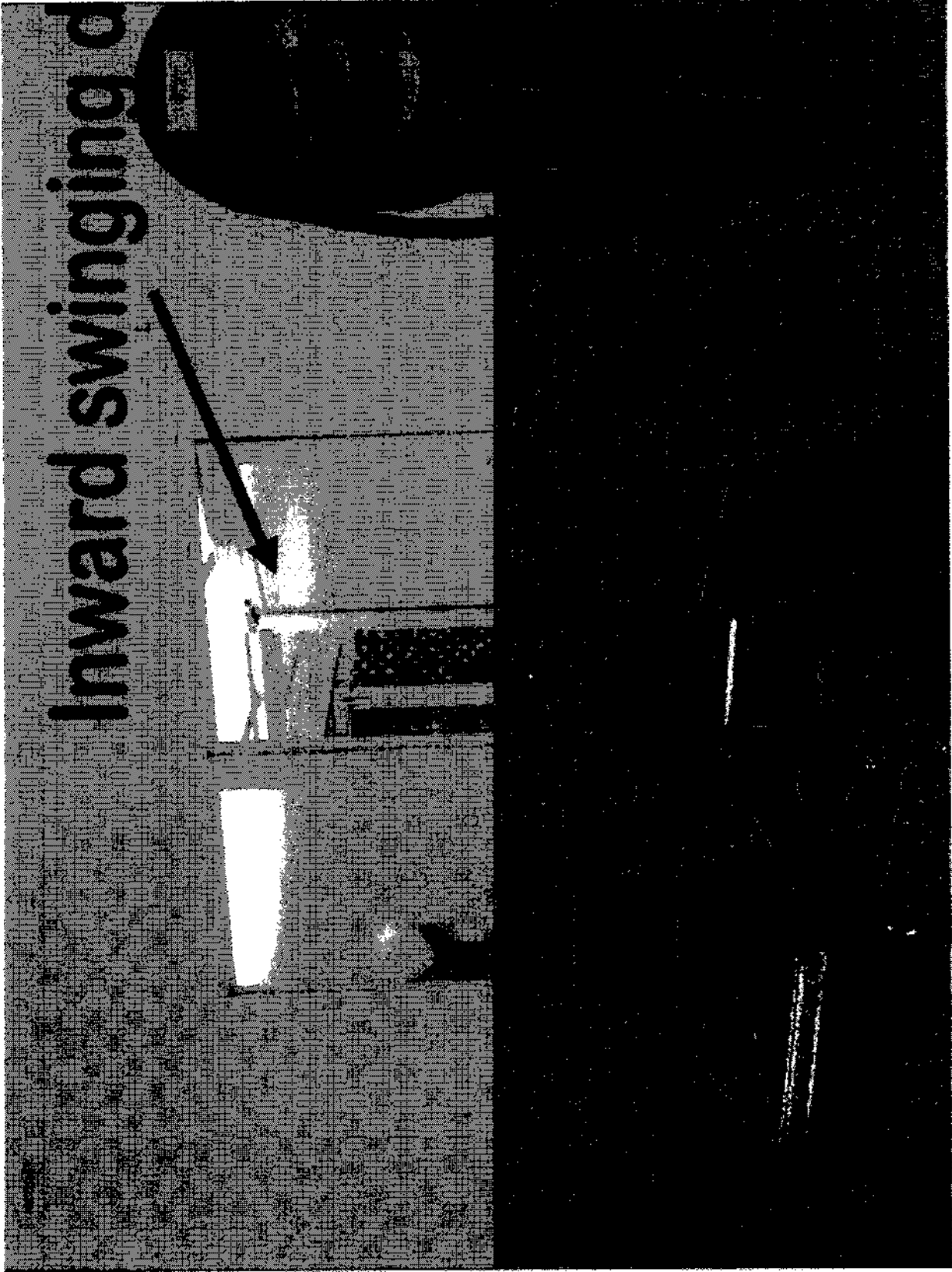

153a Colwill Road



Waitakere City Council
Te Taiaro o Waitakere

WAITAKERE CITY COUNCIL

23 MAY 2006

CHEQUE FOR
\$ 250.00
TO OWNERS attached

EXEMPTION APPLICATION FORM FOR SPA & SWIMMING POOLS

665536

The Operational Compliance Manager
Waitakere City Council
Private Bag 93109
Henderson

WAITAKERE CITY

OFFICE USE ONLY

SITE ADDRESS:

Rec: CS4308

SWP NO: 98 000120 SWM

SPA 2002 0046

ABA NO:
(IF APPLICABLE)

✓ P. 24
✓ P. 50 24/5

OWNERS NAME:

Mr/Mrs/Miss/Ms Sue Hogg

Hereby make application for an exemption from the standard fencing controls relating to pools.

I propose to make or have already made the following arrangements for the security of my pool:

Letter of compliance attached - Nothing has changed since the
My doors that lead out to the pool have been adjusted
as suggested by Dean Nucalli & we now have 2 lock on
each door - which are impossible for a visiting 10yr old to op.
Reasons why proposal should be granted: (See reverse): The second catch is at the very top.
Letter attached

ADDRESS FOR

CORRESPONDENCE: 4 Rata Rd. Whenuapai

APPLICATION FEE: \$250.00 (one off)

Signature: Sue Hogg

Telephone No: 416 9876

Date: 11-5-2006

Note the explanation and requirements on the reverse of this form.

Chief Executive
Corporate Services
City Services Moselle
Consultancy Services
ECO - WATER
Strategic Group
Consent Services

A 29



Waitakere City Council
Civic Centre
6 Waipareira Ave
Waitakere City

Telephone
09 836 6000
Facsimile
09 836 8001

DX CX 10250 Auckland Mail Centre
Email: info@waitakere.govt.nz
Website: www.waitakere.govt.nz

Private Bag 93109
Henderson
Waitakere City

Refer: Dean Nurall: Field Services : Ref: AA
Extension No. 8670 : 131 Lincoln Road

11 March 2002

PETER LESLIE HOGG
4 RATA RD
WHENUAPAI
WAITAKERE CITY 1008

Dear Sir/Madam

FENCING OF SWIMMING POOLS ACT 1987
STREET ADDRESS: 4 RATA RD, WHENUAPAI, WAITAKERE CITY 1008
LOT 1 DP 148225
OUR REFERENCE: SWP98000120

In connection with the above property we advise that the Swimming pool fencing complies with the minimum standard set out in the Act.

Waitakere City Council is to be notified for compliance, should any works be carried out on your pool, prior to your next inspection.

Council will review the pool fencing within three (3) years to check compliance.

Yours faithfully

P.P.

Dean Nurall
Operational Compliance Manager
FIELD SERVICES

SWP5

A 30

Dispensation For Fencing of Swimming Pool

My name is Sue Hogg, I live at 4 Rata Rd, Whenuapai. I recently received a letter from WCC to advise me that my swimming pool fencing did not meet with WCC regulations..I was advised that my pool area is a danger to any child that may wonder into my property – Well I gather that is what WCC is saying, because any visiting child (and there are many,many, including my own 3 grand-children, who visit frequently!) are always supervised in the pool area, and it is impossible for a child to enter this area without an adult.. To get to my pool, a child would have to enter through a boundary gate, then either go through a pool gate around the pool (which is WCC approved), or make their way (obviously by breaking-in! and we have a monitored alarm) through my home..

If we fenced the pool directly around the pool, it would in my opinion, make it SO much more dangerous, for the 'so-called' child, as if they got into this enclosed space, they would only have the pool to be attracted to, and no doubt fall in and drown..If they wondered into the area at the moment, they would have more room and may-be, be found before they could get into the pool – I would presume that they could get into the proposed enclosed pool fencing, because WCC are indicating they are going to get in the existing fenced area, and both fences would be of the same construction...

I believe that I would be putting my own grand-children in danger by putting a fence directly around the perimeter of my pool, as if I was sitting outside of the fenced are (which I would have to do!), if any mishap happened in the pool, the locked gate would make it more difficult in getting to them.

Also on my property, I have 3 water features, all under 400mm deep, which is of WCC compliance.I believe these ponds are more enticing to a child, as they have gold fish swimming in them, and in turn, more dangerous. Littlies tend to lean over to have a closer look and this can lead to falling in.This has happened twice in one of our ponds – luckily the children were supervised at the time and rescued quickly – but the reasoning from WCC is that all 3 ponds are totally legal. But, in my eyes more dangerous.. - *Revised!*

I myself have lost a child aged 9 to leukemia, and in no uncertain terms would ever want another parent to go through the pain of losing a little one, so I do not think that I am being irresponsible in my actions of wanting a dispensation for my already fenced pool.

I do believe that by making the "The Fencing of Swimming Pools Act" so stringent, once again is taking away the responsibility of care-givers. "All action, no Responsibility" attitude, is becoming prevalent in our society, as many care-givers will become complacent in thinking that a pool is fenced, SO it must be Safe, but it is NOT....

I am applying for a dispensation for my swimming pool fence, as I already have a "letter of compliance" sent to me 3 years ago..I believe I have sufficient fencing around my pool - as I have already mentioned there is no way a child can gain access to my pool without adult help..

I am hoping that WCC and my-self can come to an agreement that would suit both parties and keep our children safe..

I look forward to your reply..

Sue Hogg

Existing Fence

**Indicative Position
of Required Fence**

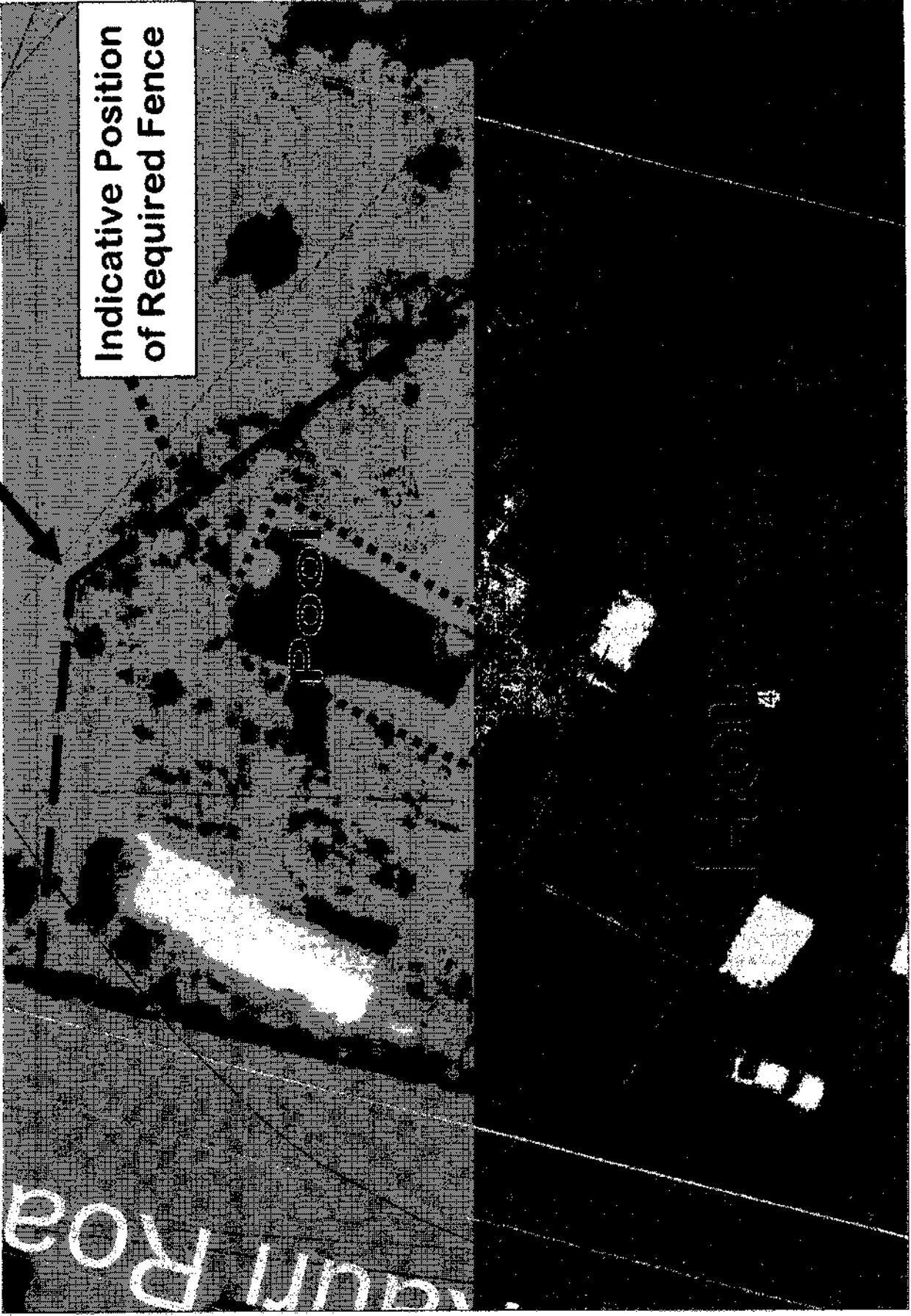

4 Rata Road

A 33

Exemption Application Form for Spa & Swimming Pools



Send to: Chief Executive
Waitakere City Council
Private Bag 93109
Henderson
WAITAKERE CITY 1231

For more information:
Civic Centre, Waipareira Avenue,
Henderson
Telephone (09) 839 6400
Facsimile (09) 836 8001

SWP 20060332

Owners Name: JENNY HENDERSON
Address of pool: 20 OCKLESTONE LANDING, Hobsonville

Hereby make application for an exemption from the standard fencing controls relating to pools. I propose to make or have already made the following arrangements for the security of my pool:

- Full perimeter fence to the pool area.
Trifold ~~trifold~~ doors to living room & office open up to pool area. Doors can not be forced off.
Doors swing out into courtyard.
Bifold window 900 from floor level opens out a area.

Reasons why proposal should be granted: (See reverse) ~~These doors + windows form main ventilation~~
~~REQUIREMENTS FOR THE FENCING RULES~~

Handles are 1500mm high from ground level.
Doors open out and can not be changed due to the construction of the house.

BIFOLD WINDOWS ARE USED AS A SCREEN/TO THE GROUND AND RESTRICT THE OPENING WOULD HINDER THE INDOOR/OUTDOOR FLOW

Address for Correspondence: 20 Ockleston Landing, Hobsonville

Application fee: \$250 (one off)

Signature: J. Henderson

Telephone Number: 4165722

Date: 9.11.05

Note the explanation and requirements on the reverse of this form.

Office Use Only
Site Address: _____
SWP No: _____
ABA No: _____ (if applicable)

77 Te Korawa Cres
Henderson

11.5.06

Dear Mr Day,

Further to our phone conversation I am writing to you to request a refund of the \$250 fee paid for exemption process for our swimming pool situated at the above address

We have been granted exemption as all required measures have been taken, i.e locks fitted etc.

Thank you for your help in a friendly service. If you have any questions please call me on 8354669

Regards

(Name)

Pauline Garner.

A37