

ARC congratulates Waitakere for sorting out its landfills

29 August 2003

The ARC congratulates Waitakere City Council for meeting all of its responsibilities for its old closed landfills.

Waitakere City Council has met required standards for all of the closed landfill sites in the city that it owns after a major commitment over the last 18 months to complete what has been a 9-year process of investigation and reporting.

"We congratulate the Waitakere City Council for being proactive in sorting these sites out," said ARC's Waitakere representative, Councillor Paul Walbran. "They're setting a good example for other landowners."

The ARC has been working with Waitakere City Council as it worked towards ARC requirements. Under the Resource Management Act, the ARC is responsible for making sure that impacts on the environment are minimised from waste disposal activities. The proposed Air, Land and Water Plan being developed by the ARC includes specific rules to govern closed landfill management for the first time.

"As we learn more about the effects from these old landfills, and as the region grows and we need to make efficient use of every bit of land, the rules have got tighter," said Cr Paul Walbran. There are about 142 old landfills in Waitakere City including clean fills. 64 sites are owned by Waitakere City Council now. Sites that are actively managed by the Waitakere City Council include Ceramco Park, Archibald Park and Corban Reserve. Most sites are very small and some may have been closed for up to 50 years.

Old closed landfills are dotted around the whole country. Every local council or landowner with old sites on their property is having to deal with current-day environmental effects caused by these historical activities. Old landfills can pose an environmental risk because they discharge landfill gases and because they leak. The leachate can contaminate groundwater and nearby streams.

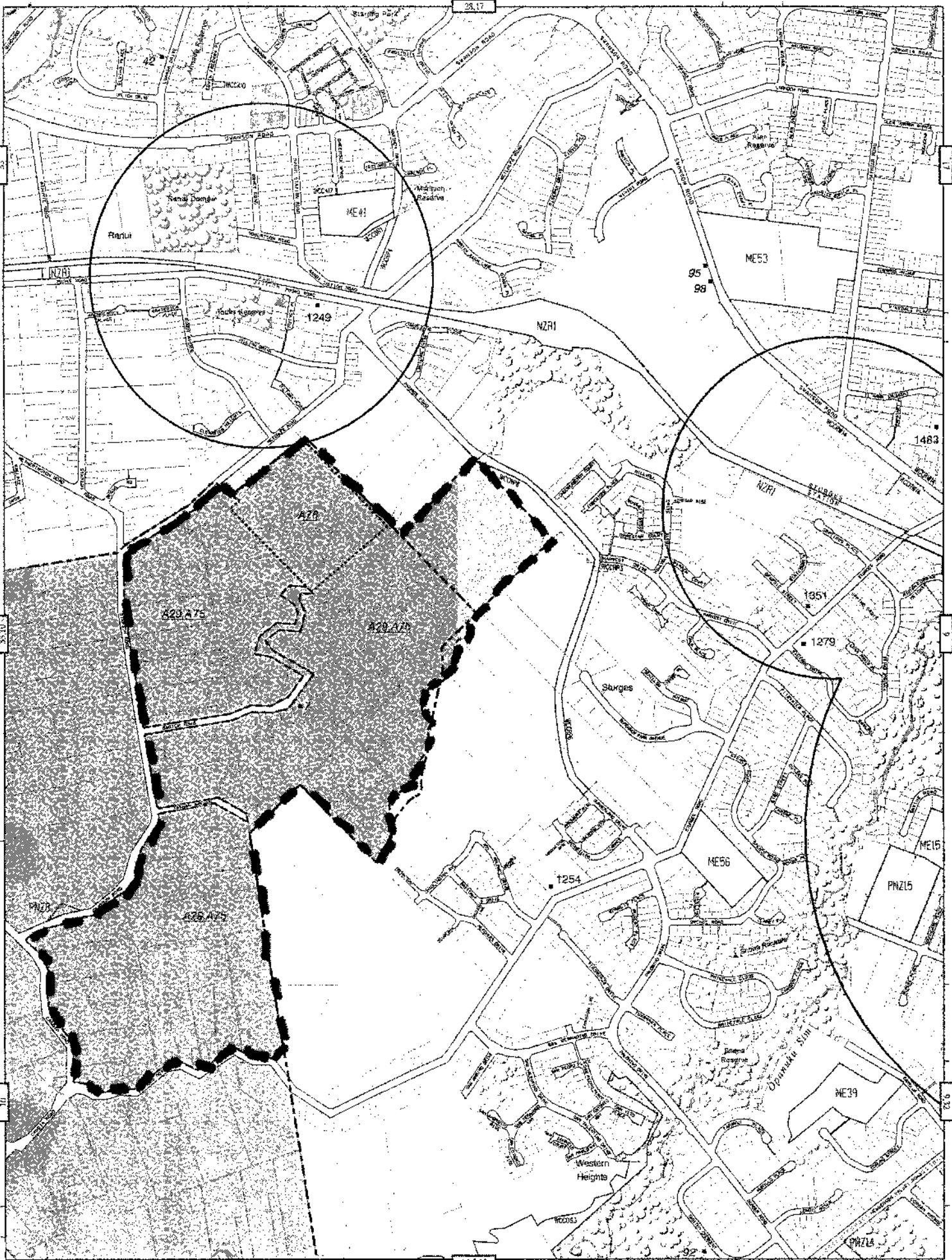

Proposed October 1995
 This version December 1998

Sturges 31

Proposed District Plan - Human Environments

Incorporating Decisions on Submissions and Annotated with References

SCALE 1:10000

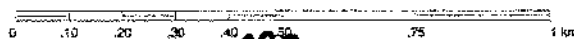





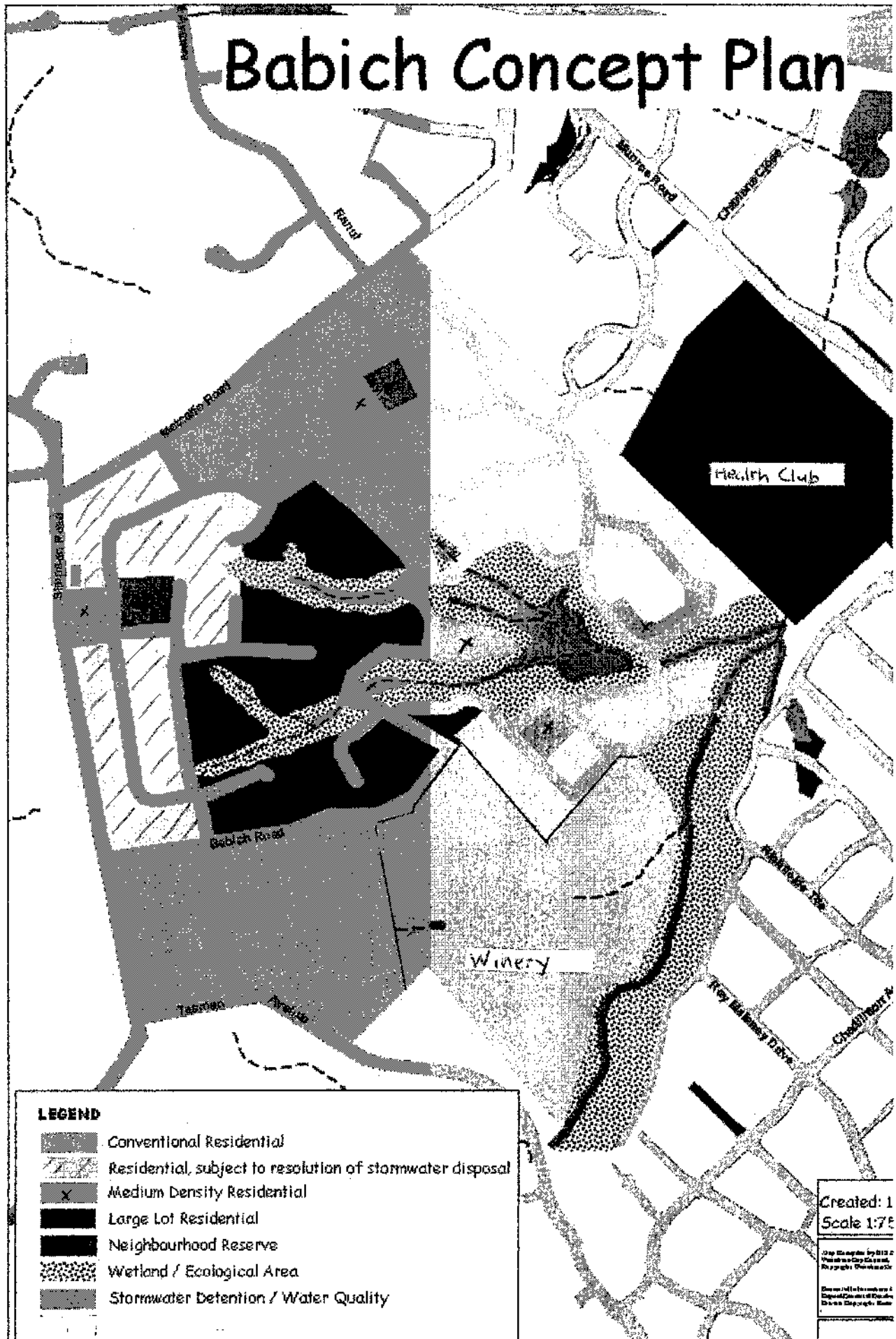

A93

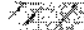
Babich Concept Plan



LEGEND

-  Conventional Residential
-  Residential, subject to resolution of stormwater disposal
-  Medium Density Residential
-  Large Lot Residential
-  Neighbourhood Reserve
-  Wetland / Ecological Area
-  Stormwater Detention / Water Quality

Created: 1/7/03
Scale: 1:750

Site Name: Babich
Project: Babich
Client: Babich
Date: 1/7/03

A94

MAF Bio security – Pam Project
Report on the Ministry of Agriculture and Forestry's Painted Apple Moth
Project
For Waitakere City Council
September-October 2003

1. September saw that last of the scheduled Winter Aerial Target Operations. The first of the scheduled two large 6500 hectare Aerial operations for the Spring/Summer campaign was completed over a two day period.
2. Trap Catch results for September and October to date on the male moths was 0.
3. There has been no ground surveying for Painted Apple Moth for the months of September and October.
4. There were no movement control issues for September and October. The next round of compliance audits are due to begin the second week of November.
5. The release of the Sterile Male moths is still continuing. There are still currently 2000 moths being released in the three locations.

Aerial Operation for the current Winter Programme

Spray No:	Date Scheduled	Date Applied	Date Completed	Total Area Covered (hectares)
Spray 21	11 June	12 June	12 June	892
Spray 22	2 July	3 July	3 July	892
Spray 23	29 July	4 August	4 August	929
Spray 24	26 August	26 August	26 August	929
Spray 25	16 September	30 September	30 September	929
Spray 26	21 October	21 October	22 October	6500