

West Harbour Drive

West Harbour Drive

Local Purpose Reserve 91

91 Moire Road

A

131

96

115A

A1

90

91

45

1.00 pm The meeting adjourned.

1.40 pm The meeting reconvened. Crs Clow and Dallow were not present.

**11 LEASE AND RECLASSIFICATION OF PART OF MOIRE PARK**

1294/2006

MOVED by Cr Cooper, seconded Cr Chan:

1. That the Lease and Reclassification of Part of Moire Park report be received.
2. That the City Development Committee approves the public notification of the intention to reclassify under section 24 of the Reserves Act 1977 part Lot 241 Deposited Plan 83562 as a local purpose (community buildings) reserve in order to grant a lease of the extended area of the crèche to the Leataata O Le Lumanasa'i Trust.
3. That it be recommended to Council that the Chief Executive Officer be given authority in the absence of any objections to the reclassification to apply to the Minister of Conservation under section 24 of the Reserves Act 1977 for the reclassification of Lot 241 Deposited Plan 83562 as a local purpose (community buildings) reserve as specified in section 23 of that Act for the purposes of granting a lease to the Leataata O Le Lumanasa'i Trust.
4. That the Chief Executive Officer be given authority to negotiate and conclude a lease with the Leataata O Le Lumanasa'i Trust for the extended area of the crèche on Moire Park (part Lot 241 Deposited Plan 83562) under section 61(2A)(a) of the Reserves Act 1977 and the lease be executed as negotiated.

**CARRIED**

FACSIMILE TRANSMISSION

TO: The Chief Executive Officer, Waitakere City Council

FROM: Anne Grace 0981

DATE: 04/09/2006

RE: Submission on proposed Reclassification of Part of Moire Park for a Pre-school Facility

I oppose the proposal to reclassify part of Moire Park from Recreation Reserve to Local Purpose (Community Buildings) Reserve.

I am extremely concerned that the decision on this statutory matter will not comply with Section 39 (1) (c) and Section 82 (1) (e) of the Local Government Act 2002 (in combination), because, according to the Public Notice for this consultation the Council has already approved the proposed extensions to the Moire Park Samoan Language Preschool building, i.e., there is extremely high probability that the decision on the reclassification has already been made and a fair hearing of submissions has been pre-empted.

These Sections state:

**39. Governance Principles**

*A local authority must act in accordance with the following principles in relation to its governance: ...*

*(c) a local authority should ensure that the governance structures and processes are effective, open and transparent.*

**82. Principles of Consultation**

*(1) Consultation that a local authority undertakes in relation to any decision or other matter must be undertaken...in accordance with the following principles:*

*(e) that the views presented to the local authority should be received by the local authority with an open mind and should be given by the local authority, in making a decision, due consideration."*

To avoid doubt, please note that I would oppose the proposed reclassification of this land for use by any local community group, irrespective of their purpose. The predominant ethnicity of the applicant organization is irrelevant to the decision that the Council is required to make.

A3

**The grounds for opposition to the proposed reclassification are:**

1. The proposal involves a much larger area than is necessary to accommodate the extension of the existing building and includes a large area of **significant vegetation and fauna habitat** (PNA survey of Tamaki Ecological District - Waitakere City Lowlands) which, along with the rest of the adjoining West Harbour Esplanade Reserve and Manutewhau Walk would best be classified as Scenic Reserve;
2. Because the proposal involves a large area of parkland (comparative to the actual area needed for the building extension) and "significant" resources, it is more than a minor change. Consequently, the Council should notify an amendment to the Moire Park Reserve Management Plan, pursuant to the Reserves Act 1977. It would be appropriate to notify all parties who made submissions on the management plan about the proposal so that they can assess it.
3. The proposal is contrary to the provisions of the Waitakere City Council's Parks Strategy and the Leisure Strategy;
4. The proposal provides for an exclusive localized and specialised use of a City-wide Park, such use of the park curtailing rather than enhancing the potential benefit to residents and ratepayers of Waitakere City at large. The Council's primary obligation is to serve ratepayers of the City generally, rather than smaller sectors of the community (tangata whenua excepted);
5. A large number of other community buildings and facilities could be accommodated within the area if it was reclassified, and many of these facilities could be introduced as permitted activities under the District Plan;
6. The approach being taken is an ad hoc one and invites the continued piecemeal nibbling away at City-wide parks by various organizations, including those operating as businesses, looking for cheap or free land. If the proposal is implemented, it would endorse a reasonable expectation for pre-schools specializing in other foreign languages to have their facilities on our parks;
7. There is private land adjoining the site of the existing Local Purpose Reserve. This offers an alternative for expansion of the pre-school's activities, without compromising more of the park. For example, the existing building could be extended to the north, rather than to the south as proposed.

I wish to be heard in support of this submission.

Yours faithfully



Anne Grace

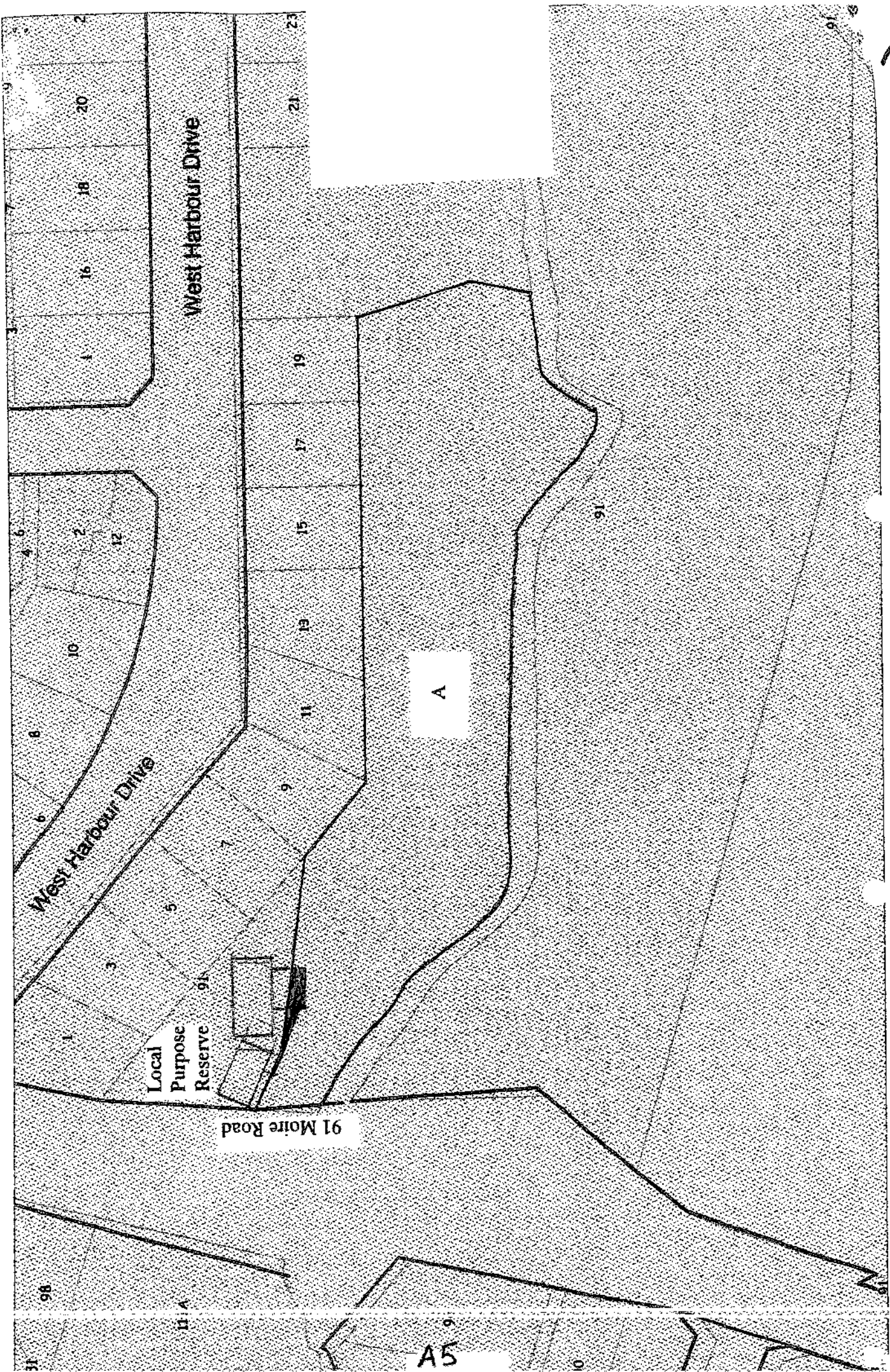

West Harbour Drive

West Harbour Drive

91 Moire Road

Local Purpose Reserve

A

A5

98

11 A

91

21

19

17

15

13

11

9

7

5

3

18

16

14

12

10

8

6

4

2

1

1

1

1

1

1

1

91

96

31

0

9

0

## **New Zealand Diversity Action Programme Ten Steps to Strengthen Our Cultural Diversity**

### **1. Develop a Network**

There are many people and organisations that share a vision and a concern for harmonious relationships in a diverse and inclusive New Zealand. To increase their effectiveness, share their experience and provide mutual support, they need to be connected, informed and recognised. A combined network of people and organisations will help to achieve this.

### **2. Establish a Forum**

The Internet provides a cost-effective means to give people access to an ongoing forum for the exchange of ideas and to a rich source of information. An electronic forum, information pages and a web-portal to new and existing sites about New Zealand's diverse communities will be an important resource to support public awareness.

### **3. Create a Centre**

There is an ongoing need for research, education, information resources and advocacy on cultural diversity. While there are many researchers spread through our educational and research institutions, there is no recognised national centre for the study and promotion of cultural diversity. A New Zealand diversity centre or institute that is able to lead research, inform debate, and connect people in different institutions and organisations would make a major contribution.

### **4. Conduct a Conversation**

Public debate on race relations, the Treaty of Waitangi, measures to achieve equality, our national identity, hate speech and the fragility of our human rights in the absence of a written constitution have led to the call for a process to address these issues. A structured public conversation about our constitutional, legislative and institutional framework to protect human rights including diversity is required, whether it is through a commission of inquiry, parliamentary select committee enquiries or other means.

### **5. Focus on Education and Youth**

Our children are our future. Schools have a vital role to play in educating our youth on diversity and tolerance, through the formal curriculum, school activities, and programmes to combat bullying, harassment and racism. A review and reform of the school curriculum to ensure that civics, values, languages, histories and cultures are part of the core curriculum and that there are high quality resources to support it is an investment in our future.

### **6. Foster diversity in the media**

Much of what we learn about others is from the media. By the competitive nature of television, radio and print media the focus is often on the spectacular or the sensational, and there is a risk that the media will feed stereotyping and prejudice. Our media need to reflect and promote the diversity of our society, both through greater diversity in the mainstream media and through the strengthening of Maori, Pacific and other ethnic media to give voice to all New Zealanders. Journalist recruitment and training should support this purpose, and good practice should be recognised.

### **7. Support the successful settlement of refugees and migrants**

Arrival in New Zealand is not the end of the migration process, it is the beginning. The first phase of a national refugee and migrant settlement strategy has recently been announced, and this needs to be followed by settlement plans for every local area. Settlement plans developed by local authorities in conjunction with iwi, migrant,

community and business groups, as well as health, education, police and other government service providers, will provide the basis for successful settlement of migrants including acceptance by the local community.

### **8. Celebrate diversity**

The celebration of our diversity enables us to reach out to one another, to appreciate each other, and to value our diverse cultures and communities. There are many such celebrations already – Waitangi Day, Pasifika, Race Relations Day, Matariki, St Patrick's Day, the Chinese New Year, Diwali, and other religious, cultural and national days. Cultural diversity through the arts is another important form of celebration. Increased central and local government support for communities, artists and performers will strengthen our diversity and enrich our society.

### **9. Connect with our heritage**

New Zealand is rich in natural and cultural heritage, and connecting with our heritage through conservation and enjoyment is an important component of developing our national identity and sense of belonging. Supporting the involvement of ethnic communities in historic, cultural and natural conservation provides an opportunity to put down roots, contribute to our environment, and to connect to the heritage of all New Zealanders. We need to tell our diverse stories about our land and our history in New Zealand.

### **10. Promote dialogue**

Information and education alone is not enough. People need to meet face to face, experience diversity and discuss issues with people who differ. Communities need to reach out to each other. Dialogue and exchange between people of different views, cultures and faiths is the glue that will hold us together and enrich us all.

(Source: [www.hrc.co.nz](http://www.hrc.co.nz))



Waiakare City Council  
City Services

6 Henderson Valley Road  
Henderson

Job Name

# Piha Domain - Priority 1 & 2 Landscape Development Concept Plan

Scale 1:1000 @ A2  
Date 28/08/2006

1. Proposed Campsite  
Development  
- Pohutukawa Trees

2. Proposed Road  
Development  
- Gravel Road

3. Proposed Entrance  
Development  
- Signage  
- Carpark & Planted Bunds  
- Rain Garden  
- Bollards  
- Rubbish Area

### KEY

- Existing Wetland Planting
- Existing Mixed Shrubs & Trees
- Existing Specimen Trees
- Existing Asphalt Road
- Existing Tennis Courts & Bowling Greens
- Existing Grass Field
- Existing Grass Camp & Caravan Sites
- Proposed Wooden Bollards
- Proposed Rain Garden & Planted Bunds
- Proposed Piha Domain/Campground Signage
- Proposed Way Finder Signage
- Proposed One Way Vehicle Signage
- Proposed Pohutukawa Planting
- Proposed Gravel Road
- Proposed Paving around Water Taps

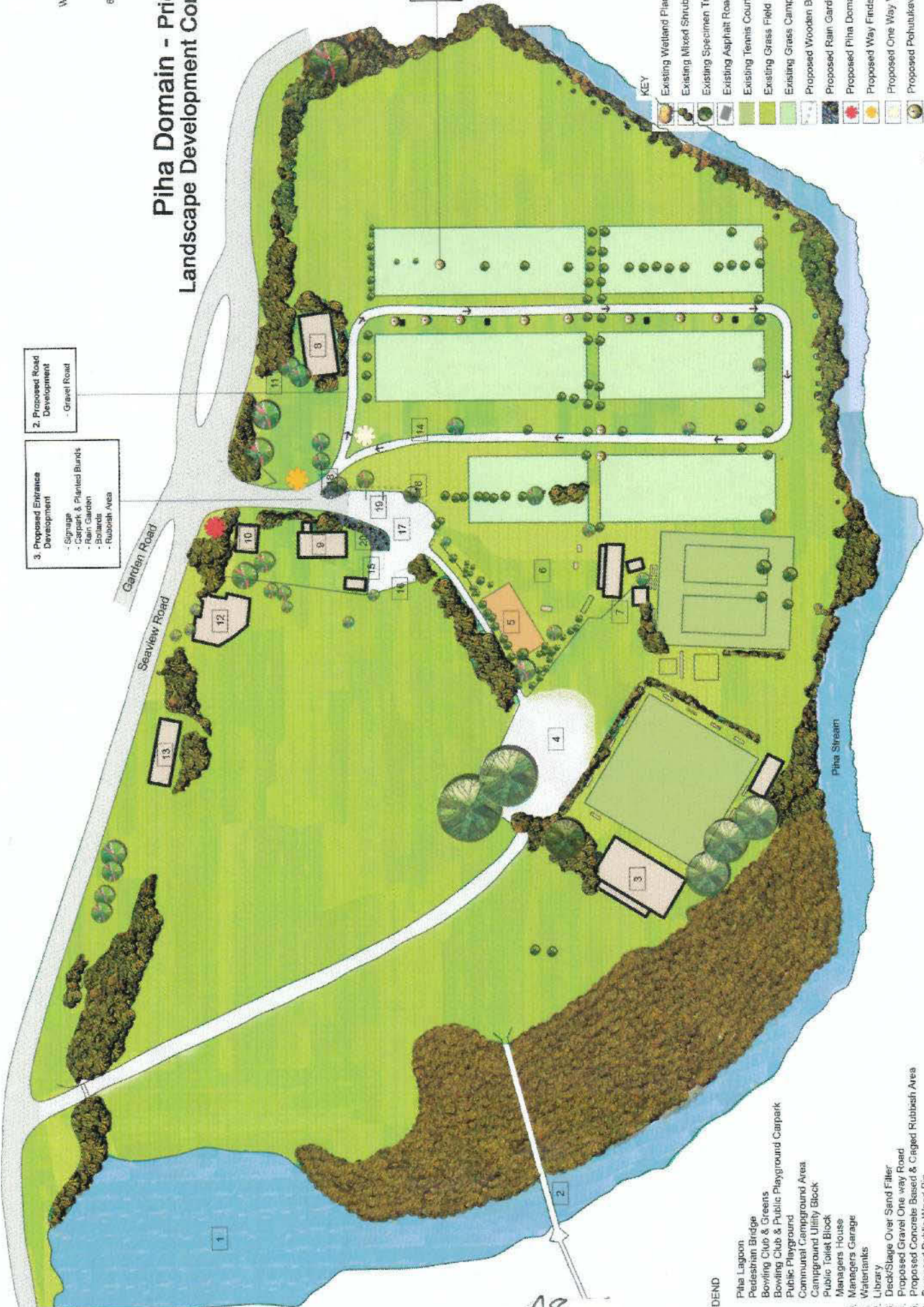

### LELEND

1. Piha Lagoon
2. Pedestrian Bridge
3. Bowling Club & Greens
4. Bowling Club & Public Playground Carpark
5. Public Playground
6. Communal Campground Area
7. Campground Utility Block
8. Managers House
9. Managers Garage
10. Water tanks
11. Library
12. Deck/Stage Over Sand Filter
13. Proposed Gravel One way Road
14. Proposed Concrete Based & Caged Rubbish Area
15. Proposed Public Weed Bin
16. Proposed Gravel Turning Bay
17. Proposed Planted Bunds
18. Proposed Visitor Carpark
19. Proposed Rain Garden
20. Proposed Paving around Water Taps

A8



Wairakere City Council  
City Services

6 Henderson Valley Road  
Henderson

Job Name

## Piha Domain Landscape Development Concept Plan



Proposed Weed Bin, Turning Bay & Rain Garden