



# community facilities

Council facilities encourage recreational activity and an appreciation of the District's history and culture. Council currently provides:

- One public library in Turangi
- Two public toilets in Turangi
- Low cost pensioner houses (8)
- Turangi gymnasium
- Turtle Pools
- Two community halls

In 2003/04 it cost an average \$136 per ratepayer to maintain the community facility network and fund the loans for capital projects.

## Library Development

Council currently spends \$45,000 per annum (approximately \$1.07 per property) in the IT ward managing library lending resources.

In the following table please indicate the Level of Service you want. Please also indicate the amount you would be prepared to pay for the service.

Level of Service	Amount you would be prepared to pay for the service
One public library in Turangi	
Two public libraries in Turangi	
Low cost pensioner houses (8)	
Turangi gymnasium	
Turtle Pools	
Two community halls	

## Library Development

Council is planning to design and upgrade the Turangi Library. Should the library location also be reviewed? In the following table please indicate your preference.

Library location	Level of Service	Amount you would be prepared to pay for the service
One public library in Turangi		
Two public libraries in Turangi		

## Public Toilets

Council intends to spend on average \$50,000 over the next three years (approximately \$1.19 per property) upgrading public toilets in the IT ward to maintain the current Level of Service. In the following table please indicate the Level of Service you want.

Please also indicate the amount you would be prepared to pay for the service.

Level of Service	Amount you would be prepared to pay for the service
One public toilet in Turangi	
Two public toilets in Turangi	

## Turtle Pools

Council intends to maintain the Turtle Pools without any major investment. In the following table please indicate the Level of Service you want.

Please also indicate the amount you would be prepared to pay for the service.

Level of Service	Amount you would be prepared to pay for the service
One Turtle Pool in Turangi	
Two Turtle Pools in Turangi	



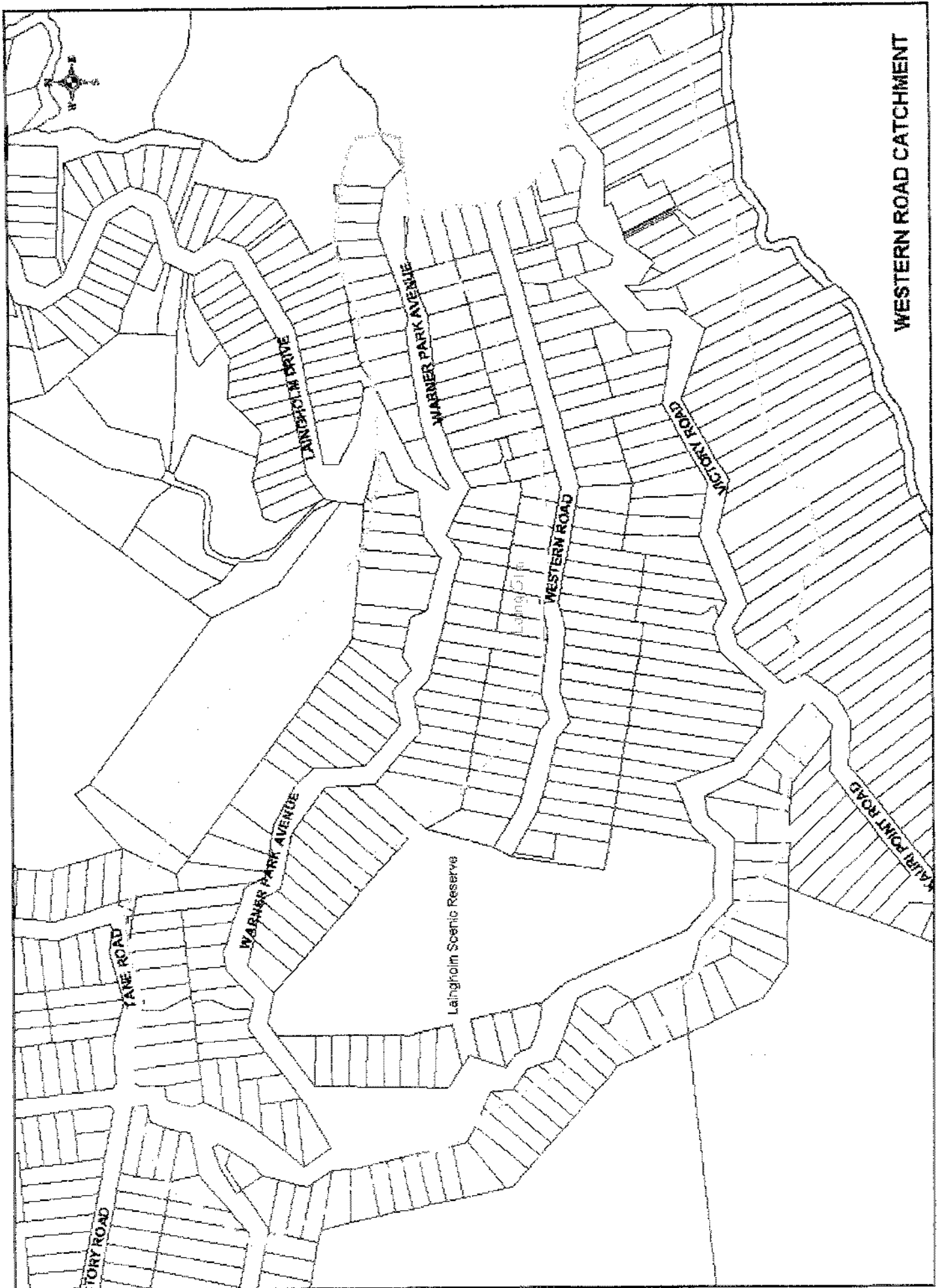

WESTERN ROAD CATCHMENT

A17

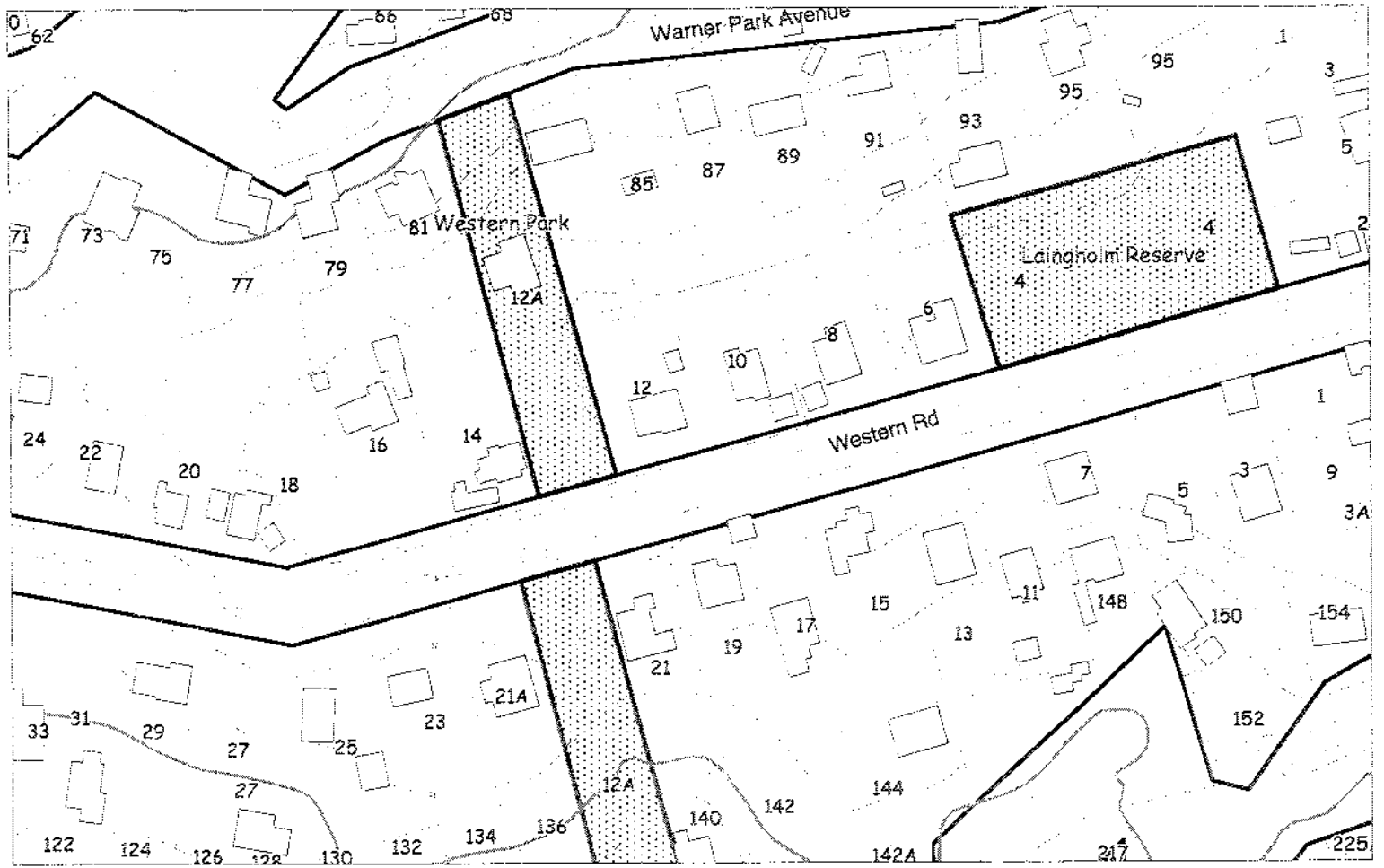

## Laingholm Beach Hall Questionnaire

### Introduction

There are currently two Council owned Community Halls situated on Reserves in Laingholm: the Laingholm Village Hall in Victory Road (opposite the school) and the Laingholm Beach Hall in Western Road. Both are managed by the Laingholm and District Citizens Association (LDCA). Neither hall has high usage. The Village Hall is used regularly by the Laingholm Primary School and by casual users such as yoga groups. The Beach Hall is used casually and occasionally (for example the Laingholm photographic art exhibition was held there last year).

The Council wants to plan for the future of these halls while acknowledging that the Beach Hall requires structural and interior upgrading at an approximate cost of \$34,000. The Beach Hall was built by the community for the Scouts, about twenty years ago. The Scout group later disbanded and in 1999 ownership of the Hall was transferred to the Waitakere City Council.

The LDCA have a number of ideas to increase the future use of the Beach Hall including using it as an artspace and/or for youth activities. Whether these ideas can be put into effect depends on the support of the community. If there is insufficient interest in supporting and retaining this facility, a possible option is to permanently remove it from the site. Therefore, the LDCA and the Council encourage you to give your views before any final decisions are made by completing the following questionnaire and returning it in the self addressed envelope provided or by fax to 836 8070 by **Friday 14 May 2004**.

If you have any questions or ideas for the future use of the Laingholm Beach Hall please contact David Southey, Laingholm and District Citizens Association, (817 6887) or david.southey@xtra.co.nz or Polly O'Brien, Leisure Services, Waitakere City Council, (836 8000 extn 8559) or Polly.O'Brien@waitakere.govt.nz.



1. Which of the following community resources have you used in Laingholm in the last three months (tick the relevant boxes)?

Community Hall (Please name: ..... )  <sub>1</sub>

Parks/open spaces/reserves  <sub>2</sub>

School or other meeting venue/community facility  <sub>3</sub>

2. Are there particular uses or activities that would encourage you to use the Laingholm Beach Hall?

No  <sub>1</sub>

Yes  <sub>2</sub>

If yes please list: \_\_\_\_\_  
\_\_\_\_\_

3. Do you think the Laingholm Beach Hall should be repaired?

No  <sub>1</sub>

Yes  <sub>2</sub>

Why? (Please explain):  
\_\_\_\_\_  
\_\_\_\_\_

4. Do you think the Laingholm Beach Hall should be demolished?

No  <sub>1</sub>

Yes  <sub>2</sub>

Why? (Please explain):  
\_\_\_\_\_  
\_\_\_\_\_

**Additional Comments:**

\_\_\_\_\_  
\_\_\_\_\_  
\_\_\_\_\_  
\_\_\_\_\_  
\_\_\_\_\_

Thank you for completing this questionnaire and being involved in decisions affecting your community

## Feedback on Laingholm Beach Hall Community Consultation

Thank you for the great response to the Laingholm Beach Hall Questionnaire in May. A total of 163 completed questionnaires were returned to the Council. The results were:

- 49% of residents want the hall repaired; and
- 44% of residents prefer that the hall be demolished.

These views were reported back to the Laingholm District and Citizens Association (LDCA) who manage the hall for the community and on behalf of Council. Because the result was not conclusive, the LDCA plans to carry out some further community consultation. The results of this will be communicated to Laingholm residents through the Roundabout later this year.

After this second opportunity for community to comment on the issues, the results and any recommendations will be reported to both the Waitakere Community Board and the Council's Finance and Operational Performance Committee for a decision on the future of the Hall.

We will advise the dates on which the Board and the Committee will discuss this issue, through the Laingholm Roundabout.

Thank you for your valuable contribution so far. If you require any further information please contact:

Polly O'Brien  
Leisure Services  
Waitakere City Council  
Private Bag 93109  
Henderson  
Phone: 836-8000 ext 8559  
Fax: 836-8070  
Email: [Polly.O'Brien@Waitakere.govt.nz](mailto:Polly.O'Brien@Waitakere.govt.nz)



## **Laingholm Beach Hall Update**

**- One last chance to have your say -**

Residents have one more chance to have their say on the future use of the Laingholm Beach Hall, at the Laingholm District and Citizens Association (LDC) Annual General Meeting on Tuesday, 19 July 2005, at 7pm.

The AGM will be in the Laingholm Village Hall in Victory Road. You will then have a fortnight, until Friday, 5 August 2005, to send Polly O'Brien any further comments or views.

Reports will then be submitted to the September meetings of the Waitakere Community Board (Tuesday, 6 September at 7pm) and the Council's Finance and Operational Performance Committee (Monday 12 September, 9.30 am) for a decision on the future of the Beach Hall. Both meetings are in the Council Chambers.

The reports will note that as a result of recent consultation, the LDCA has identified at least five groups who would use the Beach Hall if it was in usable condition. These include a movie club, a canoe and kayak club, a youth club, a German speaking play-group, and a yoga instructor.

These groups fit well with the types of activities local residents identified that they would be interested in through the Council survey on the future of the Beach Hall last year.

The LDCA have also had positive feedback from private hirers who would like to use the Beach Hall during the day - for example local schools using the hall for staff development and planning days. The proposed uses would complement rather than compete with, the Village Hall which is currently well used during the day and 3-4 evenings per week.

Polly O'Brien, Leisure Services  
Waitakere City Council  
Private Bag 93109, Henderson  
Phone: 836-8000 ext 8559  
Fax: 836-8070  
Email: [Polly.O'Brien@Waitakere.govt.nz](mailto:Polly.O'Brien@Waitakere.govt.nz)



## **Laingholm and District Citizen's Association**

### **Report on support for retaining the Western Road Hall, Laingholm, May 2005**

The LDCA has identified at least 5 groups that would regularly use the Western Road Hall if was in usable condition. These groups would be:

1. A movie club.
2. A canoe and kayak club.
3. A youth club.
4. A German-speaking play-group
5. A yoga instructor.

#### **Movie Club**

LDCA member Kathy Paton is organising this club. The club would hire movies to put on for club members. Kathy's outline of the proposed club is attached. Although Kathy has suggested that 15 members per showing might be the capacity of the hall I would suggest that up to 25-30 people could be accommodated in the seating Kathy has in mind.

#### **Canoe and Kayak Club**

3 organisers have contacted the LDCA, including one scout leader (in a private capacity). These are people who use kayaks regularly and are keen to use the Western Road Hall for storing kayaks, for cleaning after kayaking and for socializing.

#### **Youth Club**

Four people have been identified who are interested in helping to organise a youth club in the Western Road Hall. Two of these people are experienced in running community events for children or youth. Potentially there would be 20-50 young people who could be involved in a youth club.

#### **German Play Group**

The german-speaking playgroup, comprised of Laingholm and Titirangi residents at moment goes uses a building in Green Bay. Their group of 8-10 parents, 8 pre-school children plus their older siblings meets in the afternoon after school.

#### **Yoga Instructor**

Runs small classes in Laingholm up to 8 people.

In addition we have had a school hire the hall for a staff development day and enquiries about use of the hall for private functions. LDCA member Heather has shown 5 potential users the hall, including an acoustic music club but the obvious run-down state of the hall means that these users are put off immediately.

#### **The Village Hall as an Alternative Venue**

The Laingholm Beach Hall has advantages for the various interested groups that the Laingholm Village Hall lacks.

1. The Laingholm Village Hall now has regular use during the day and 3-4 evenings a week. The Laingholm Primary School uses the hall daily which

prevents other users from using the hall. The yoga teacher at present uses the upstairs section of the Village Hall but would prefer the Beach Hall as it would enable her to offer day-time classes and is more suitable for yoga. The school use will continue for considerable time as they need to fund-raise to build their scaled down School Hall.

2. With its present usage the Village Hall could not accommodate the types of clubs that seek to use the Beach Hall. The storage areas in the Village Hall are taken up with chairs and plinths and sports gear. The movie club wants to use sofas and arm chairs which would also suit the needs of the canoe and kayak club, as well as the youth club to some extent.

### **Location**

The Beach Hall is close to the beach, a children's park and the only store in Laingholm. Also it is on a road that has low traffic volume. These features make it far more suitable for 3 of the above users:

- a. The proximity to the beach makes the Beach Hall ideal for the canoe and kayak club. Canoes could be stored and carried to Laingholm Beach, making it available to members without vehicles.
- b. The beach and store area and the park make Western Road a natural gathering point for youth in Laingholm.
- c. The building suits their purposes of the German-speaking playgroup with the play-ground and beach down the road, combined with low traffic volumes means that they could use the Beach Hall for their pre-schoolers while it would be safe for the older children to play at the park and beach.

In addition the Principal of Glendene Intermediate, who recently hired the Beach Hall, pointed out that the quietness of the Hall, and its proximity of the beach and hall made it ideal for her staff development days, because they could enjoy the walk to the beach and get lunch at the store. She thought that if the hall was in good condition other schools would be interested in using it.

Also the WCC needs to be aware that the old "up the hill", "down the hill" geographical division still seems to apply to Laingholm to some extent. Residents down the hill would tend to use the Beach Hall for its sheer convenience.

### **Overlap of Interests**

Aspects of activities the youth club, the canoe and kayak club and the movie, in particular, would overlap. The LDCA has had interest in using the movie equipment for children and youth, while the youth could also be readily involved in kayaking. The location of these three clubs in the beach Hall would facilitate this interaction.

### **Other Issues**

Population demographics-The residential profile of Laingholm is changing rapidly with Laingholm schools attracting families with young children into the area. There is little on offer in Laingholm for children once they leave primary school. Also people move to Laingholm because they want to be away from the rest of Auckland - and dare I say it, the rest of Waitakere City. Given the "stick-to-

Laingholm" value, the changing demographics and increasing fuel prices demand for recreational space in Laingholm will increase over the next few years.

### **General Support**

Of the 50-60 residents that I have spoken to about the project none had taken part in the original project and all supported upgrading the hall and developing its use for the groups listed above. Not one person said that the hall should be pulled down. These residents are primarily from the area surrounding the hall "down the hill".

At the time of the WCC survey no use was outlined for the hall. The LDCA believes that the absence of identified users for the hall led to the closeness of the results for and against.

Face to face interaction is also more likely to generate a positive response and more accurate result than a survey because residents have a chance to raise possible objections and discuss these to get better informed about the hall. Indeed the positive response to the initiatives noted above from members of the community has shifted the LDCA's level of support for keeping the hall. A year ago before the above users were identified LDCA member support roughly reflected the survey results with just of 50% support for keeping the hall. Now LDCA members are 100% in favour of keeping and upgrading the hall.

This leads the LDCA to the conclusion that gaining a widespread community involvement in the hall is a matter of continued promotion and dissemination of information about the users and uses for the hall, as well as a definite WCC commitment to upgrading the hall. In particular, and in addition to the issues recommended in the engineers report, ongoing use of the hall requires that an adequate means of heating the hall is installed. Councillors and LDCA members alike have both experienced how bitterly cold the building can be in winter, so ongoing use of the hall would require the heating issue to be addressed immediately.

There is a growing momentum amongst local people who would support the listed groups in the hall. It would be contrary to WCC's commitment to development of well communities to withdraw - or even delay - support for the hall now, after considerable ground work has gone on. Indeed withdrawal of support would be likely to result in negative publicity for the WCC and organised opposition from Laingholm residents and the LDCA.

# MOVIE CLUB PROPOSAL

## Introduction

Since the idea was mooted to start a movie club, there have been several people keen to support the concept. The support offered so far includes physical assistance and probable patronage. Because of its size, layout and locality the Lower Beach Hall would be an ideal venue for such a club.

## Plan

- The first process would be to contact locals interested in the movie club to establish what sort of movies they would like and how often they would like them; fortnightly/monthly. This would be advertised in the Roundabout.
- Because of the size of the Beach Hall I would envisage a patronage of no more than 15 adults to be comfortable at any one screening.
- It would be appropriate to acquire up to six comfy old couches that could also be used by other groups.
- Acquisition of projection equipment is now proceeding.
- Only movies of appropriate content will be screened.
- A small admission fee would be charged to cover incidental expenses such as movie rental and for food and refreshments.
- A matinee session on a Saturday afternoon for children would be considered when the club was functional.

The expected outcome would be to provide the community with a club unique to the area that interacts on a regular basis for entertainment, socializing and pleasure.

Kathy Paton  
13<sup>th</sup> May 2005