

A24

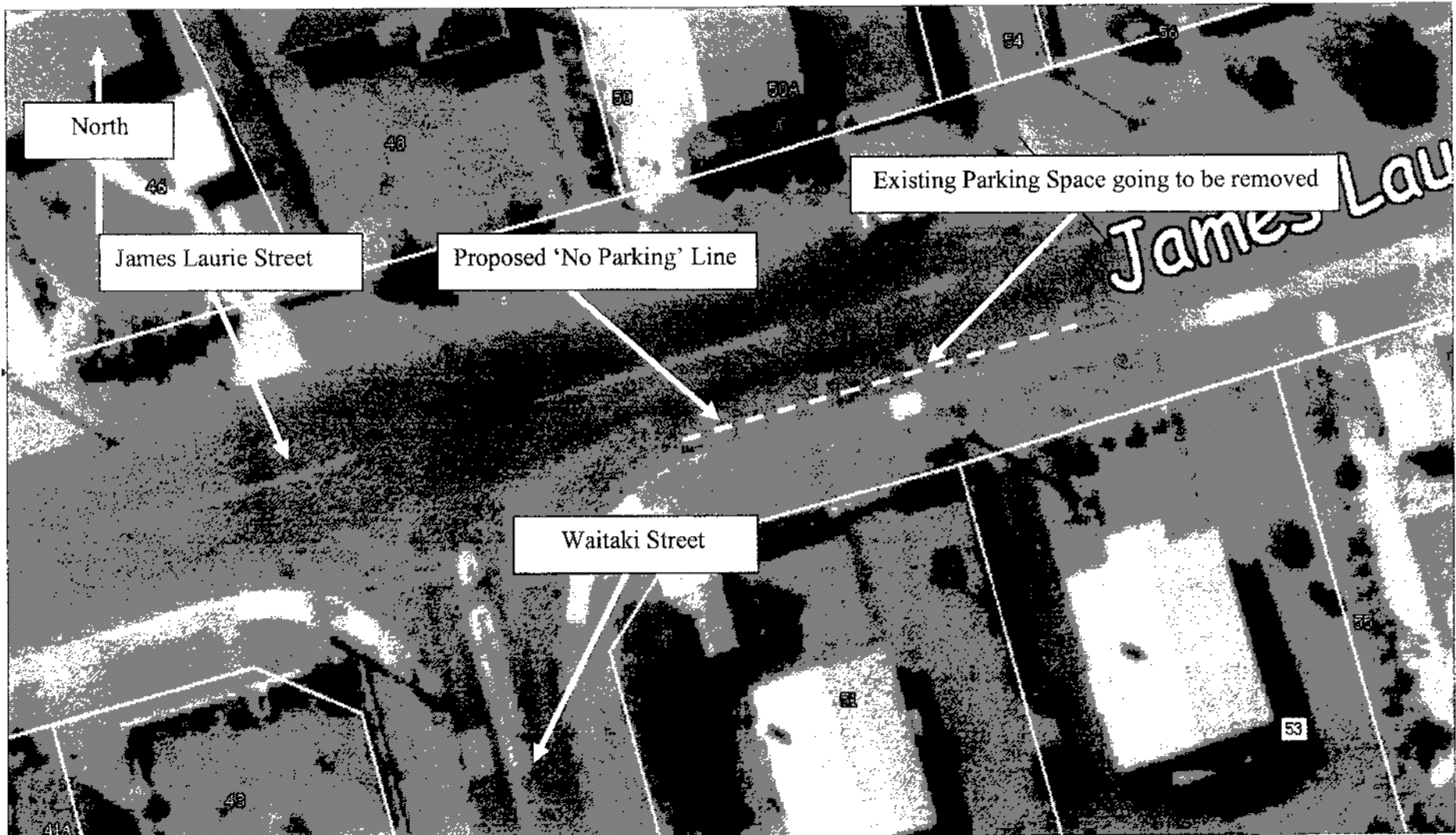

A25



24 August 2003

Waitakere City Council
Private Bag 93109
Henderson
Waitakere City 1250

**Proposal : To allow Overnight Parking for Certified Self Contained
Motor Homes at Tui Glen Reserve**

Organization : NZ Motor Caravan Association Inc Auckland Area

Contact : Barry Donovan, Convenor.

Address : 2 Terra Nova Street Glen Eden

INTRODUCTION

Motor caravan tourism is one of the fastest growing recreational activities within NZ. The NZ Motor Caravan Association Inc. currently represents 12,500 family groups nationwide who own motor homes (over 23,000 adults) and our membership is growing quickly. The last twelve months have broken records with 18% growth, and membership has more than doubled since 1998. It is estimated that we represent 75% of NZ private motor home owners.

HOW WAITAKERE COULD ATTRACT NZMCA MEMBERS

Our records show that the average member spends 70 nights away from home per year, and \$47 a day while travelling in their motorhome on food, fuel, supplies, medicines, vehicle repairs, maintenance, tourist attractions, and entertainments. This means that our members are contributing \$41 million to the economy while travelling.

A NZMCA certificated self contained motorhome has little adverse effects on the environment, and presents no risk to public health. It is

A26

designed to completely meet the ablutionary and sanitary needs of the occupants for a minimum of three days without requiring any external services or discharging any waste.

Most members of the NZ Motor Caravan Association are responsible people wanting to see the country they were unable to travel around during their working lives (75% of our members are over 55 years of age). The Waitakeres and surrounding areas have a lot to offer these people, with facilities and attractions more than equal to other areas. Let's encourage these travellers to stop and explore Waitakere City.

By having overnight parking for certified motorhomes in a designated area, with other motorhome friendly facilities e.g. public dump stations, the Waitakere District will attract more motorhome visitors. Attracting more motorhome members will give Henderson businesses a larger share of that \$41m (and growing) pie.

It is important then that an overnight parking area is made available for those self-contained vehicles that do not require anything other than a safe parking area. The Tui Glen Reserve with its close proximity to the Henderson shopping centre makes it a very suitable location for the establishing such a secure off street area for overnight parking. This would allow motorhome members to take advantage of all that Henderson has to offer in shopping, cultural and sporting activities.

Our request we believe is in accordance with the objectives of the Draft Reserves Management Plan for Henderson Creek including Tui Glen we suggest that members be allowed to stay no more than two nights.

SUMMARY

NZMCA Auckland area request that Waitakere City approves and sets aside a portion of area of the Tui Glen Reserve where certificated self-contained motorhomes can park overnight according to our proposal.

Auckland committee members represented by

Barry Donovan
2 Terra Nova Street
Glen Eden ph 8183019

A27



Waitakere City Council

Office of The Mayor, Bob Harvey

Refer: Mayor Bob Harvey : Executive Suite : Ref: RS
Extension No. 8003 : Civic Centre

renee.lambert@waitakere.govt.nz

7 October 2003

Barry Donovan
2 Terra Nova Street
Glen Eden
WAITAKERE CITY

Dear Barry,

I think this looks like a great idea and I want to cheer it on. However I am sure that the neighbours will say that it took us twenty years to get the last lot of caravans off this area- along with other predictable noises. There is a clear management plan for the new Tui Glen Reserve which envisages more of a pure park. And yet I am very clear that Waitakere City has a great shortage of holiday parks, hotels, motels and other commercial accommodation, and that the need is growing. I will forward your proposal to the Manager of landscape Development Renee Lambert, who will be able to consider your proposal and its implications in detail.

Yours sincerely,

ROBERT A. HARVEY, QSO, JP
MAYOR
WAITAKERE CITY

cc. Renee Lambert, Manager Landscape Development, Waitakere City

*I think we all are very impressed
and it should happen.*

*Good Luck
BB*

Civic Centre, 6 Waipareira Avenue, Henderson
Private Bag 93109, Henderson
Waitakere City
New Zealand

Telephone: Office 0064-0-9 836 8000 Ext 8802
Fax 0064-0-9 836 8088

Email: Bob.Harvey@waitakere.govt.nz



MOTOR CARAVAN TOURISM

National membership of NZMCA is currently 13,981 family groups (a total of 26,066 adults) – and has been growing at over 13% per year for the last few years. In 2002 growth topped 18.5%.

An ever-increasing number of New Zealanders are acting on their attraction to the motorhome lifestyle. In 1990 the NZ Motor Caravan Association's membership numbered just 1,700 nationwide. Our membership has more than doubled since 1998. We have predicted that by 2010, NZMCA membership will exceed over 25,000 family groups.

Our year 2000 survey showed that on average members use their motorhomes for 70 nights per year. 13,981 motor homes x 70 nights = 978,670 motor caravan nights per year where members will be seeking a pleasant location to park their motorhomes.

There are also about 2,500 rental motorhomes that are fully booked and therefore on the roads every day during peak periods. Nationwide private and rentals together make up over 1,704,000 motorhome nights per year and that number is growing, as motorhome tourism becomes more popular.

The average motorhome spends \$47 per day x 1,704,000 motorhome nights = \$80,088,000. Therefore nationwide motorhome tourists contribute over \$80 million a year to the economy, *while they are travelling over and above camp site fees.*

A District will attract more motorhome tourists by having free overnight parking for self contained motorhomes and caravans in some areas, affordable camp site fees in other areas and other motorhome friendly facilities such as *public wastewater disposal sites*. Attracting more motorhome tourists will give the businesses in that district a bigger part of the \$80 million dollars.

Statistics as of 2003 to date

Total NZMCA members (<i>Family groups</i>):	13,981
Auckland area members (<i>Individual list</i>):	3369
Auckland area average expenditure of van per day	\$84
Number of vans attending Auckland area rallies	23 - 78
Total number of Auckland area rallies	14
Average of Auckland area rally local expenditure	\$72
Average of <i>nationwide</i> rally local expenditure	\$47
Sum of expenditure from Auckland area rallies	\$61,288
Sum of total contribution from Auckland area rallies	\$90,524
Top type of rally area	Business

(We collect these statistics from members that attend monthly rallies. These statistics excluded private motor caravan travellers and tourist)

Prepared by Nguyen T.Ly, Resource Management Co-ordinator, 24/09/04 **EXT**

P O Box 72-147, Papakura Phone 09 298 5465 Fax 09 258 5546 E-mail nguyen@nzorca.org.nz Website www.nzorca.org.nz

WE ARE A GREEN LOW IMPACT ORGANISATION

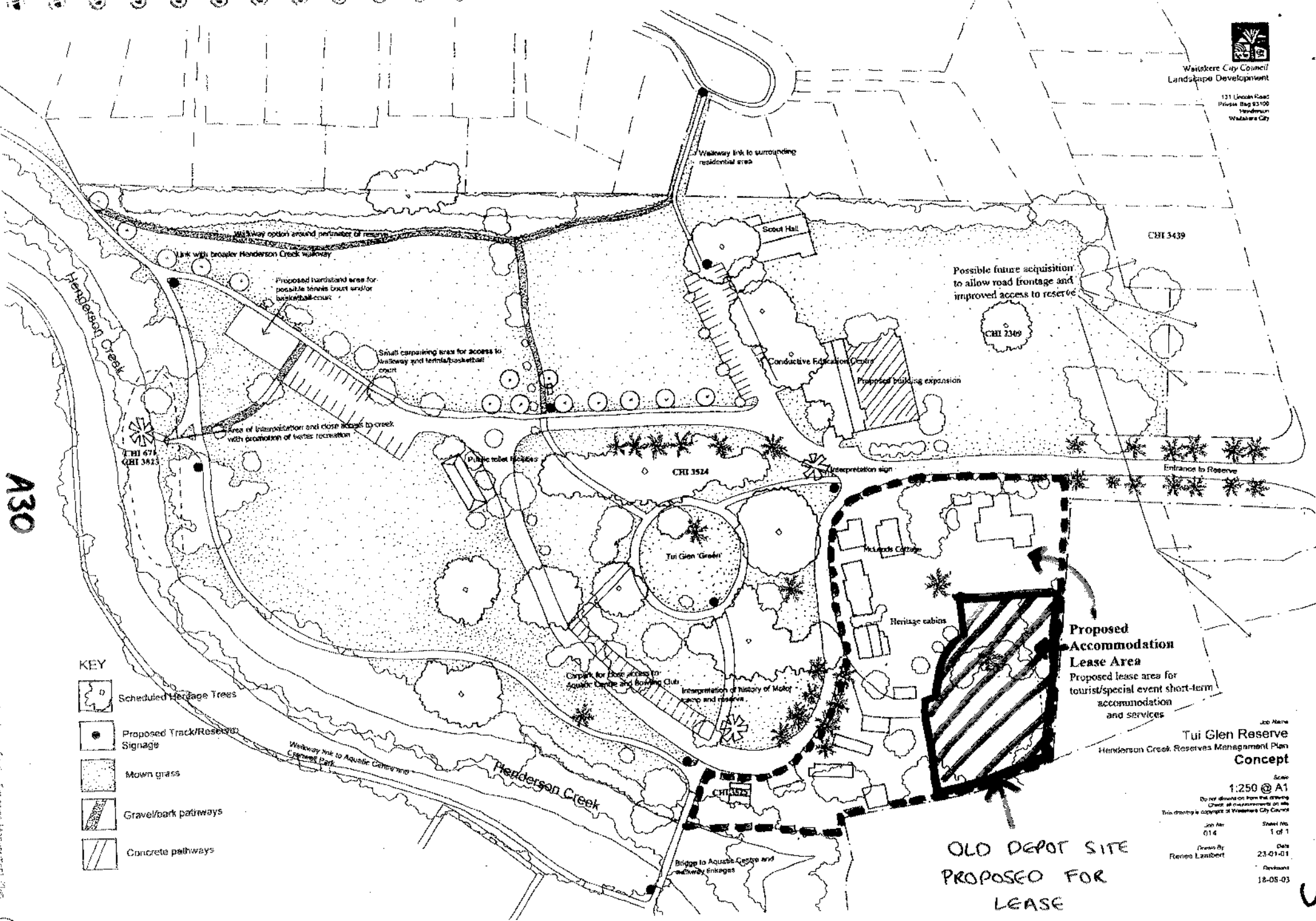

A30

KEY

- Scheduled Heritage Trees
- Proposed Track/Reserve Signage
- Mown grass
- Gravel/park pathways
- Concrete pathways

Proposed Accommodation Lease Area
Proposed lease area for tourist/special event short-term accommodation and services

OLD DEPOT SITE
PROPOSED FOR
LEASE

Tui Glen Reserve
Henderson Creek Reserves Management Plan
Concept

Scale
1:250 @ A1
Do not detail on this drawing
Check all measurements on site
This drawing is copyright of Waikare City Council

Job No. 014	Sheet No. 1 of 1
Drawn By Renée Lambert	Date 23-01-01
Reviewed 18-05-03	



W

4



**The New Zealand Motor Caravan
Association Incorporated**
The Association of Self-Propelled Caravans
Auckland Area Committee



Who and what we are

- Clean Green Eco Friendly Organisation
- Membership 23,000 New Zealand wide
- Compilers of the NZ Standard for Self Containment accepted by the NZS authority with requirements for containment of all fresh water and used waste (grey and black) for three days minimum.
- Members and Assn are committed to these standards so that they can use ARC and DOC sites as privileged visitors.
- We pack in and pack out our own rubbish
- Average age of members is 55 years plus

Proposal

That the NZMCA Auckland request approval to use a designated area in Tui Glen for overnight parking of members motor homes for up to two nights.

Advantages

- Increased trade for local retailers, Aquatic Centre, Restaurants and Local services.
- The average motor home member spends \$329 per week for fuel and food (authority NZMCA rally records 2002)
- The close proximity of Tui Glen to the Henderson Business Centre and Public Transport Services both rail and bus.

A31

Promoting Waitakere City New Zealand wide through our membership bi monthly magazine.

Proposed Site

The envisaged area is already metalled (although weed covered) with sealed access in and out.

The entrance is suitable for controlled of vehicle traffic by combination lock in the existing chain and padlock already in place.

The area is below the line of site to from the main field with the walkway access to many amenities.

The Auckland Area members would provide an annual volunteer working bee to upgrade and maintain the designated area proposed in consultation with the council officers as we do now for the ARC parks and DOC sites.

The area lends itself to some of the bigger motor homes, which have some difficulty finding suitable park-over areas.

A32