



Waitakere City Council
Te Taiao o Waitakere

14 MAR 2005

CHEQUE FOR
\$250.00
TO PAYERS

EXEMPTION APPLICATION FORM FOR SPA & SWIMMING POOLS 627383

The Operational Compliance Manager
Waitakere City Council
Private Bag 93109
Henderson

WAITAKERE CITY

OWNERS NAME:

Mr/Mrs/Miss/Ms Kathleen & Mr Brian
Chandler

OFFICE USE ONLY

SITE ADDRESS:

SWP NO:

ABA NO:
(IF APPLICABLE)

Hereby make application for an exemption from the standard fencing controls relating to pools.
I propose to make or have already made the following arrangements for the security of my pool:

Treadlocks on ranch sliders, restrictions,
fasteners to cement windows

Reasons why proposal should be granted: (See reverse):

Please see attached
information

ADDRESS FOR

CORRESPONDENCE: P.O. Box 70100, Takanua, Auckland

APPLICATION FEE: \$250.00 (one off)

Signature: K. M. Chandler

Telephone No: 918 0625

Date: 11/3/05

Note the explanation and requirements on the reverse of this form.

11

Reasons why proposal should be granted

The pool is fully fenced with 2 gates, both outward opening and self closing with approved locking and release mechanisms. The house doors are fitted with appropriate deadlock mechanisms (all shown below).



Access to the house is via the front door, not via any of the pool gates. These are used to exit the pool area to the main garden and were never designed to gain access to the house. The main parking area is adjacent to the front door on the other side of the house from the pool.

The two gates are never used as a thoroughfare as there is practically no occasion to travel from one side of the fenced area to the other. If the occasion does arise then it is far more convenient to walk around the pool than to open both gates.

Attached is the aerial photo taken by the council with the pool fence and gates drawn in.

* Restrictive fasteners are being fitted to all outward opening casement windows adjacent to pool area.



To summarise, there is no way that access can be gained to the pool area from outside without negotiating the pool gates. There is no access from the house except through sliding doors with deadlocks on them.

Needless to say there are no children living in the house and none of our adult children have families.

Regards

K.M. Chandler

Brian Chandler

Katherine Chandler

B. Chandler

Boundary area - a fence line, rock & fence, this fenced area pool area.

Child's name	
Child's service	
Child's gender	
Child's date of birth	
Child's date of death	
Child's date of arrival	
Child's date of departure	
Child's date of return	
Child's date of departure	

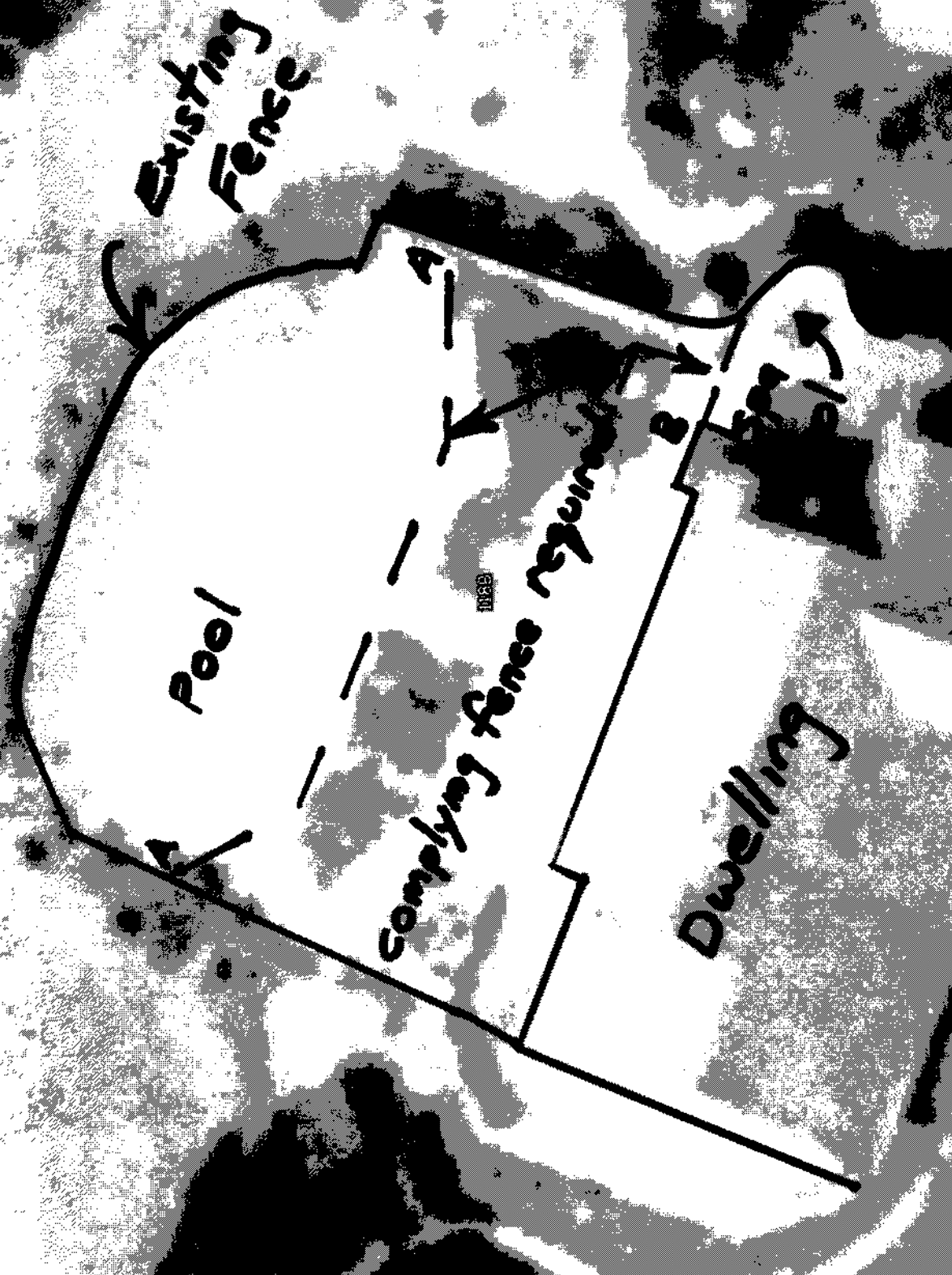

A14



Waitakere City Council
Te Taiaro a Waitakere

627394_{JCIL}

14 MAR 2005

EXEMPTION APPLICATION FORM FOR SPA & SWIMMING POOLS

CHEQUE FOR
\$250.00
TO CASHIERS

The Operational Compliance Manager
Waitakere City Council
Private Bag 93109
Henderson

OFFICE USE ONLY

SITE ADDRESS:

SWP NO:

ABA NO:
(IF APPLICABLE)

WAITAKERE CITY

OWNERS NAME:

Mr/Mrs/Miss/Ms

Gayle Lockas

Hereby make application for an exemption from the standard fencing controls relating to pools.

I propose to make or have already made the following arrangements for the security of my pool:

1. THE MISSING FENCE TO THE EXISTING SWIMMING POOL FENCING HAS BEEN REMOVED

Reasons why proposal should be granted: (See reverse):

1. A FENCE ALREADY EXISTS BEING THE BAMBOO FENCING WHICH I UNDERSTAND COMBINES WITH THE FENCING REGULATIONS. THIS FENCE IS DIFFICULT TO SEE FROM A DISTANCE AND MAY HAVE BEEN MISSED BY THE INSPECTOR.
2. REMOVED POOL - AN INSPECTOR BOSS WAS ASKED TO TAKE POOL ACCESS DOWN AS REQUIRED TO YOUR LATEST DATE) 17 MARCH 2005. THE INSPECTOR WAS ASKED AT THE TIME TO REMOVE THE POOL TO BE REMOVED FROM THE ISLAND. I REQUEST AN EXEMPTION FOR THIS POOL.

ADDRESS FOR

CORRESPONDENCE:

11 Inverloch Place, West Harbour

APPLICATION FEE: \$250.00 (one off)

Signature:

Telephone No:

Date:

Note the explanation and requirements on the reverse of this form.

Chief Executive	
Corporate Services	
City Services	
Municipal	
Consultancy Services	
ECO - WATER	
Strategic Group	
Contract Services	
Engineering	<input checked="" type="checkbox"/>

A15



FENCE WITHIN BAMBOO

A16

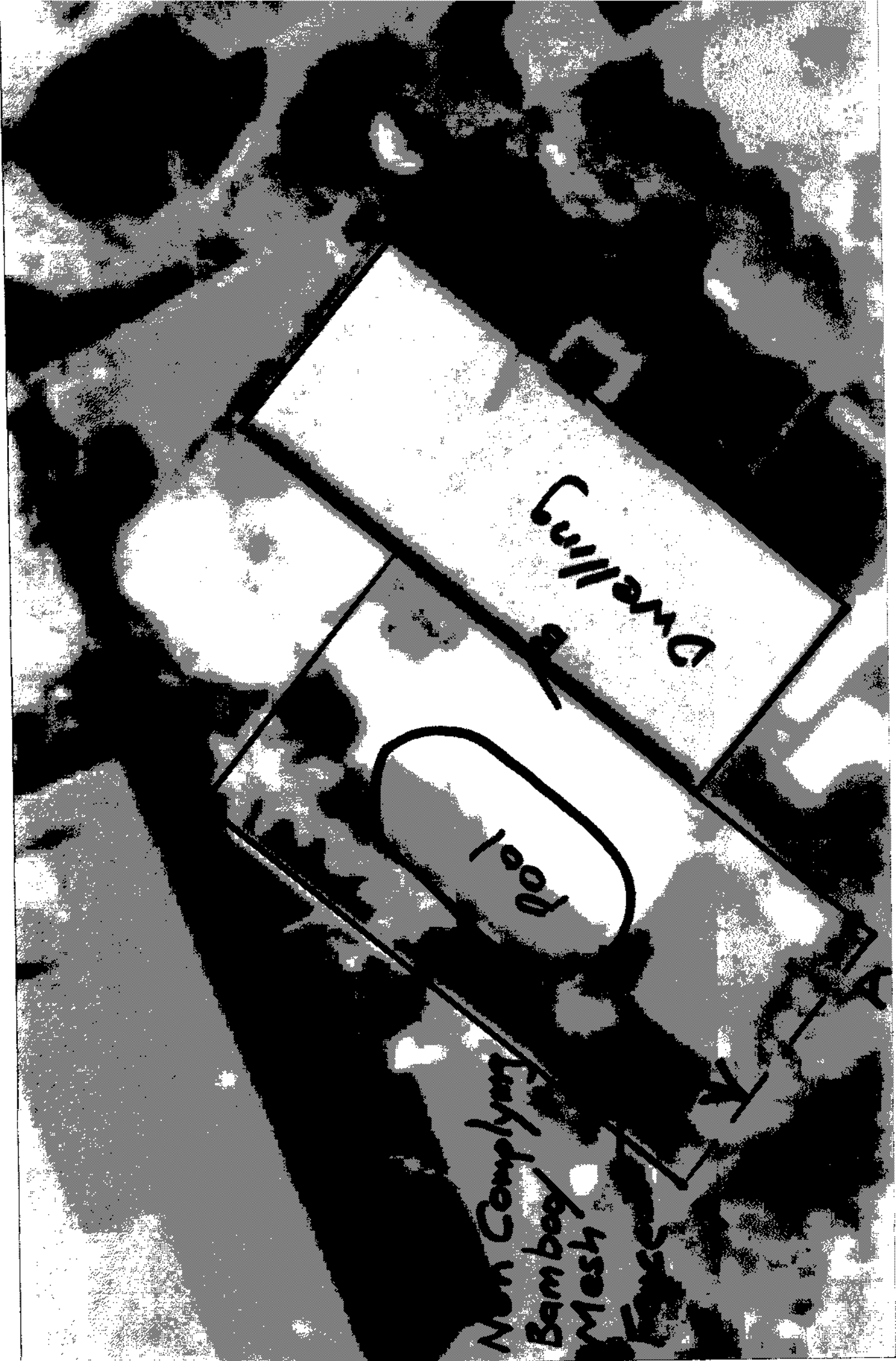

A17