

1 West Elev
Perspective (shadows)

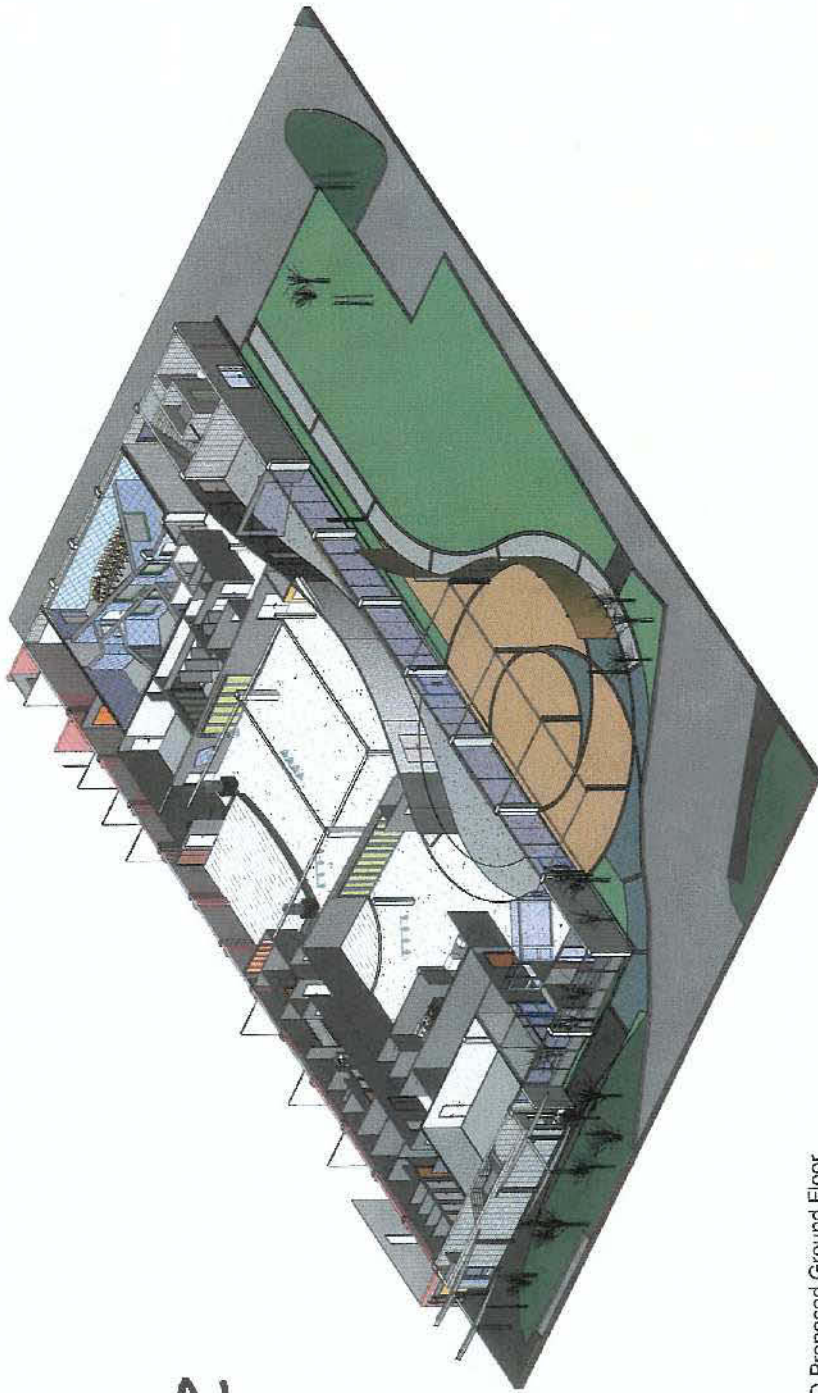

2 NW Perspective - Proposed

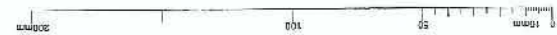

A1

3 3D Proposed Ground Floor
Section Box

Revisions	Approved	Date



Project:	Waitakere City Council Henderson Youth Facility, IM Office and Westwave Rec Centre Upgrade
Submitted:	17/05/07
Project Number:	4.27078
Scale:	1:750
Date:	19/05/07
Drawn:	ibc
Checked:	ibc
Project:	1910 RA

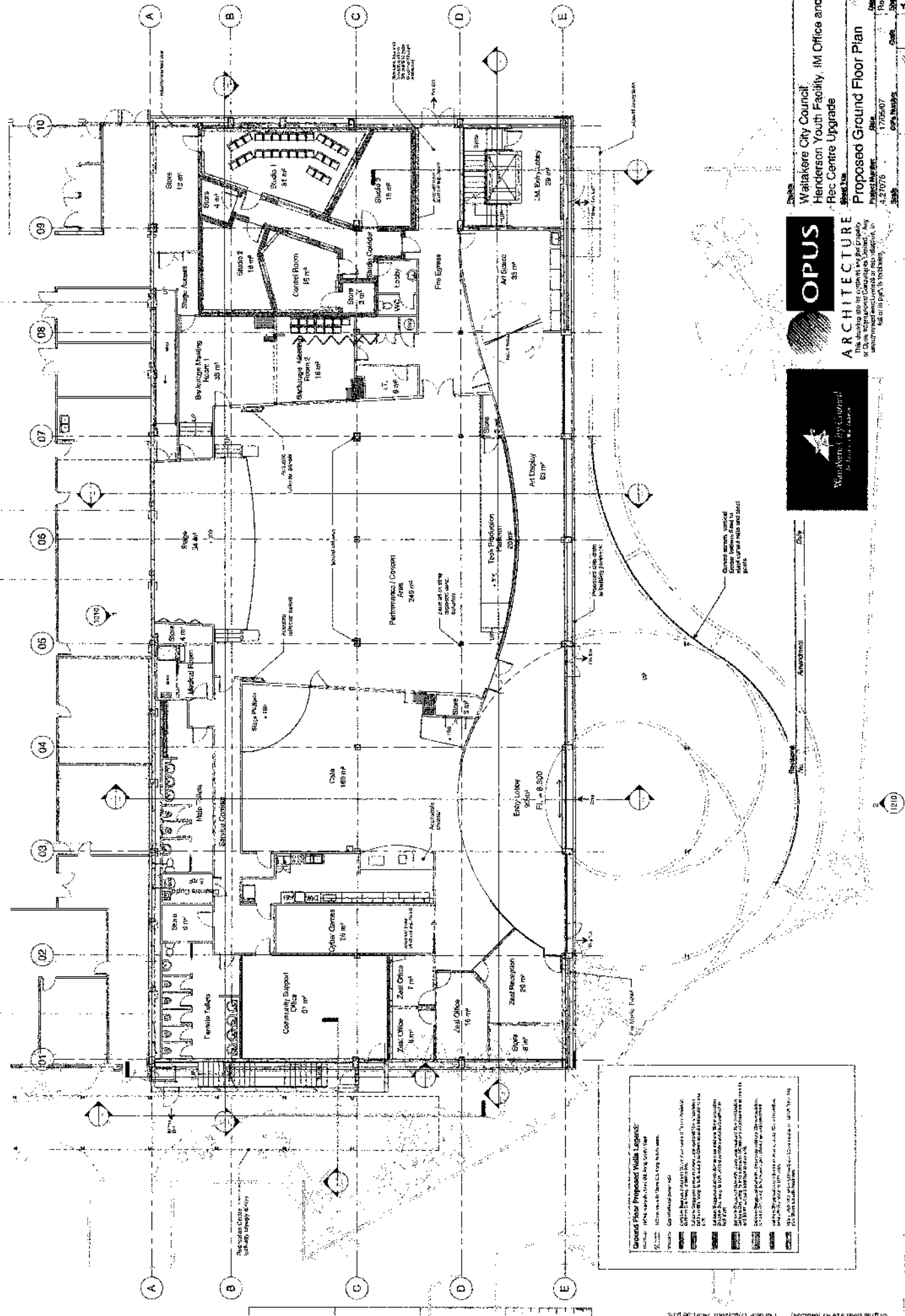

Ground Floor Proposed Walls Legend:

- 1000: 100mm brickwork on concrete base
- 1001: 100mm brickwork on concrete base with render
- 1002: 100mm brickwork on concrete base with render and paint
- 1003: 100mm brickwork on concrete base with render and paint and insulation
- 1004: 100mm brickwork on concrete base with render and paint and insulation and acoustic treatment
- 1005: 100mm brickwork on concrete base with render and paint and insulation and acoustic treatment and fire rating
- 1006: 100mm brickwork on concrete base with render and paint and insulation and acoustic treatment and fire rating and sound insulation
- 1007: 100mm brickwork on concrete base with render and paint and insulation and acoustic treatment and fire rating and sound insulation and acoustic treatment
- 1008: 100mm brickwork on concrete base with render and paint and insulation and acoustic treatment and fire rating and sound insulation and acoustic treatment and acoustic treatment
- 1009: 100mm brickwork on concrete base with render and paint and insulation and acoustic treatment and fire rating and sound insulation and acoustic treatment and acoustic treatment and acoustic treatment
- 1010: 100mm brickwork on concrete base with render and paint and insulation and acoustic treatment and fire rating and sound insulation and acoustic treatment and acoustic treatment and acoustic treatment and acoustic treatment

OPUS ARCHITECTURE
 Waiakareki City Council
 Henderson Youth Facility, IM Office and Westwave
 Rec Centre Upgrade

Scale: 1:100
 Date: 17/05/2017
 Project No: 170507
 Resource Consent No: 1110/RA
 Client: Waiakareki City Council

A2

SCOPE OF WORKS:

Gym Extension:
 New walls to include one single and one double door.
 New walls to be laid on the inside with 13mm Gib board and on outside with 12mm A Grade ply. The Gib to the new fitness centre on the inside is to have 19mm Gib toughness to door head height.
 Install three new windows within new wall.
 Reception area to include new reception desk.
 Three assessment rooms with glass walls and doors.
 Install suspended grid ceiling system to assessment rooms with acoustic tiles.
 Install new Cor-a-perf ceiling with insulation as main open space area.
 Sand and seal the existing timber flooring.
 Install new lighting and power to all areas.
 Power multi board.
 Install AV connections.
 Install TV Cable connection.
 Install air conditioning.
 Install wooden bag storage.

Main Open Area:
 Sand and seal the existing timber flooring.
 Install new ceiling with trussulation.
 Replace all lighting fittings with new.
 Remove existing lighting controls.
 Remove the existing electrical distribution board and upgrade MSB.
 Re-wire existing heat sensors.
 Separate the existing fire alarm system and panel from the proposed Youth Centre.
 Upgrade the existing ventilation and air conditioning.
 Install H3.2 timber framing with Gib lining to the East gable side of the building between the us of the roof and the top of concrete below the mesh.

Rear Changing Rooms:
 Male & Female Change (Members and Non Members)
 Provide new entrance doors.
 Install new non slip commercial grade vinyl flooring to all areas except showers to have Sureshield flooring.
 Install Gib Aqualine ceilings on Rondo grid supports throughout and paint and allow for maintaining the existing rooflights.
 Strip and line existing concrete block walls.
 Install new Gib Aqualine wall linings (paint finish) to all walls except wet areas.
 New 8mm Formica compact laminate wall linings to showers & accessible shower/wc cubicles and 10mm Formica compact laminate to partitions.
 Replace all existing WC cubicle partitions.
 Provide new showers and cubicles with orange seats within the cubicles.
 Replace all existing WCs, WHBs and showers.
 Replace existing Green coloured polycarbonate sheeting with new frosted polycarbonate sheeting.
 Upgrade existing ventilation / air conditioning system.
 Replace existing gas heaters with more efficient, sustainable heating system.

Loading Bay:
 Strip off existing vinyl floor, make good to existing concrete floor and replace with epoxy coated floor finish.
 Provide push button operation with manual override to existing roller shutter door.
 Line existing walls and ceiling with new 13mm Gib and paint.
 Replace water damaged wall lining - also in adjacent storage room.
 Provide additional lighting.
 Remove the existing double pedestrian doors and install new single access dpr at same.

Kitchen / Canteen:
 Remove existing sliding Fire Exit door on rear wall and infill opening with concrete block.
 Strip and line existing concrete block walls with 13mm Gib and repaint all areas.
 Replace existing ceiling with new suspended grid ceiling together with acoustic tiles.
 Replace existing vinyl flooring with new commercial grade vinyl flooring.
 Install new non acoustic operable wall between kitchen and canteen (panels).
 Remove existing kitchen cupboards and replace with new.
 Install new stove, oven, fridge and freezer.
 Install new door to match existing and ramp.
 Upgrade ventilation / air conditioning system.
 Provide new flush mounted ceiling lights.

New Rear Fire Egress Route (East side of building):
 Provide new fire rated wall, reduce existing store size and install an additional double door to the store.
 Replicate and install new staircase to provide mezzanine storage access.
 Install new Fire Exit Egress doors and new personnel door.

After School Program:
 Replace existing ceiling with new suspended grid ceiling together with acoustic tiles.
 Replace existing carpet with new carpet.
 Upgrade existing ventilation / air conditioning system.
 Provide new flush mounted ceiling lights.

Parking Warden Office:
 Replace existing ceiling with new suspended grid ceiling together with acoustic tiles.
 Replace existing carpet with new carpet.
 Upgrade existing ventilation / air conditioning system.
 Provide new flush mounted ceiling lights.

Entrance adjacent to Parking Wardens Office (West side of building):
 Remove existing sliding Fire Exit door and infill opening with concrete block.
 Replace existing ceiling with new suspended grid ceiling.
 Install new Gib lining and framing above existing entrance doors.
 Upgrade existing lighting.

Plunket:
 Replace existing carpets with new carpets.
 Provide new flush mounted ceiling lights.

Arts Council:
 Replace existing carpets with new carpets.
 Upgrade kitchenette to be self contained (to be confirmed by client).
 Upgrade existing store room to office and board up mezzanine area (to be confirmed by client).
 Install new Gib ceiling to store room, and new commercial grade vinyl flooring and paint walls.
 Provide new staircase to access upper storage area.
 Provide new flush mounted lighting.

Office / Reception:
 Replace existing counter with new counter.
 Replace stuck sliding window.

Front Entrance:
 Cut back exterior canopy to exterior of front entrance area.
 Clean up and repaint area.
 Replace existing recessed floor mats.

Male and Female Toilets at Entrance:
 Provide new flush mounted ceiling lights.

Marital Arts Room:
 Extend room into music area.
 Sand and seal existing timber flooring.
 Install new suspended grid ceiling system together with acoustic tiles.
 Install new acoustic panels to wall areas to eliminate noise.
 Provide new flush mounted ceiling lights.

Music Education Centre:
 Remove all internal walls and install new fire rated wall to provide new fire egress route.
 New Fire Egress Route adjacent to Marital Arts Room:
 Sand and seal the existing floor.
 Install new wall with Gib moisture to inside face and Gib Toughline to egress passage side.
 Provide 2 No. new double Fire Exit egress doors.

Painting:
 Full internal and external painting (including the ex. blue coloursteel cladding) except store interiors and offices to North side of RC.

Fire Rated Compartment Wall:
 Provide all necessary work to maintain integrity of fire rated compartment wall line as indicated.

General:
 All new flooring materials to be utilised are to be good quality commercial grade and fit for purpose.

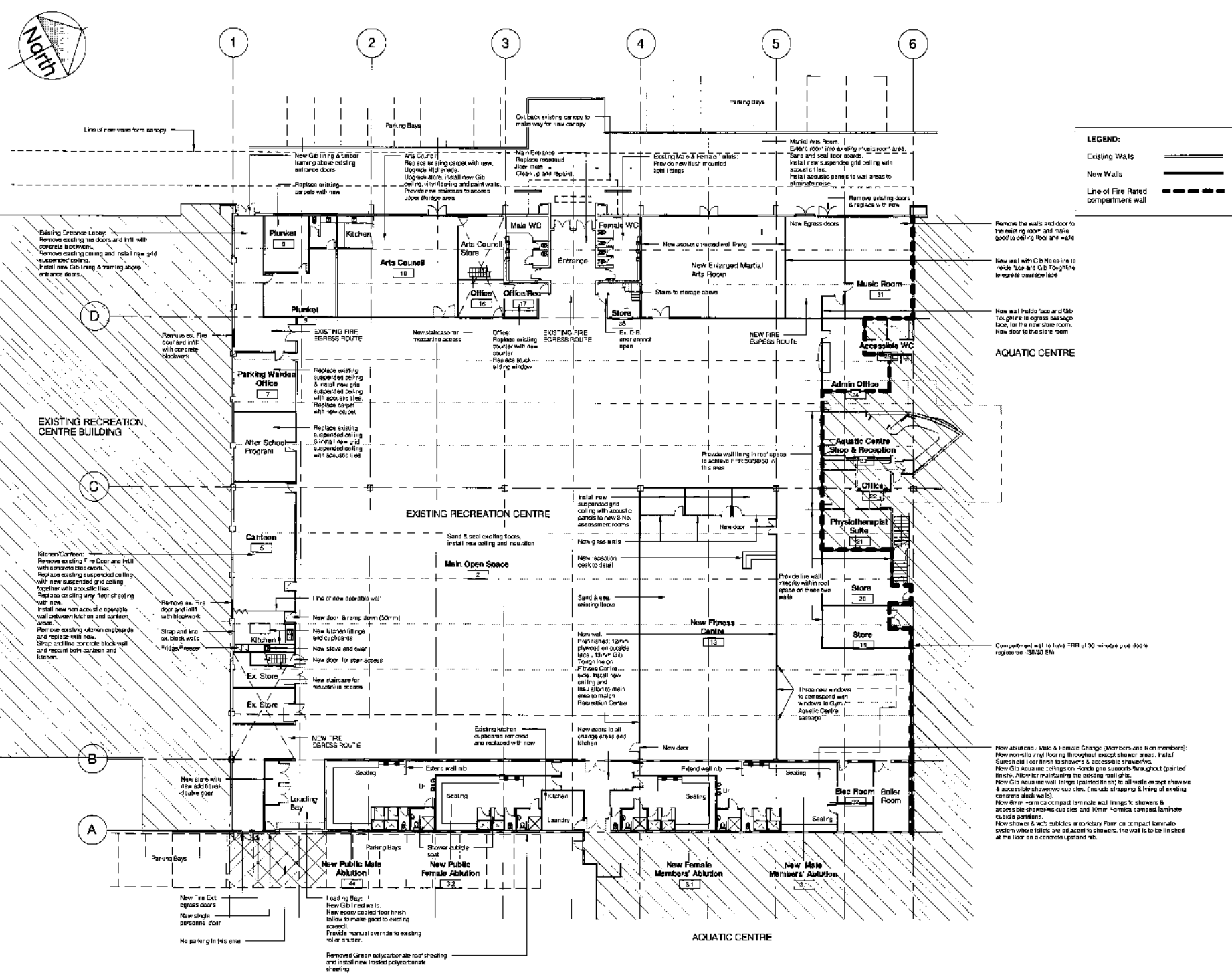

1 Proposed Floor Plan
 1 : 200

No.	Amendment	Date

OPUS ARCHITECTURE
 New Zealand

By: PC Checked: PH Date: 10/10/2014
 Approved: PH Date: 10/10/2014

Project			
WAITAKERE CITY COUNCIL HENDERSON WEST WAVE RECREATION CENTRE UPGRADE			
Sheet Title			
Proposed Plan			
Project Number:	Date:	Drawn Status:	
4-27076.02	Plot Date	DEVELOPED DESIGN	
Drawn Number:	Code:	Sheet No.:	Scale:
		107	As indicated

This drawing and its contents are the property of Opus International Consultants Limited. Any unauthorised employment or reproduction, in full or in part, is forbidden.

Drawn: PC
 Design: PH

A3

Original sheet size A1 (840x594) Plot date: 29/08/2014 2:14:13 p.m.

PERFORMANCE MEASURES

Project/service	Objectives	Measures
<p>Networking with educational institutes</p>	<ul style="list-style-type: none"> To build networks with educational institutions in Waitakere. 	<ol style="list-style-type: none"> Provide evidence on a quarterly basis of contact made with all secondary schools (including special education schools), alternative education courses and tertiary institutes in Waitakere. Provide evidence on a quarterly basis of maintaining a relationship with those providers who signal an interest.
<p>Networking with youth service providers including Maori and Pacific Island Groups.</p>	<ul style="list-style-type: none"> To build networks with local providers of youth services in Waitakere. 	<ol style="list-style-type: none"> Provide evidence on a quarterly basis of contact made with providers in the youth service sector. Provide evidence on a quarterly basis of developing a relationship with those providers who show an interest.
<p>Inclusiveness</p>	<ul style="list-style-type: none"> To ensure that all youth have the opportunity to participate in the Services provided by Zeal under this agreement. 	<ol style="list-style-type: none"> No justified complaints of any youth being excluded from the Services provided by Zeal on discriminatory grounds.
<p>Working with Council in partnership</p>	<ul style="list-style-type: none"> Take all practical steps to attend and provide input at meetings arranged by Council on the design and operation of the Youth Facility to be operated by Zeal. 	<ol style="list-style-type: none"> Demonstrates to Council's satisfaction a willingness to work in collaboration with Council for the benefit of youth within Waitakere City.

AG

SERVICE LEVEL AGREEMENT SCHEDULE 1

Project/service	Objectives	Measures
Partnerships with the Youth Council	<ul style="list-style-type: none"> • Create a partnership with the Youth Council, actively encourage their participation and support in Zeal's projects and ideas and also support the Youth Council to achieve the Youth Council's aims • Encourage and promote youth to use the Youth Council forum to express their views. 	<ol style="list-style-type: none"> 1. Present to the Youth Council when requested with the aim of developing a regular dialogue with them. 2. Hold monthly meetings with the Chair of the Youth Council to discuss youth issues and opportunities for both parties to work together. 3. Provide evidence of at least one collaborative project with the Youth Council.
Leadership	<ul style="list-style-type: none"> • To develop leadership programmes for youth in Waitakere. 	<ol style="list-style-type: none"> 1. Provide evidence on a quarterly basis of an understanding of the leadership programmes that exist within Waitakere City by conducting a stock take identifying the gaps in youth leadership programmes in Waitakere and detailing Zeal's plans to fill those gaps.
Marketing and Promotion	<ul style="list-style-type: none"> • Zeal markets and promotes the Youth Facility in a positive manner at all practical opportunities. 	<ol style="list-style-type: none"> 1. Ensure that youth living in Waitakere have both knowledge and a positive image of the proposed Youth Facility to be measured by survey from those who intend to attend the Facility, as well as the wider youth public in Waitakere.
Financial	<ul style="list-style-type: none"> • To account for the funding received by Zeal under this agreement in a manner acceptable to Council. 	<ol style="list-style-type: none"> 1. Provide an auditable list of expenditure to match the funding received.
Fitout	<ul style="list-style-type: none"> • To provide adequate fit-out in time for the opening of the facility. 	<ol style="list-style-type: none"> 1. Fit-out adequate to run the Youth Facility is installed by May 2008.

AS