

APPENDIX AXX: Hobsonville Town Centre Location Plan

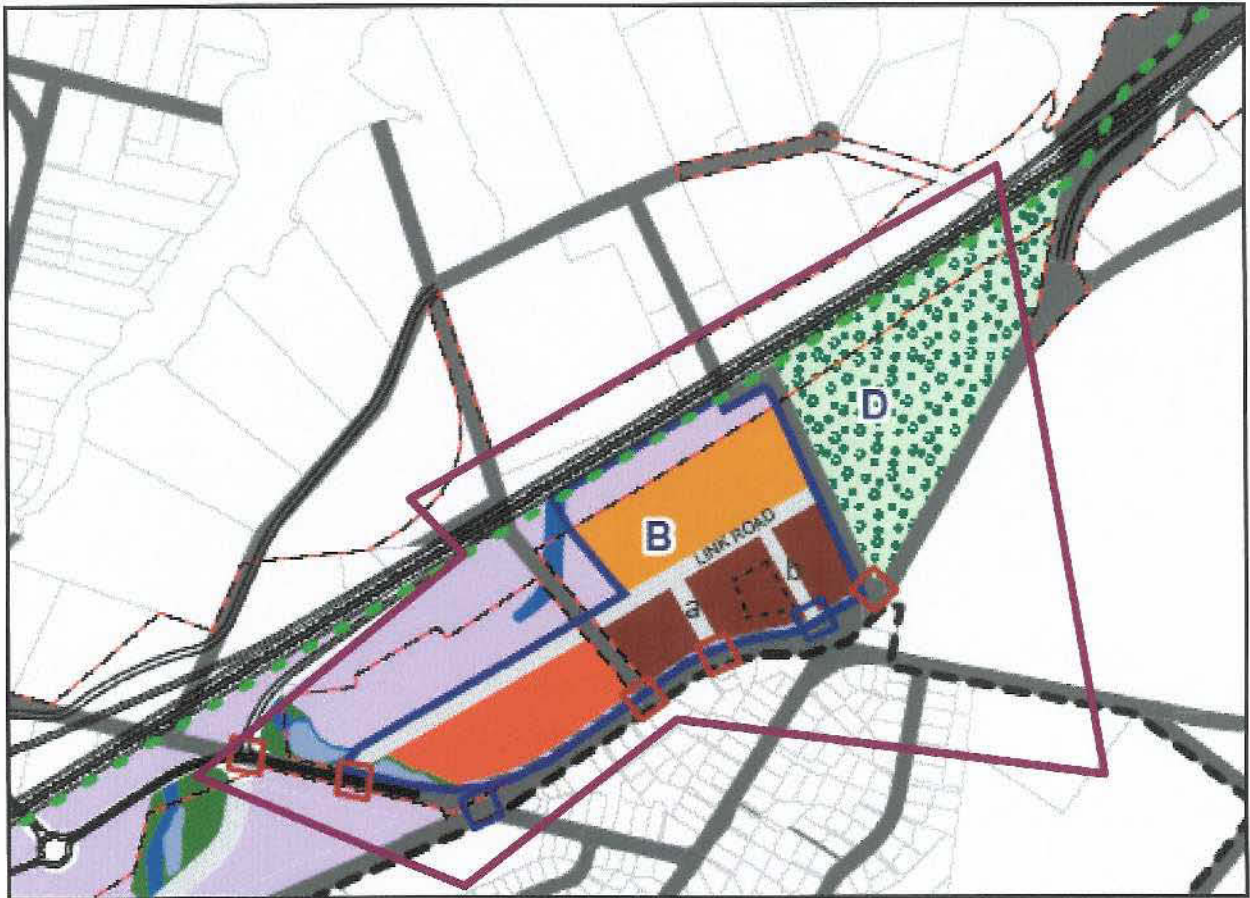

Figure 1.0 Hobsonville Town Centre Location Plan & Master Planning Study Area

ENV Court Number	Appellants To WCC Plan Changes	Section 274 Parties	Appeals - Text					Appeals Maps	
			PC 13	PC 14	PC 15	PC 16	PC 17		PC 18
Env-2007-AKL-000565 PC 13	Auckland Regional Council	Waikare Properties Ltd Hobsonville Land Company Ltd National Trading Company (NZ) Ltd Transit NZ Land Transport NZ Fulton Hogan Ltd Auckland Regional Transport Authority IMF NZ Ltd	✓						13
Env-2007-AKL-000568 PC 14	Auckland Regional Council	National Trading Company (NZ) Ltd Progressive Enterprises Ltd Transit NZ Land Transport NZ Titan Hunter Ltd Auckland Regional Transport Authority IMF NZ Ltd		✓					14
Env-2007-AKL-000566 PC 15	Auckland Regional Council	The Warehouse Ltd Warehouse Stationary Ltd Progressive Enterprises Ltd Westfield (NZ) Ltd National Trading Company (NZ) Ltd Neil Construction Ltd Gary Harfield			✓				15
Env-2007-AKL-000567 PC 16	Auckland Regional Council	National Trading Company (NZ) Ltd Progressive Enterprises Ltd Neil Construction Ltd Gary Harfield CSR and Others Auckland Regional Council The Warehouse Ltd Warehouse Stationary Auckland Regional Transport Authority					✓		
Env-2007-AKL-000680 PC 16	AMP Capital Investors (NZ) Ltd						✓		

ENV Court Number	Appellants To WCC Plan Changes	Section 274 Parties	Appeals - Text					Appeals Maps	
			PC 13	PC 14	PC 15	PC 16	PC 17		PC 18
Env-2007-AKL-000680 PC 17	AMP Capital Investors (NZ) Ltd	National Trading Company (NZ) Ltd Graeme Berryman Progressive Enterprises Ltd CSR and Others The Warehouse Ltd Warehouse Stationary					✓		
Env-2007-AKL-000680 PC 18	AMP Capital Investors (NZ) Ltd	National Trading Company (NZ) Ltd Progressive Enterprises Ltd CSR and Others The Warehouse Ltd Warehouse Stationary							✓
Env-2007-AKL-000556 PC 16	CSR, Huhtamaki (NZ), and others	Progressive Enterprises Ltd National Trading Company (NZ) Ltd Auckland Regional Council Neil Construction Ltd Gary Harfield						✓	
Env-2007-AKL-000556 PC 17	CSR, Huhtamaki (NZ), and others	Vusich, Borich, Bhana & others Progressive Enterprises Ltd National Trading Company (NZ) Ltd Auckland Regional Council						✓	17
Env-2007-AKL-000556 PC 18	CSR, Huhtamaki (NZ), and others	Progressive Enterprises Ltd National Trading Company (NZ) Ltd Auckland Regional Council							✓
Env-2007-AKL-000648	Gareja Brothers Strawberry Gardens	National Trading Company (NZ) Ltd Westfield NZ Ltd Titan Hunter Ltd IMF NZ Ltd						✓	15
Env-2007-AKL-000629	Gary Harfield	Neil Construction Ltd						✓	16
Env-2007-AKL-000678	Henry Norcross - Withdrawn	National Trading Company (NZ) Ltd Transit NZ						✓	15

ENV Court Number	Appellants To WCC Plan Changes	Section 274 Parties	Appeals - Text					Appeals Maps	
			PC 13	PC 14	PC 15	PC 16	PC 17		PC 18
Env-2007-AKL-000609 PC 14	IMF NZ Ltd	Ockleston Family Trust National Trading Company (NZ) Ltd Fulton Hogan Ltd Auckland Regional Transport Authority		✓					14
Env-2007-AKL-000616 PC 15	IMF NZ Ltd	National Trading Company (NZ) Ltd Westfield NZ Ltd Auckland Regional Council Transit NZ Titan Hunter Ltd Auckland Regional Transport Authority			✓				15
Env-2007-AKL-000614 PC 18	IMF NZ Ltd	Progressive Enterprises Ltd						✓	
Env-2007-AKL-000537	Ivan and Milka Selak	Transit NZ National Trading Company (NZ) Ltd Neil Construction Ltd Gary Harfield					✓		16
Env-2007-AKL-000626	John Calvert	Neil Construction Ltd Gary Harfield					✓		16
Env-2007-AKL-000522	Land Transport NZ	Progressive Enterprises Ltd Auckland Regional Council Titan Hunter Property Ltd IMF NZ Ltd							15
Env-2007-AKL-000542	Maycey's Confectionary	CSR and Others						✓	
Env-2007-AKL-000623	Midgley, IB+GA, IE	National Trading Company (NZ) Ltd Progressive Enterprises Ltd Westfield NZ Ltd Auckland Regional Council Titan Hunter Ltd Transpower NZ Ltd IMF NZ Ltd							15
Env-2007-AKL-000658	Neil Construction Ltd	Gary Harfield IMF NZ Ltd						✓	16

ENV Court Number	Appellants To WCC Plan Changes	Section 274 Parties	Appeals - Text					Appeals Maps		
			PC 13	PC 14	PC 15	PC 16	PC 17		PC 18	
		Westfield (NZ) Ltd Auckland Regional Council IMF (NZ) Ltd Westgate Properties Ltd Titan Hunter Ltd			✓					
Env-2007-AKL-000533	Neon Ltd and Boron Ltd	Waitakere Properties Ltd Hobsonville Land Company Ltd	✓							15
Env-2007-AKL-000552	North Shore CC	Auckland Regional Council Land Transport NZ Auckland Regional Transport Authority								13
Env-2007-AKL-000543	Ockleston Family Trust	National Trading Company (NZ) Ltd Transit NZ Auckland Regional Council Auckland Regional Transport Authority The Warehouse Ltd Warehouse Stationary Hobsonville Land Company Ltd		✓						14
Env-2007-AKL-000585 PC 13	Progressive Enterprises Ltd	National Trading Company (NZ) Ltd Transit NZ Auckland Regional Council The Warehouse Ltd Warehouse Stationary Auckland Regional Transport Authority IMF NZ Ltd								
Env-2007-AKL-000597 PC 14	Progressive Enterprises Ltd	National Trading Company (NZ) Ltd Transit NZ Westfield NZ Ltd Auckland Regional Council The Warehouse Ltd Warehouse Stationary Auckland Regional Transport Authority IMF NZ Ltd			✓					
Env-2007-AKL-000594 PC 15	Progressive Enterprises Ltd	National Trading Company (NZ) Ltd Transit NZ Westfield NZ Ltd Auckland Regional Council The Warehouse Ltd Warehouse Stationary Auckland Regional Transport Authority Westgate Properties Ltd IMF NZ Ltd			✓					

ENV Court Number	Appellants To WCC Plan Changes	Section 274 Parties	Appeals - Text						Appeals Maps
			PC 13	PC 14	PC 15	PC 16	PC 17	PC 18	
Env-2007-AKL-000591 PC 16	Progressive Enterprises Ltd	National Trading Company (NZ) Ltd Westfield (NZ) Ltd Transit NZ Neil Construction Ltd Gary Harfield CSR and Others Auckland Regional Council The Warehouse Ltd Warehouse Stationary Auckland Regional Transport Authority IMF NZ Ltd				✓			
Env-2007-AKL-000581 PC 17	Progressive Enterprises Ltd	National Trading Company (NZ) Ltd Transit NZ CSR and Others Auckland Regional Council The Warehouse Ltd Warehouse Stationary Auckland Regional Transport Authority					✓		17
Env-2007-AKL-000596 PC 18	Progressive Enterprises Ltd	National Trading Company (NZ) Ltd Transit NZ CSR and Others Auckland Regional Council The Warehouse Ltd Warehouse Stationary Auckland Regional Transport Authority						✓	
Env-2007-AKL-000589	Titan Hunter Trust				✓	■			15
Env-2007-AKL-000540	Roy Wigg	Transit NZ National Trading Company (NZ) Ltd Neil Construction Ltd Gary Harfield					✓		16

ENV Court Number	Appellants To WCC Plan Changes	Section 274 Parties	Appeals - Text					Appeals Maps	
			PC 13	PC 14	PC 15	PC 16	PC 17		PC 18
Env-2007-AKL-000538	Steve Nuich	Transit NZ National Trading Company (NZ) Ltd Neil Construction Ltd Gary Harfield Progressive Enterprises Ltd Transit NZ Auckland Regional Council Hobsonville Land Company Ltd Auckland Regional Transport Authority IMF NZ Ltd				✓			16
Env-2007-AKL-000564 PC 13	National Trading Company (NZ) Ltd	Ockleston Family Trust Progressive Enterprises Ltd Transit NZ Auckland Regional Council Fulton Hogan Ltd Auckland Regional Transport Authority IMF NZ Ltd		✓					
Env-2007-AKL-000563 PC 14	National Trading Company (NZ) Ltd	Progressive Enterprises Ltd Transit NZ Westfield NZ Ltd Auckland Regional Council Titan Hunter Ltd Auckland Regional Transport Authority IMF NZ Ltd				✓			
Env-2007-AKL-000561 PC 15	National Trading Company (NZ) Ltd	The Warehouse Ltd, Warehouse Stationary Ltd Progressive Enterprises Ltd Transit NZ Neil Construction Ltd Gary Harfield CSR and Others Auckland Regional Council Auckland Regional Transport Authority			✓				
Env-2007-AKL-000560 PC 16	National Trading Company (NZ) Ltd							✓	

A7

ENV Court Number	Appellants To WCC Plan Changes	Section 274 Parties	Appeals - Text					Appeals Maps	
			PC 13	PC 14	PC 15	PC 16	PC 17		PC 18
Env-2007-AKL-000558 PC 17	National Trading Company (NZ) Ltd	The Warehouse Ltd, Warehouse Stationary Ltd Progressive Enterprises Ltd CSR and Others Auckland Regional Council Auckland Regional Transport Authority					▼		17
Env-2007-AKL-000555 PC 18	National Trading Company (NZ) Ltd	Progressive Enterprises Ltd CSR and Others Auckland Regional Council Auckland Regional Transport Authority IMF NZ Ltd						▼	
Env-2007-AKL-000641 PC 16	The Warehouse Ltd	National Trading Company (NZ) Ltd Progressive Enterprises Ltd Wesifield (NZ) Ltd Neil Construction Ltd Gary Harfield Auckland Regional Council Transit NZ Auckland Regional Transport Authority IMF NZ Ltd						▼	
Env-2007-AKL-000646 PC 17	The Warehouse Ltd	National Trading Company (NZ) Ltd Progressive Enterprises Ltd Auckland Regional Council Auckland Regional Transport Authority						▼	
Env-2007-AKL-000664 PC 18	The Warehouse Ltd	National Trading Company (NZ) Ltd Progressive Enterprises Ltd Auckland Regional Council Transit NZ Auckland Regional Transport Authority IMF NZ Ltd							▼

As

ENV Court Number	Appellants To WCC Plan Changes	Section 274 Parties	Appeals - Text						Appeals Maps	
			PC 13	PC 14	PC 15	PC 16	PC 17	PC 18		
Env-2007-AKL-000613 PC 14	Transit NZ	Ockleston Family Trust National Trading Company (NZ) Ltd Land Transport NZ Hobsonville Land Company Ltd Fulton Hogan Ltd		✓						14
Env-2007-AKL-000613 PC 15	Transit NZ	National Trading Company (NZ) Ltd Westfield NZ Ltd Hobsonville Land Company Ltd Auckland Regional Transport Authority IMF NZ Ltd			✓					15
Env-2007-AKL-000613 PC 16	Transit NZ	National Trading Company (NZ) Ltd Neil Construction Ltd Gary Harfield Hobsonville Land Company Ltd IMF NZ Ltd					✓			
Env-2007-AKL-000545	Vusich, Borich, Bhana & others	Progressive Enterprises Ltd CSR and Others						✓		
Env-2007-AKL-000530	Waitakere Ranges Protection Society	Neil Construction Ltd Gary Harfield						✓		
Env-2007-AKL-000636 PC 16	Warehouse Stationary Ltd	National Trading Company (NZ) Ltd Progressive Enterprises Ltd Westfield (NZ) Ltd Neil Construction Ltd Gary Harfield Auckland Regional Council Transit NZ Auckland Regional Transport Authority IMF NZ Ltd								16
Env-2007-AKL-000639 PC 17	Warehouse Stationary Ltd	National Trading Company (NZ) Ltd Progressive Enterprises Ltd Auckland Regional Council Auckland Regional Transport Authority							✓	

ENV Court Number	Appellants To WCC Plan Changes	Section 274 Parties	Appeals - Text					Appeals Maps		
			PC 13	PC 14	PC 15	PC 16	PC 17		PC 18	
Env-2007-AKL-000642 PC 18	Warehouse Stationary Ltd	National Trading Company (NZ) Ltd Progressive Enterprises Ltd Auckland Regional Council Transit NZ Auckland Regional Transport Authority IMF NZ Ltd								
ENV-2007-AKL-000711 PC15	Westfield (NZ) Ltd	National Trading Company (NZ) Ltd IMF NZ Ltd			▼					
Env-2007-AKL-000595 PC16	Westfield (NZ) Ltd	Progressive Enterprises Ltd Transit NZ Neil Construction Ltd Gary Harfield Auckland Regional Council The Warehouse Ltd Warehouse Stationary Auckland Regional Transport Authority IMF NZ Ltd							▼	
Env-2007-AKL-000618	Westgate Properties Ltd	Progressive Enterprises Ltd Westfield NZ Ltd Auckland Regional Council Titan Hunter Ltd Transpower NZ Ltd Auckland Regional Transport Authority								18

A10