

LIMEBURNERS BAY HERITAGE AREA

PURPOSE OF THE REPORT

The purpose of this report is to update the Projects Special Committee on issues relating to the Limeburners Bay heritage area, and to seek approval for the establishment of appropriate protection measures.

BACKGROUND

The Carder Brothers site in Limeburners Bay is an historic place of considerable heritage value. The site was home to one of Auckland's earliest industrial operations, focussed around the clay industry. Archaeological investigations have identified a number of historic structures on the site, including brick wells, tanks and flues, which clearly identify the importance of this area as an industrial heritage site.

This significance is recognised in the Council's District Plan, which specifically protects the site, and through the provisions of the Historic Places Act. The Council has prepared a draft Conservation Plan to assist in the ongoing protection and preservation of the heritage site.

A20
AT
A plan attached at page ^{A20} AT indicates the location of Limeburners Bay, and identifies the main heritage site within this area.

STRATEGIC CONTEXT

Protection and management of heritage sites is an important strategic objective of the Council.

The Council has a responsibility to preserve the cultural heritage of Waitakere City, in order to provide a historic context for current and future generations. Existing heritage sites of significance should be afforded adequate protection to ensure their long-term conservation.

ISSUES

In recent times, two potential threats have emerged in relation to the heritage site at Limeburners Bay.

Unauthorised Vehicle Access

The area to the north-east of the main heritage site has become popular with four-wheel drive enthusiasts and off-road motorcycle riders. This activity is giving rise to some concern, as these vehicles may inadvertently damage some of the artefacts that are found throughout this area.

A20
AT
The majority of the land that contains the heritage sites is privately owned. Access to this land is generally gained from the paper road that extends from Scott Road down to the Limeburners Bay foreshore. It is proposed to erect a low barrier and signage at this location to prevent unauthorised access and to advise the public of the historical significance of the area. The location of the paper road and proposed barrier are shown on the plan attached at page ^{A20} AT.

Discussions with the landowner have been held to gain agreement for the establishment of the barrier. At this stage, it appears that the landowner will accept in principle the establishment of a barrier at this location, subject to consideration of the specific location and design of the structure. A final design of the barrier has yet to be developed.

It is anticipated that the establishment of the barrier and the signage can be completed in the near future.

Subdivision

^{A21}
~~A2~~ Council has recently issued a subdivision consent for land immediately to the west of the historic site. A plan of the subdivision is attached to this report attached at page ~~A2~~^{A21}. The subdivision consent provides for the development of one of the last remaining blocks of residential land within the local area.

Given the proximity of the subdivision to the heritage site, the Council has taken steps to ensure that the historic remains will not be disturbed in any way by the development works that are proposed in the surrounding area. In order to achieve this, the Council required that the plan of subdivision was amended by realigning the boundary of the proposed reserve (lot 101 on the subdivision plan) to the extent that all known artefacts will be contained within either existing or proposed reserve.

In addition, the Council has required that protective covenants be registered on the titles of proposed lots 69, 72 and 76 to preserve the existing vegetation that covers the historic site and the surrounding land. The land subject to restrictive covenant is identified on the subdivision plan. The effect of this restriction will be to confine future dwellings to building platforms that are well removed from the historic site. No development work or site modification can occur in the covenanted area on each site. This will provide an effective buffer around the known historic remains, sufficient to preserve the site even if it were subsequently determined that the historic remains extend significantly further than is currently recorded through archaeological survey.

RESOURCES

It is estimated that the establishment of a vehicle barrier and signage would be completed for less than \$5,000.

Funding for heritage protection works at Limeburners Bay was previously approved by the Council at its meeting of 25 July 2001, on the basis that the works would only be established if there was a demonstrated need. The resolution was as follows:

- "2. *That the Council undertake to fund security fencing and other protection works at the Carder Brothers Heritage Site, at Limeburners Bay, Hobsonville, on an interim basis from short term borrowing which will be repaid from the Transit New Zealand Heritage Fund when received.*"

1727/2001

However, the relatively low cost of the works currently proposed mean that they can be accommodated within existing budgets that will not be fully spent within the current financial year. It will therefore not be necessary to raise the money separately through a loan.

It is proposed that the works would be completed using unspent funds in the 'Street Lighting Main Street Development' budget. Expenditure from this budget was reliant on a joint funding approach with United Networks that has not occurred within the current financial year. Sufficient funds are available from this source to establish the barrier and signage.

No other unbudgeted resources are required.

CONCLUSION

Two potential threats have been identified in relation to the Limeburners Bay heritage site, being subdivision of adjoining land and unauthorised vehicle access.

Careful consideration of a recent application for subdivision consent has ensured that future residential development in the vicinity will not pose a significant threat to the site. Unauthorised access of vehicles can be controlled through the establishment of a barrier and signage at the main point of access to the land that contains the heritage site.

RECOMMENDATIONS

1. That the information be received.
2. That approval be given for the establishment of an appropriate barrier structure and signage at the southern end of the paper road that leads from Scott Road to the Limeburners Bay foreshore, sufficient to prevent unauthorised access of vehicles into the land containing the Joshua Carder and Carder Brothers heritage sites.
3. That the matter be referred to the Finance and Operational Performance Committee with a request that funding for the barrier and signage be reassigned from proposed savings in the 'Street Lighting Main Street Development' budget.

Report prepared by: Philip Brown, Group Manager: Planning and Community Services.

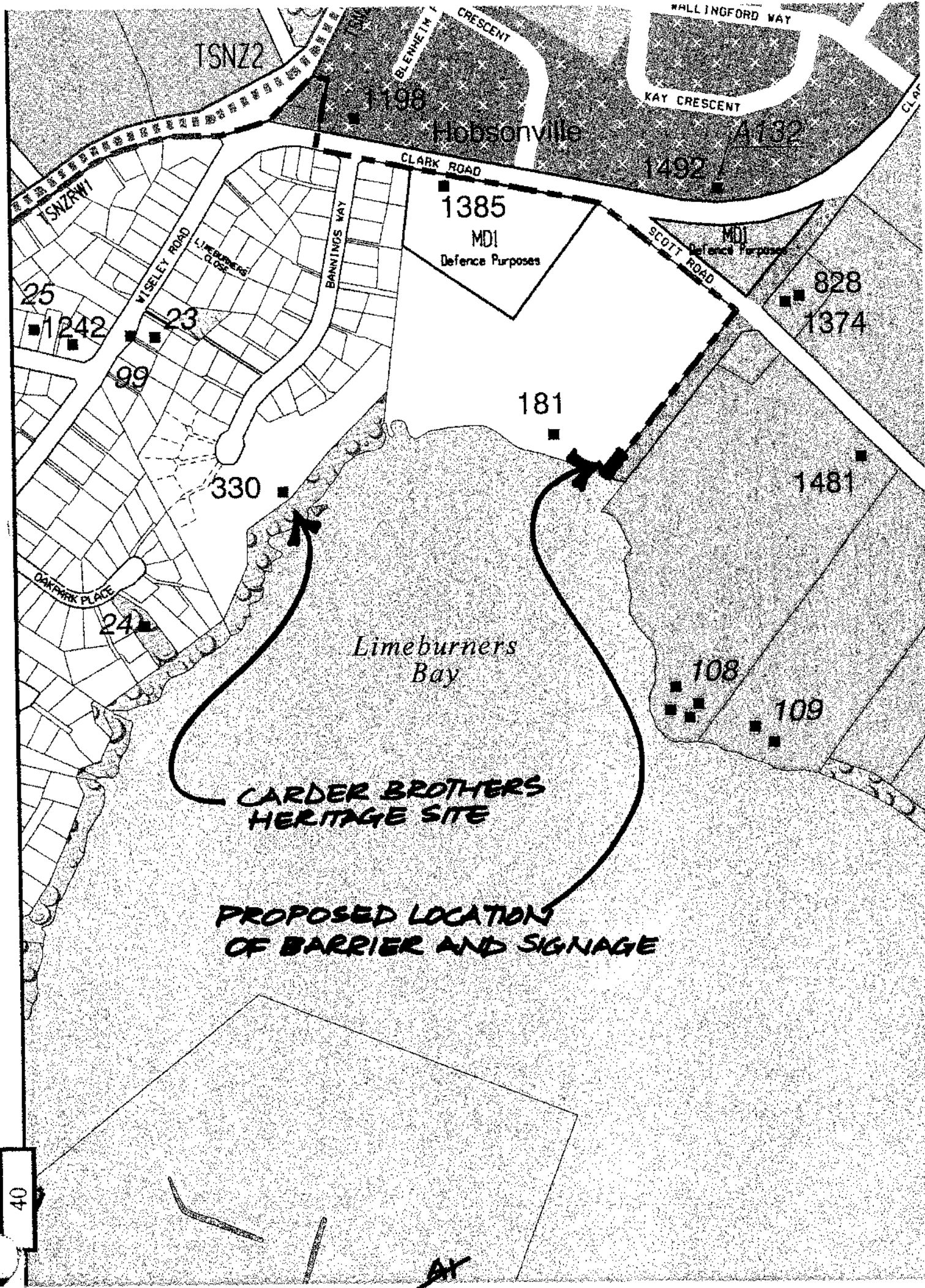

CARDER BROTHERS
HERITAGE SITE

PROPOSED LOCATION
OF BARRIER AND SIGNAGE

40

AT
A20

This document is the property of Cato Bolam Consultants Ltd and must be returned to the office of Cato Bolam Consultants Ltd, 100 The Arcade, Auckland 1.

LOCAL AUTHORITY WAITAKERE CITY
COMPRISED IN CT 116A/B21
SURVEY BK & DISTRICT X WAITERATA
TOTAL AREA 1.9871 ha
LEVELS ARE IN TERMS OF LANDS AND SURVEY DATUM
AREAS AND MEASUREMENTS ARE SUBJECT TO SURVEY

AMALGAMATION CONDITIONS

That Lot 9 herein (legal access) be held as to 6
 27 68480.7071 and 72 herein as to 10 6
 common in the said shares and that individual
 conditions of this be issued in accordance
 therewith.

That Lot 5 DP185734 herein (legal access) be
 held as to 68 48180.7071 and 72 herein as to 10 6
 common in the said shares and that individual
 conditions of this be issued in accordance
 therewith.

That Lot 34 DP168560 herein (legal access) be
 held as to 1 unfranchised one-third share by the
 owner of Lot 100 herein as tenants in common
 in the said share and that an individual Certificate
 of Title be issued in accordance therewith.

Area C. D. E. & F. are to be
 subject to restrictive covenants.

MEMORANDUM OF AGREEMENTS

| Particulars | Shown | Surveyed | Demarcated |
|-------------|-------|----------|------------|
| Section 1 | 1 | 1 | 1 |
| Section 2 | 2 | 2 | 2 |
| Section 3 | 3 | 3 | 3 |
| Section 4 | 4 | 4 | 4 |
| Section 5 | 5 | 5 | 5 |
| Section 6 | 6 | 6 | 6 |
| Section 7 | 7 | 7 | 7 |
| Section 8 | 8 | 8 | 8 |
| Section 9 | 9 | 9 | 9 |
| Section 10 | 10 | 10 | 10 |
| Section 11 | 11 | 11 | 11 |
| Section 12 | 12 | 12 | 12 |
| Section 13 | 13 | 13 | 13 |
| Section 14 | 14 | 14 | 14 |
| Section 15 | 15 | 15 | 15 |
| Section 16 | 16 | 16 | 16 |
| Section 17 | 17 | 17 | 17 |
| Section 18 | 18 | 18 | 18 |
| Section 19 | 19 | 19 | 19 |
| Section 20 | 20 | 20 | 20 |
| Section 21 | 21 | 21 | 21 |
| Section 22 | 22 | 22 | 22 |
| Section 23 | 23 | 23 | 23 |
| Section 24 | 24 | 24 | 24 |
| Section 25 | 25 | 25 | 25 |
| Section 26 | 26 | 26 | 26 |
| Section 27 | 27 | 27 | 27 |
| Section 28 | 28 | 28 | 28 |
| Section 29 | 29 | 29 | 29 |
| Section 30 | 30 | 30 | 30 |
| Section 31 | 31 | 31 | 31 |
| Section 32 | 32 | 32 | 32 |
| Section 33 | 33 | 33 | 33 |
| Section 34 | 34 | 34 | 34 |
| Section 35 | 35 | 35 | 35 |
| Section 36 | 36 | 36 | 36 |
| Section 37 | 37 | 37 | 37 |
| Section 38 | 38 | 38 | 38 |
| Section 39 | 39 | 39 | 39 |
| Section 40 | 40 | 40 | 40 |
| Section 41 | 41 | 41 | 41 |
| Section 42 | 42 | 42 | 42 |
| Section 43 | 43 | 43 | 43 |
| Section 44 | 44 | 44 | 44 |
| Section 45 | 45 | 45 | 45 |
| Section 46 | 46 | 46 | 46 |
| Section 47 | 47 | 47 | 47 |
| Section 48 | 48 | 48 | 48 |
| Section 49 | 49 | 49 | 49 |
| Section 50 | 50 | 50 | 50 |
| Section 51 | 51 | 51 | 51 |
| Section 52 | 52 | 52 | 52 |
| Section 53 | 53 | 53 | 53 |
| Section 54 | 54 | 54 | 54 |
| Section 55 | 55 | 55 | 55 |
| Section 56 | 56 | 56 | 56 |
| Section 57 | 57 | 57 | 57 |
| Section 58 | 58 | 58 | 58 |
| Section 59 | 59 | 59 | 59 |
| Section 60 | 60 | 60 | 60 |
| Section 61 | 61 | 61 | 61 |
| Section 62 | 62 | 62 | 62 |
| Section 63 | 63 | 63 | 63 |
| Section 64 | 64 | 64 | 64 |
| Section 65 | 65 | 65 | 65 |
| Section 66 | 66 | 66 | 66 |
| Section 67 | 67 | 67 | 67 |
| Section 68 | 68 | 68 | 68 |
| Section 69 | 69 | 69 | 69 |
| Section 70 | 70 | 70 | 70 |
| Section 71 | 71 | 71 | 71 |
| Section 72 | 72 | 72 | 72 |
| Section 73 | 73 | 73 | 73 |
| Section 74 | 74 | 74 | 74 |
| Section 75 | 75 | 75 | 75 |
| Section 76 | 76 | 76 | 76 |
| Section 77 | 77 | 77 | 77 |
| Section 78 | 78 | 78 | 78 |
| Section 79 | 79 | 79 | 79 |
| Section 80 | 80 | 80 | 80 |
| Section 81 | 81 | 81 | 81 |
| Section 82 | 82 | 82 | 82 |
| Section 83 | 83 | 83 | 83 |
| Section 84 | 84 | 84 | 84 </tr |

| DATE | BY | FOR |
|------------|----------|---------|
| 27/02/2014 | DP185734 | Lot 5 |
| 27/02/2014 | DP185734 | Lot 6 |
| 27/02/2014 | DP185734 | Lot 7 |
| 27/02/2014 | DP185734 | Lot 8 |
| 27/02/2014 | DP185734 | Lot 9 |
| 27/02/2014 | DP185734 | Lot 10 |
| 27/02/2014 | DP185734 | Lot 11 |
| 27/02/2014 | DP185734 | Lot 12 |
| 27/02/2014 | DP185734 | Lot 13 |
| 27/02/2014 | DP185734 | Lot 14 |
| 27/02/2014 | DP185734 | Lot 15 |
| 27/02/2014 | DP185734 | Lot 16 |
| 27/02/2014 | DP185734 | Lot 17 |
| 27/02/2014 | DP185734 | Lot 18 |
| 27/02/2014 | DP185734 | Lot 19 |
| 27/02/2014 | DP185734 | Lot 20 |
| 27/02/2014 | DP185734 | Lot 21 |
| 27/02/2014 | DP185734 | Lot 22 |
| 27/02/2014 | DP185734 | Lot 23 |
| 27/02/2014 | DP185734 | Lot 24 |
| 27/02/2014 | DP185734 | Lot 25 |
| 27/02/2014 | DP185734 | Lot 26 |
| 27/02/2014 | DP185734 | Lot 27 |
| 27/02/2014 | DP185734 | Lot 28 |
| 27/02/2014 | DP185734 | Lot 29 |
| 27/02/2014 | DP185734 | Lot 30 |
| 27/02/2014 | DP185734 | Lot 31 |
| 27/02/2014 | DP185734 | Lot 32 |
| 27/02/2014 | DP185734 | Lot 33 |
| 27/02/2014 | DP185734 | Lot 34 |
| 27/02/2014 | DP185734 | Lot 35 |
| 27/02/2014 | DP185734 | Lot 36 |
| 27/02/2014 | DP185734 | Lot 37 |
| 27/02/2014 | DP185734 | Lot 38 |
| 27/02/2014 | DP185734 | Lot 39 |
| 27/02/2014 | DP185734 | Lot 40 |
| 27/02/2014 | DP185734 | Lot 41 |
| 27/02/2014 | DP185734 | Lot 42 |
| 27/02/2014 | DP185734 | Lot 43 |
| 27/02/2014 | DP185734 | Lot 44 |
| 27/02/2014 | DP185734 | Lot 45 |
| 27/02/2014 | DP185734 | Lot 46 |
| 27/02/2014 | DP185734 | Lot 47 |
| 27/02/2014 | DP185734 | Lot 48 |
| 27/02/2014 | DP185734 | Lot 49 |
| 27/02/2014 | DP185734 | Lot 50 |
| 27/02/2014 | DP185734 | Lot 51 |
| 27/02/2014 | DP185734 | Lot 52 |
| 27/02/2014 | DP185734 | Lot 53 |
| 27/02/2014 | DP185734 | Lot 54 |
| 27/02/2014 | DP185734 | Lot 55 |
| 27/02/2014 | DP185734 | Lot 56 |
| 27/02/2014 | DP185734 | Lot 57 |
| 27/02/2014 | DP185734 | Lot 58 |
| 27/02/2014 | DP185734 | Lot 59 |
| 27/02/2014 | DP185734 | Lot 60 |
| 27/02/2014 | DP185734 | Lot 61 |
| 27/02/2014 | DP185734 | Lot 62 |
| 27/02/2014 | DP185734 | Lot 63 |
| 27/02/2014 | DP185734 | Lot 64 |
| 27/02/2014 | DP185734 | Lot 65 |
| 27/02/2014 | DP185734 | Lot 66 |
| 27/02/2014 | DP185734 | Lot 67 |
| 27/02/2014 | DP185734 | Lot 68 |
| 27/02/2014 | DP185734 | Lot 69 |
| 27/02/2014 | DP185734 | Lot 70 |
| 27/02/2014 | DP185734 | Lot 71 |
| 27/02/2014 | DP185734 | Lot 72 |
| 27/02/2014 | DP185734 | Lot 73 |
| 27/02/2014 | DP185734 | Lot 74 |
| 27/02/2014 | DP185734 | Lot 75 |
| 27/02/2014 | DP185734 | Lot 76 |
| 27/02/2014 | DP185734 | Lot 77 |
| 27/02/2014 | DP185734 | Lot 78 |
| 27/02/2014 | DP185734 | Lot 79 |
| 27/02/2014 | DP185734 | Lot 80 |
| 27/02/2014 | DP185734 | Lot 81 |
| 27/02/2014 | DP185734 | Lot 82 |
| 27/02/2014 | DP185734 | Lot 83 |
| 27/02/2014 | DP185734 | Lot 84 |
| 27/02/2014 | DP185734 | Lot 85 |
| 27/02/2014 | DP185734 | Lot 86 |
| 27/02/2014 | DP185734 | Lot 87 |
| 27/02/2014 | DP185734 | Lot 88 |
| 27/02/2014 | DP185734 | Lot 89 |
| 27/02/2014 | DP185734 | Lot 90 |
| 27/02/2014 | DP185734 | Lot 91 |
| 27/02/2014 | DP185734 | Lot 92 |
| 27/02/2014 | DP185734 | Lot 93 |
| 27/02/2014 | DP185734 | Lot 94 |
| 27/02/2014 | DP185734 | Lot 95 |
| 27/02/2014 | DP185734 | Lot 96 |
| 27/02/2014 | DP185734 | Lot 97 |
| 27/02/2014 | DP185734 | Lot 98 |
| 27/02/2014 | DP185734 | Lot 99 |
| 27/02/2014 | DP185734 | Lot 100 |

CATO BOLAM CONSULTANTS

SURVEYORS PLANNERS

LAND DEVELOPMENT CONSULTANTS

CATO BOLAM CONSULTANTS LTD

27, Victoria Avenue, Auckland
 Auckland 1010 New Zealand
 Telephone 09 308 21 00
 Facsimile 09 308 21 01
 Email cato@catobolam.co.nz

Phone 09 308 21 00
 Fax 09 308 21 01

BANKING
LIMEBURNERS BAY
WEST HARBOUR

SUBDIVISION STAGE 6B

| | | | | | |
|---------------|------|--------------|----|------------|----|
| OFFICIAL PLAN | 1750 | SECTION SIZE | 12 | SECTION NO | 40 |
| DATE | | PLAN NUMBER | 12 | SECTION NO | 40 |
| PROJECT | | PLAN NUMBER | 12 | SECTION NO | 40 |

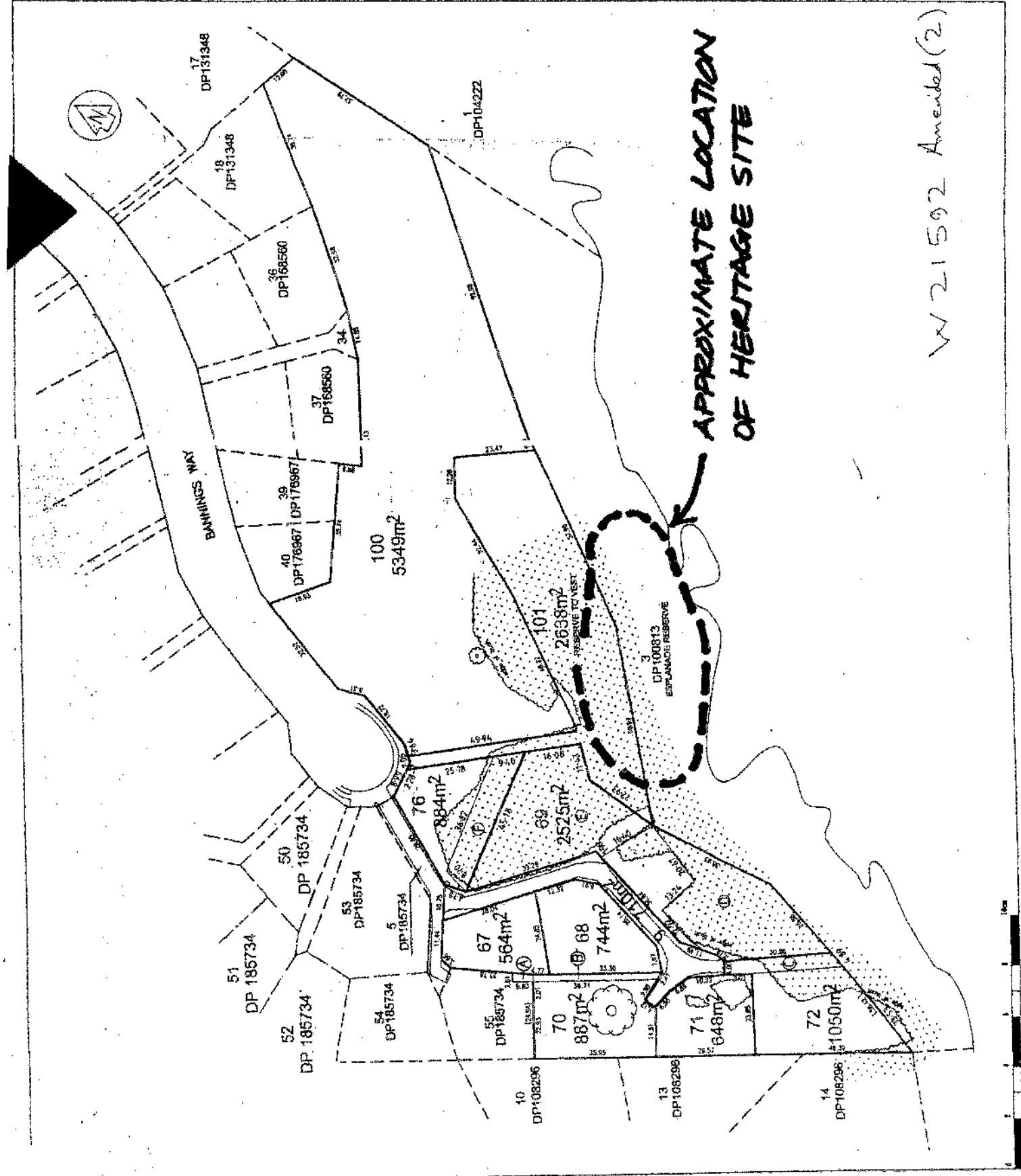

APPROXIMATE LOCATION OF HERITAGE SITE

W 21 592 Amended (2)

A2 A21

Waitakere City Council
Management Report
April 2003
Executive Report

| | Actual ToDate | % Spent on Budget | Annual Budget |
|--------------------------------------|-------------------|-------------------------|-------------------|
| Operating Costs | | | |
| Executive Suite | 1,309,467 | 65% | 2,003,278 |
| Maori Issues | 426,818 | 102% | 419,729 |
| Public Affairs | 1,768,925 | 90% | 1,959,638 |
| Corporate and Civic Services | 9,321,765 | 82% | 11,325,769 |
| Finance | 999,890 | 72% | 1,397,603 |
| Strategic Projects | 2,265,357 | 67% | 3,398,457 |
| Strategic Group | 3,839,323 | 74% | 5,187,458 |
| City Services | | | |
| City Enterprises | | | |
| Animal Welfare Services | 241,034 | 63% | 382,214 |
| Cemetery & Crematorium | 36,202 | 135% | 26,758 |
| Vehicle Testing Station | (78,722) | 24% | (324,067) |
| Consultancy Services | (18,495) | 4% | (494,171) |
| Property Services | 1,523,112 | 76% | 1,994,278 |
| Aquatic and Recreation Centre | 1,473,390 | 234% | 629,946 |
| Solid Waste and Baling Station | 1,843,033 | 65% | 2,857,102 |
| Total City Enterprises | 5,019,554 | 99% | 5,072,060 |
| Ecowater | | | |
| Administration | 3,814,879 | 98% | 3,882,940 |
| Wastewater | 15,250,014 | 83% | 18,271,711 |
| Stormwater | 2,865,967 | 83% | 3,433,416 |
| Water Supply | (3,920,536) | 102% | (3,858,515) |
| Total Ecowater | 18,010,324 | 83% | 21,729,552 |
| Audit and Support | 2,311,534 | 92% | 2,525,403 |
| Field Services | 976,740 | 52% | 1,882,664 |
| Consent Services | (261,769) | (36%) | 718,429 |
| Customer Services | 1,710,491 | 81% | 2,102,898 |
| Resource Management | 569,015 | 74% | 773,623 |
| Leisure Services | 765,487 | 66% | 1,154,590 |
| Aftercare and Special Projects | 670,356 | 70% | 959,660 |
| Roading | 9,019,754 | 80% | 11,319,713 |
| Parks and Green Assets | 8,050,981 | 73% | 10,983,417 |
| Total City Services | 46,842,467 | 79% | 59,222,009 |
| Total Operational Expenditure | 66,774,012 | 79% | 84,913,941 |

Waitakere City Council
Management Report
April 2003
CAPITAL EXPENDITURE

| | Actual Spent YearToDate | % Spent on Budget | Annual Budget |
|----------------------------------|----------------------------|-------------------------|-------------------|
| Renewal Expenditure | | | |
| Property Renewals | 276,566 | 71% | 387,500 |
| Roading Renewals | 1,609,042 | 30% | 5,354,440 |
| Parks and Green Assets Renewals | 404,753 | 31% | 1,300,983 |
| Ecowater Renewals | | | |
| Wastewater | 1,059,613 | 60% | 1,774,883 |
| Stormwater | 702,288 | 55% | 1,282,771 |
| Water Supply | 2,309,644 | 73% | 3,174,912 |
| Total Renewal Expenditure | 6,361,906 | 48% | 13,275,489 |

| | Actual ToDate | % Spent on Budget | Annual Budget |
|--|-------------------|-------------------------|-------------------|
| Capital Works Expenditure | | | |
| Executive Suite | 0 | 0% | 10,000 |
| Public Affairs | 6,000 | 60% | 10,000 |
| Strategic Projects | 8,255,765 | 23% | 36,209,364 |
| Corporate and Civic Services | | | |
| Plant Renewal | 371,906 | 73% | 511,800 |
| Civic and Administration | 174,584 | 9% | 1,884,000 |
| Information Management | 792,145 | 30% | 2,661,922 |
| Libraries | 747,838 | 34% | 2,226,514 |
| Total Corporate & Civic | 2,086,473 | 29% | 7,284,236 |
| City Services | | | |
| City Enterprises | | | |
| Animal Welfare Services | (10,514) | (42%) | 25,000 |
| Cemetery & Crematorium | 72,421 | 7% | 1,092,900 |
| Property Expenditure | 42,300 | 21% | 197,500 |
| Aquatic and Recreation Centre | 4,431,018 | 89% | 4,968,500 |
| Solid Waste and Baling Station | 55,799 | 19% | 300,000 |
| Total City Enterprises | 4,591,024 | 70% | 6,583,900 |
| Ecowater | | | |
| Ecowater Capital Works | 5,298,129 | 36% | 14,672,925 |
| Ecowater Business Assets | 116,913 | 100% | 117,000 |
| Total Ecowater | 5,415,042 | 37% | 14,789,925 |
| Consent Services | 18,242 | 55% | 33,078 |
| Leisure Services | 157,085 | 22% | 710,000 |
| Aftercare and Special Projects | 348,587 | 51% | 683,793 |
| Roading Capital Works | 920,590 | 7% | 12,604,591 |
| Parks and Green Assets Capital Works | 1,293,905 | 31% | 4,155,200 |
| Total City Services | 12,744,475 | 32% | 39,560,487 |
| Total Capital Works Expenditure | 23,092,713 | 28% | 83,074,087 |

Waikare City Council
Special Funds Report
April 2003

| SPECIAL FUNDS | Opening | | Interest | | Closing | Budget / | Est. Yr End |
|---|-------------------|------------------|------------------|---------------|-------------------|------------------|-------------------|
| | Balance | Receipts | Expenditure | Received | | | |
| Restricted Funds | | | | | | | |
| Recreation & Sport Fund | 1,365,615 | 192,253 | 179,591 | 0 | 1,444,016 | 751,000 | 693,016 |
| Auckland Regional Services Trust (Arts) | 1,052,033 | | 900 | 20,860 | 1,101,121 | | 1,101,121 |
| Land Subdivision Reserve Fund | 4,315,015 | 1,602,438 | 952,082 | 0 | 5,167,714 | 2,139,356 | 3,048,358 |
| Waikumete Cemetery & Park Fund | 2,226,423 | 0 | 51,017 | 0 | 2,280,867 | 495,883 | 1,784,984 |
| People's Park Fund | 364,587 | 391,667 | 242,880 | 0 | 534,408 | 413,787 | 120,621 |
| | 9,323,674 | 2,186,357 | 1,426,470 | 20,860 | 10,548,126 | 3,800,026 | 6,748,100 |
| Non Restricted Funds | | | | | | | |
| Waitemata Asset Acquisition Fund | 93,071 | 0 | 0 | 0 | 93,071 | | 93,071 |
| New Lynn Asset Acquisition Fund | 347,107 | 0 | 0 | 0 | 347,107 | 342,000 | 5,107 |
| Disaster Recovery Fund | 2,497,272 | 0 | 0 | 0 | 2,497,272 | | 2,497,272 |
| Rural Fire Recovery Fund | 9,916 | 0 | 0 | 0 | 9,916 | | 9,916 |
| Quarry Aftercare Fund | 740,173 | 41,667 | 0 | 0 | 781,839 | (8,333) | 790,173 |
| Testing Station Plant Renewal Fund | 46,000 | 0 | 0 | 0 | 46,000 | 46,000 | 0 |
| Social Programme Fund | 580,277 | 0 | 20,000 | 0 | 587,603 | (5,500) | 593,103 |
| | 4,313,816 | 41,667 | 20,000 | 0 | 4,362,808 | 374,167 | 3,988,642 |
| Total Special / Separate Funds | 13,637,490 | 2,228,024 | 1,446,470 | 20,860 | 14,910,934 | 4,174,192 | 10,736,742 |

ADH

PAYMENTS FOR APPROVAL 18 APRIL 2003 TO 15 MAY 2003

The following payments are reported for the period 18 April 2003 to 15 May 2003

| | | |
|---|-----------------------------------|-------------------|
| a) Wages and Salaries (net of tax) | | 2,054,576 |
| b) Payments to ARC | | 17,276 |
| c) Watercare Services Limited | | 1,919,459 |
| d) Inland Revenue Department | | 759,465 |
| e) Loans - repayment of maturities/interest | | 14,560,536 |
| f) Investments | | 34,766,577 |
| g) Contract payments over \$50,000: | | |
| Acrow Limited | Scaffolding West Wave Maintenance | 109,001 |
| Auckland Civil Ltd | Various Contracts | 243,239 |
| Civil Construction Group Ltd | Various Contracts | 168,849 |
| Datacom Systems Ltd | Computerware & Charges | 70,984 |
| Electrix Ltd | Streetlight Maintenance | 156,204 |
| Excell Corp | Various Contracts | 58,720 |
| Fuji Xerox New Zealand Ltd | Photocopier Charges | 53,510 |
| Genesis Energy | Power | 86,144 |
| Hughes Civil Ltd | Various Contracts | 56,169 |
| John Andrew Ford | Vehicles | 103,142 |
| John McDowell Trust Account | Land Purchase - Alderman Drive | 552,045 |
| Lineset Graphics | Printing & Design | 58,848 |
| Lopdell House Society inc | Grants | 82,687 |
| M Keogh Contractors Limited | Slip Repair | 65,541 |
| Murray & Buckley | Various Contracts | 138,977 |
| Nasey Contractors Ltd | Pipe Bridge Repairs | 52,536 |
| Nzc Tileworks | Tiling Maintenance West Wave | 53,561 |
| Onyx Group Ltd | Domestic and Inorganic Collection | 252,117 |
| Parks & Maintenance Services Ltd | Various Contracts | 158,948 |
| Perry Waste Services Ltd | Waste Removal | 100,002 |
| Pipeworks Rehabilitation Solutions | Wastewater Works | 124,929 |
| Riteway Electrical Services | Various Contracts | 85,879 |
| Sinclair Knight Merz | Various Contracts | 64,298 |
| Stonedale Civil Contractors Ltd | Various Contracts | 63,151 |
| Sunrise Earthmovers Ltd | Harbourview Physical Works | 112,579 |
| Suspended Ceiling 1997 Ltd | West Wave Ceiling Maintenance | 124,491 |
| Techscape Limited | Various Contracts | 698,329 |
| Telecom New Zealand Ltd | Calls & Charges | 65,869 |
| The Weedfree Waitakere Trust | Weed Control | 51,196 |
| Total Cut Construction Ltd | West Wave Maintenance | 76,639 |
| Total Traffic Services | Traffic Signal Maintenance | 54,155 |
| URS New Zealand | Various Contracts | 59,510 |
| Waste Management NZ Ltd | Waste Disposal | 334,941 |
| Works Infrastructure Ltd | Various Contracts | 208,661 |
| | | 4,745,851 |
| h) Other payments over \$50,000: | | |
| Kensington Swan | Legal Fees | 50,717 |
| KPMG Legal | Legal Fees | 101,364 |
| Local Government New Zealand | Subscription & Projects | 110,738 |
| Mathew Casey Barrister | Legal Fees | 51,447 |
| NZ Police | Share of Fines | 56,155 |
| Southern Cross Healthcare | Healthcare | 56,890 |
| | | 427,311 |
| i) Other payments under \$50,000 | | 2,157,716 |
| TOTAL PAYMENTS | | 61,408,767 |

| Supplier | Amount | Description |
|--|------------|---|
| Access Security & Control | 8,328.49 | Animal Welfare Security Fence |
| Acrow Ltd | 48,883.67 | Scaffolding Contract - West Wave |
| Acrow Ltd | 60,117.85 | West Wave - Scaffolding |
| Air New Zealand Limited | 15,985.09 | Travel |
| Alex & Rosalie White Family Trust | 5,934.38 | Rent - GPT Building |
| Alida Robey | 13,132.32 | Assurance & Support Services |
| All Shine Cleaners | 7,555.87 | Cleaning |
| AMP Asset Management NZ Ltd - Property | 16,307.65 | Rent - New Lynn Library/Service Centre/CABX |
| Anderson & Associates Ltd | 6,082.03 | Contract Supervision |
| Approved Building Certifiers | 7,000.00 | Vehicle Crossing Bond Refunds |
| Aqualab (NZ) Ltd | 5,107.50 | Recreational Water Contract/Wastewater Piha |
| Amourguard Security Ltd | 15,356.25 | Noise Control |
| Arrow Civil Engineers Ltd | 23,619.38 | Veronica/Ward St Link Contract |
| Arthur D Riley & Co Ltd | 21,543.75 | Meters |
| Ashphalt & Repairs Limited | 36,969.10 | Cemetery Road Reconstruct Contract |
| Aspin Weed Control Ltd | 14,921.28 | Weed & Vegetation Control |
| Asplundh Tree Expert (NZ) Ltd | 45,527.05 | Parks - Tree Maintenance |
| Asset Construction Ltd | 32,636.81 | Woodglen Lasque Stormwater |
| Asset Forestry Limited | 6,750.00 | 6 Month Lease - K2V1 Professionals |
| ATL Systems (NZ) Limited | 5,435.22 | Computerware |
| Auckland Civil Ltd | 73,523.30 | Various Contracts |
| Auckland Civil Ltd | 13,686.47 | Parks Contract |
| Auckland Civil Ltd | 156,028.84 | Various Contracts |
| Auckland Regional Council | 6,812.92 | C.D.E.M.G Quarterly Contribution |
| Auckland Regional Council | 10,463.95 | Walcare Kits & Equipment |
| Autocare New Lynn | 5,086.69 | Repairs |
| Automatic Door & Building Maintenance | 5,721.75 | Repairs |
| Boise New Zealand Limited | 8,771.97 | Stationery |
| Bookworks | 9,167.03 | Books |
| BP Fuelcard | 26,390.52 | Fuel |
| Brett Garea Environments | 14,713.78 | Te Atatu Walkway |
| Building Industry Authority | 19,164.75 | Levy April |
| Building Research Association NZ | 29,639.32 | Levy April |
| Candle NZ Ltd | 12,656.25 | Service Fee |
| Cato Bolam Consultants Ltd | 17,546.16 | District Plan Coordinator |
| Chamonix Holdings Limited | 5,501.25 | Rent - Glen Eden Library |
| Christine Henley | 7,579.69 | Twin Streams Contract |
| City Contractors Ltd | 7,808.19 | Watermain Renewals |
| Civic Contractors Ltd | 36,347.38 | Litter Pick Up Contract |
| Civic Contractors/Onyx Group P/Ship | 40,015.36 | City Cleaning/Road Sweeping Contract |
| Civil Construction Group Ltd | 56,864.39 | Various Contracts - Ecowater |
| Civil Construction Group Ltd | 25,538.59 | Contractors Bond Refunds |
| Civil Construction Group Ltd | 72,996.01 | Minor Flood Restoration |
| Civil Construction Group Ltd | 13,450.77 | Archibald Park Sewer & Pump Station |
| Contact Energy Ltd | 14,871.35 | Gas Charges |
| Corban Revell (Alderman Drive) | 5,258.25 | Legal Fees |
| CSL Traffic Ltd | 11,503.24 | Walkway Lighting |
| Data Traffic | 19,628.88 | Traffic Counting |
| Datacom Systems Ltd | 33,631.21 | Computer Charges |
| Datacom Systems Ltd | 37,353.39 | Citrix Meta Frame & Security Gateway |
| Delta Software Ltd | 29,767.50 | Annual Maintenance |
| Denise Bijoux | 7,500.00 | Borrowing Costs |
| Department For Courts | 10,290.00 | Infringement Notices |
| Department For Courts | 7,830.00 | Infringement Notices |
| Department For Courts | 13,050.00 | Infringement Notices |
| Detection Services | 18,311.63 | Leak Detection |
| Drake Personnel NZ Limited | 7,205.77 | Temporary Staff |
| Drake Personnel NZ Limited | 6,013.17 | Temporary Staff |
| Edgecity Builders | 8,105.90 | Response Maintenance Building Contract |
| Edgecity Builders | 13,825.13 | Building Maintenance & Emergency Work |
| Edgecity Builders | 15,755.51 | Civic Centre Soffits |
| Electrix Ltd | 74,503.11 | Street Light Maintenance |
| Electrix Ltd | 38,851.42 | Street Light Maintenance |
| Electrix Ltd | 42,849.00 | Secondary Roads Streetlights |
| Eurest NZ Ltd | 12,072.92 | Catering |
| Excell Corp | 58,720.65 | Various Ecowater Contracts |
| Field Drainage Specialists Ltd | 49,592.67 | Sportsfield Maintenance - Sand Contract |
| Fortune Manning Law Partnership | 10,000.00 | Property Deposit |

| | | |
|---|------------|--|
| Fraser Thomas Ltd | 11,603.52 | Professional Services |
| Friends Of The Whau Inc | 14,123.26 | Project Whau |
| Fuji Xerox Finance Limited | 9,384.75 | Photocopier Leases |
| Fuji Xerox New Zealand Ltd | 23,846.03 | Copy Charges & Paper |
| Fuji Xerox New Zealand Ltd | 29,664.46 | Photocopy Charges March |
| Genesis Energy | 57,493.84 | Power Accounts |
| Genesis Energy | 11,513.59 | Power Accounts |
| Genesis Energy | 17,137.27 | Power Accounts |
| Griffiths Consulting Ltd | 13,979.00 | Contract For Legal Services |
| Haines Recruitment | 24,539.24 | Advertising |
| Halyard Investments Limited | 14,531.25 | Rent - VTS & COF Lane |
| Hansen International Australasia | 7,650.00 | Valuation Workshop |
| Hansen International Australasia | 15,348.38 | Hansen Support |
| Harrison Grierson Consultants Ltd | 7,609.71 | Professional Services |
| HEB Contractors | 25,946.85 | Unsealed Road Maintenance |
| Helio Graphics | 7,083.41 | Graphics, Printing Etc |
| Hughes Civil Ltd | 20,280.38 | Professional Services |
| Hughes Civil Ltd | 35,889.08 | Pump Station & Pipelines Mc21 Contract |
| Independent News Auckland Ltd | 9,990.50 | Advertising |
| Independent News Auckland Ltd | 10,101.39 | Advertising |
| Inland Revenue Department | 401,981.88 | P.A.Y.E |
| Inland Revenue Department | 357,483.47 | P.A.Y.E |
| Isthmus Group | 12,937.50 | Te Atatu Walkway |
| Jade Direct Ltd | 9,448.72 | Payroll Processing |
| Jian Gao | 14,458.00 | Work Bond Refund |
| John Andrew Ford | 34,075.18 | Motor Vehicle |
| John Andrew Ford | 69,067.58 | Motor Vehicles |
| John McDowell Trust Account | 552,045.35 | Land Purchase - Alderman Drive |
| John W Cargill Plumbing Ltd | 15,273.92 | Plumbing Repairs & Maintenance |
| John W Cargill Plumbing Ltd | 9,249.18 | Plumbing Contract |
| K J Earl | 9,858.38 | Painting Contractor |
| Kaon Technologies Ltd | 8,775.00 | Network Security Review/Internet Provider Fees |
| Kensington Swan | 50,717.16 | Legal Fees |
| Kensington Swan (Auckland) | 6,157.45 | Contract Solicitor |
| KPMG Legal | 86,921.84 | Legal Fees |
| KPMG Legal | 14,442.42 | Legal Fees |
| Land Information New Zealand | 12,700.00 | Rating Valuation Fees |
| Lendich Construction Ltd | 7,952.57 | Archibald Park Rehab |
| Lineset Graphics | 19,285.61 | Various Graphics & Printing |
| Lineset Graphics | 39,561.75 | Printing & Graphics |
| Liquid Waste Disposal Ltd | 21,299.65 | Wastewater Management |
| Local Government New Zealand | 110,738.44 | Subs 2003 & Eight Cities Project |
| Lopdell House Society Inc | 50,625.00 | Quarterly Payment |
| Lopdell House Society Inc | 32,062.50 | Grant |
| Mi Keogh Contractors Limited | 62,540.94 | 151 Parker Rd Slip Repair |
| Marsa Consultancy Ltd | 18,100.24 | Telemetry System |
| Marsa Consultancy Ltd | 7,008.26 | Uh7 Repairer/Telemetry Monitor |
| Matthew Casey Barrister | 26,189.46 | Legal Fees |
| Matthew Casey Barrister | 25,257.83 | Legal Fees |
| McDonald Vague & Partners | 32,652.65 | Rent - 131 Lincoln Rd |
| Mckenzie Project Services | 7,174.19 | Consents Contract Ecowater |
| Meritec Ltd | 10,441.22 | Parks Procurement Document |
| Mitchell Vranjes Consulting Engineers L | 9,562.50 | Pipe Bridge Renewals |
| Moore Gallagher | 6,870.71 | Printing |
| Murray & Buckley | 97,208.08 | Various Contracts Ecowater |
| Murray & Buckley | 6,359.06 | Fire Hydrant Meter Massey High School |
| Murray & Buckley | 35,410.16 | Watermain Upgrade Hobsonville |
| MWH New Zealand Ltd | 14,062.50 | Traffic Signal Audit Contract |
| N Z Police | 56,155.63 | Share Of Fines |
| Nasey Contractors Ltd | 36,441.90 | Pipe Bridge Renewals |
| Nasey Contractors Ltd | 16,094.32 | Contractors Bond/Pipe Bridge Renewals |
| Neil Group Limited | 7,790.00 | Bond Refunds Lake Panorama |
| Norcross Stationery Ltd | 9,839.32 | Stationery |
| NZC Tileworks Ltd | 39,507.75 | Tiling Contract Aquatic Centre |
| NZC Tileworks Ltd | 13,753.80 | Aquatic Centre Tiling |
| Octa Associates Ltd | 5,580.00 | Aquatic Centre Shutdown Maintenance |
| Onyx Group Ltd | 6,029.84 | Roadsweeping/Refuse Contractors |
| Onyx Group Ltd | 246,087.70 | Domestic & Recycle Rubbish |
| Parks & Maintenance Services Ltd | 25,756.99 | Reserves Development |
| Parks & Maintenance Services Ltd | 48,718.72 | Reserves Development |

| | | |
|--|--------------|--|
| Parks & Maintenance Services Ltd | 84,472.74 | Various Contracts |
| Paton Roofing Services Limited | 8,501.91 | Old Cab Massey Reroof Contract |
| Paul G Luckman | 7,301.25 | Multi Media Twin Streams Contract |
| Perry Waste Services Ltd | 40,594.78 | Composting Contract |
| Perry Waste Services Ltd | 59,408.05 | Waste Removal |
| Pipeline & Civil Ltd | 42,787.24 | 612 Swanson Rd |
| Pipeworks Rehabilitation Solutions | 124,929.84 | Easter Parade/Kemp Rd Wastewater |
| Pricewaterhousecoopers | 9,000.00 | Professional Services |
| Pro-Drill (Auck) Ltd | 7,381.13 | Various Contracts |
| Professional Property & Cleaning Service | 29,906.02 | Cleaning |
| Qmex Ltd | 9,674.71 | Various Contracts Ecowater |
| Quadpak Pulse Cpr | 6,030.00 | Safe Kids Campaign |
| Quotable Value N Z Ltd | 46,256.25 | Valuation Contract Fees |
| R H Jacobsen Ltd | 7,502.63 | Electrical Repairs |
| R J Hill Laboratories Ltd | 6,437.98 | Various Contract |
| R S T Alliance | 8,437.50 | Auckland Regional Sports & Recreation Strategy |
| Riley Consultants Ltd | 6,578.48 | Various Contract |
| Riteway Electrical Services | 85,875.19 | Various Contracts Ecowater |
| Roadstone Construction Ltd | 10,870.13 | Laingholm Park Development |
| Serco Group NZ Ltd | 6,965.20 | Flail Mowing |
| Signwise Industries (West Auckland) Ltd | 7,690.50 | Don't Litter Signs |
| Simpson Grierson (Auckland) | 5,217.92 | Legal Fees |
| Sinclair Knight Merz | 13,112.31 | Various Contracts |
| Sinclair Knight Merz | 51,815.71 | Various Contracts |
| Soil Engineering Ltd | 23,248.13 | Corban Winery Geotechnical Assess Contract |
| Southern Cross Healthcare | 56,890.93 | Healthcare |
| Southern Sky Books Ltd | 6,465.67 | Books (Libraries) |
| Sport Waitakere | 20,536.54 | Watermain Realign At Waitakere Stadium |
| Steve Nuich Panelbeaters & Spraypainters Ltd | 5,621.32 | Panelbeating |
| Stonedale Civil Contractors Ltd | 63,151.10 | Various Contracts |
| Sunrise Earthmovers Ltd | 112,579.99 | Harbourview Park Contract Physical Work |
| Suspended Ceiling 1997 Ltd | 97,301.88 | Ceiling Contract Aquatic Centre |
| Suspended Ceiling 1997 Ltd | 27,190.09 | West Wave Ceiling Maintenance |
| Tag Out Trust | 27,005.47 | Graffiti Contracts |
| Te Kawerau A Maki Trust | 19,023.25 | Contract Payment |
| Te Ngahere Limited | 36,310.53 | Parks Footbridge & Track |
| Techscape Limited | 14,265.13 | Various Contracts |
| Techscape Limited | 46,485.08 | Various Contracts |
| Techscape Limited | 66,311.41 | Various Contracts |
| Techscape Limited | 72,151.83 | Various Contracts |
| Techscape Limited | 46,474.12 | Sports Park Turf Maintenance |
| Techscape Limited | 466,906.67 | Various Contracts |
| Telecom New Zealand Ltd | 14,829.25 | Calls & Charges |
| Telecom New Zealand Ltd | 71,040.36 | Calls & Charges |
| Terracon Coatings Ltd | 29,086.59 | Roof Waterproof Reservoirs |
| The Library Supply Company Limited | 7,207.50 | Books |
| The Weedfree Waitakere Trust | 8,547.52 | Weed Control |
| The Weedfree Waitakere Trust | 42,648.82 | Weed Control |
| Thom Contractors Ltd | 7,613.02 | Retentions |
| Thomas Civil Consultants Ltd | 7,314.07 | Shared Driveway Input |
| Thomas Civil Consultants Ltd | 10,968.75 | Outsource Subdivision |
| Tonkin & Taylor Ltd | 5,301.36 | Huia Seawall |
| Top Cut Construction Ltd | 76,639.96 | West Wave Maintenance |
| Total Library Solutions | 5,087.56 | Books |
| Total Traffic Services Ltd | 54,155.97 | Traffic Signal Maintenance |
| TSE Group Ltd | 5,491.61 | Various Contracts |
| URS New Zealand Ltd | 28,273.18 | Various Contracts |
| URS New Zealand Ltd | 5,842.45 | Various Contracts |
| URS New Zealand Ltd | 25,394.87 | Various Contracts |
| Waitakere City Council | 18,205.48 | Water Accounts |
| Waitakere Community Resource Centre | 20,000.00 | Additional Funding |
| Waitakere Corporate Limited | 6,187.14 | Professional Services April |
| Waitakere Properties Ltd | 33,851.25 | Works Bond Refund |
| Waste Management NZ Ltd | 102,366.18 | Waste Diposal |
| Waste Management NZ Ltd | 232,575.31 | Waste Diposal |
| Watercare Services Limited | 1,919,459.25 | Bulk & Wastewater April |
| Watertight Limited | 5,452.76 | Crematorium Re-Roofing |
| Watertight Limited | 19,084.67 | Crematorium Re-Roofing |
| Watson Investment Trust | 10,312.50 | Rent - 133 Central Park Drive |
| Whitcoulls Ltd | 16,531.11 | Books |

| | | |
|--|----------------------|-----------------------------------|
| Wilson Sylvan Ltd | 6,435.00 | Parks Contract |
| Wildland Consultants Ltd | 6,175.58 | Weed Control Contract |
| Works Infrastructure Ltd | 112,988.29 | North/South Candia Link |
| Works Infrastructure Ltd | 95,673.65 | Kerb, Footpath, Drainage Contract |
| Y M C A Massey Leisure Centre | 12,375.00 | Grant |
| Total Payments as Above | 9,722,286.58 | |
| Other Payments as per Agenda Item | 51,686,480.42 | |
| Total Payments as per Agenda Item | 61,408,767.00 | |



A30



A31