

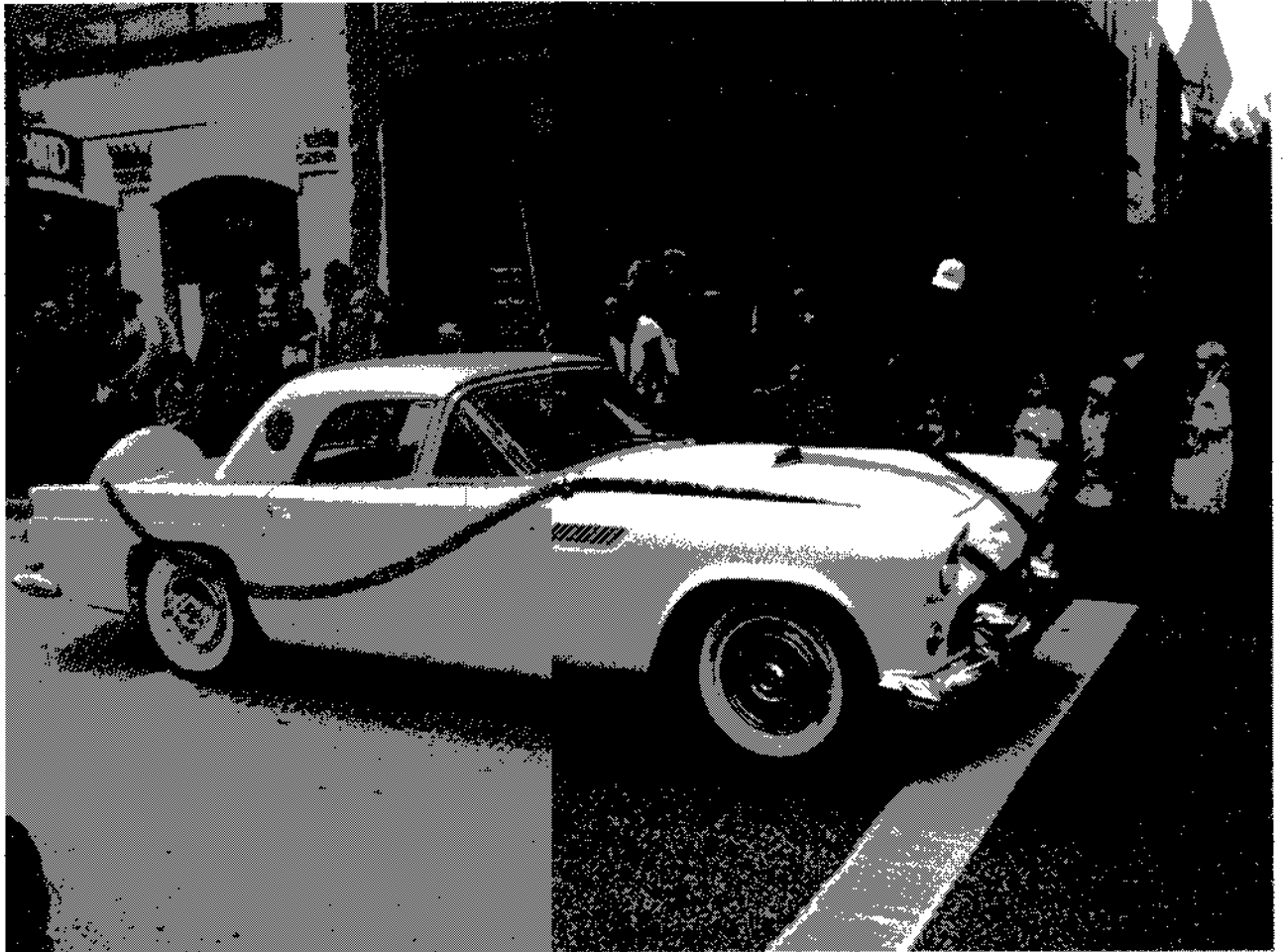

Christmas parade in Santa Cruz. Funky characters who would look right at home in Henderson abound.

DSC00007



DSC00008

It amazes me that an auto industry that could produce cars like this is now in crisis.
they need to look back to their future.



DSC00012

Santa is pretty much the same everywhere.



DSC00107

Lake Tahoe lies on the border between California and Nevada. Nevada casinos seem a world away from this scene.

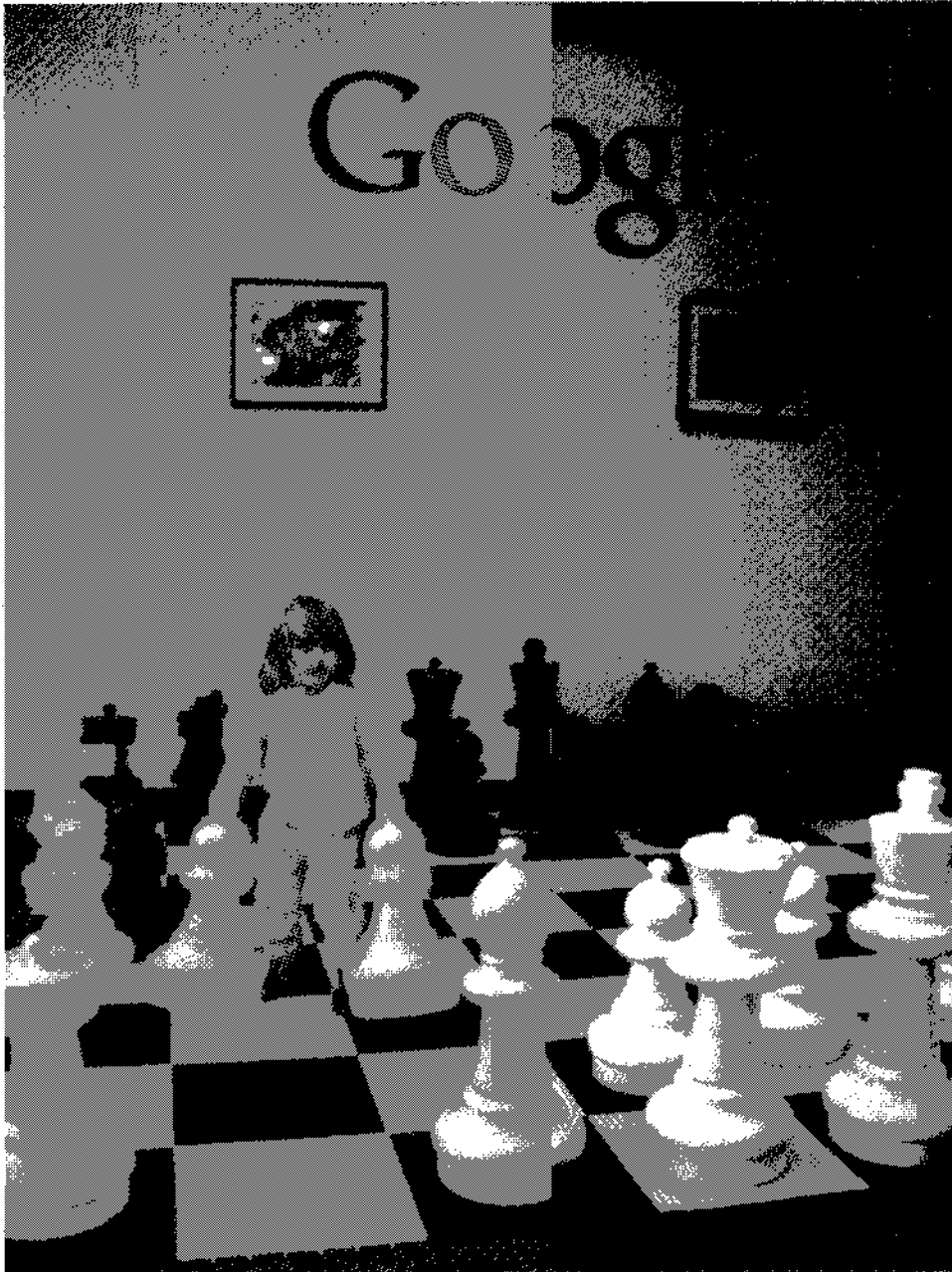

DSC00229

Google focuses on providing a fun place to work. My granddaughter Taylin is playing chess.



DSC00375

My new grandson, Kian Witten-Hannah



DSC00389

Thanks to the generosity of the owner we were able to spend 3 days in this Hacienda above Santa Cruz. Ten minutes drive from downtown Santa Cruz and you are deep in the countryside.



DSC00673 Mayor Brown and Mayor Harvey on the Hillary Trail

NOTES:
 1. FOOTINGS TO BE IN ACCORDANCE WITH WCC STANDARD DRAWING SD 1.02.
 2. KERBS AND CHANNELS TO BE MACHINE Laid. VERTICAL KERBS AND CHANNELS IN ACCORDANCE WITH WCC STANDARD DRAWING SD 1.04.
 3. ALL NEW KERBS AND CHANNELS TO HAVE UNDERCHANNEL DRAINS INSTALLED IN ACCORDANCE WITH WCC STANDARD DRAWING SD 1.06.
 4. VEHICLE ACCESS TO BE MAINTAINED TO PROPERTIES AT ALL TIMES.
 5. EXISTING FOOTPATH TO BE DEMOLISHED AND REMOVED OFF SITE OVER EXTENSIVE OF WORKS AS INDICATED ON THE DRAWING. SAWCUT EXISTING SEAL WHERE NEW PAVEMENT JOINS EXISTING. TREE SYMBOLS ARE INDICATIVE ONLY AND ARE NOT TO SCALE.
 6. EXISTING BOLLARDS TO BE REMOVED OFF SITE.
 7. CONTRACTOR TO LOCATE AND PROTECT ALL EXISTING SERVICES PRIOR TO WORK COMMENCING.

REV	DATE	DESCRIPTION
A	06/10/09	FOR COMMENT

MSC Consulting Group Ltd.
 12 - 14 Cromwell Street, P.O. Box 30188
 Auckland 1141, Auckland New Zealand
 Telephone: +64 9 308 9999
 Fax: +64 9 308 9998
 www.mscgroup.co.nz

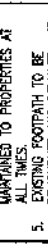

WAITAKERE CITY COUNCIL
 TRANSPORT ASSETS

CONTRACT NO: TA08049A
 PEDESTRIAN FACILITY
 IMPROVEMENTS
 AROUND TRAIN STATIONS
 GLEN EDEN STATION
 ROADING AND DRAINAGE
 PLAN

DESIGNED	SMALL	3/07	AUG 2009
DRAWN	DC-HL	CHECKED	
	A1 SCALE	1:200	A3 SCALE
	DATE	1/10/09	

30286 C.211 A

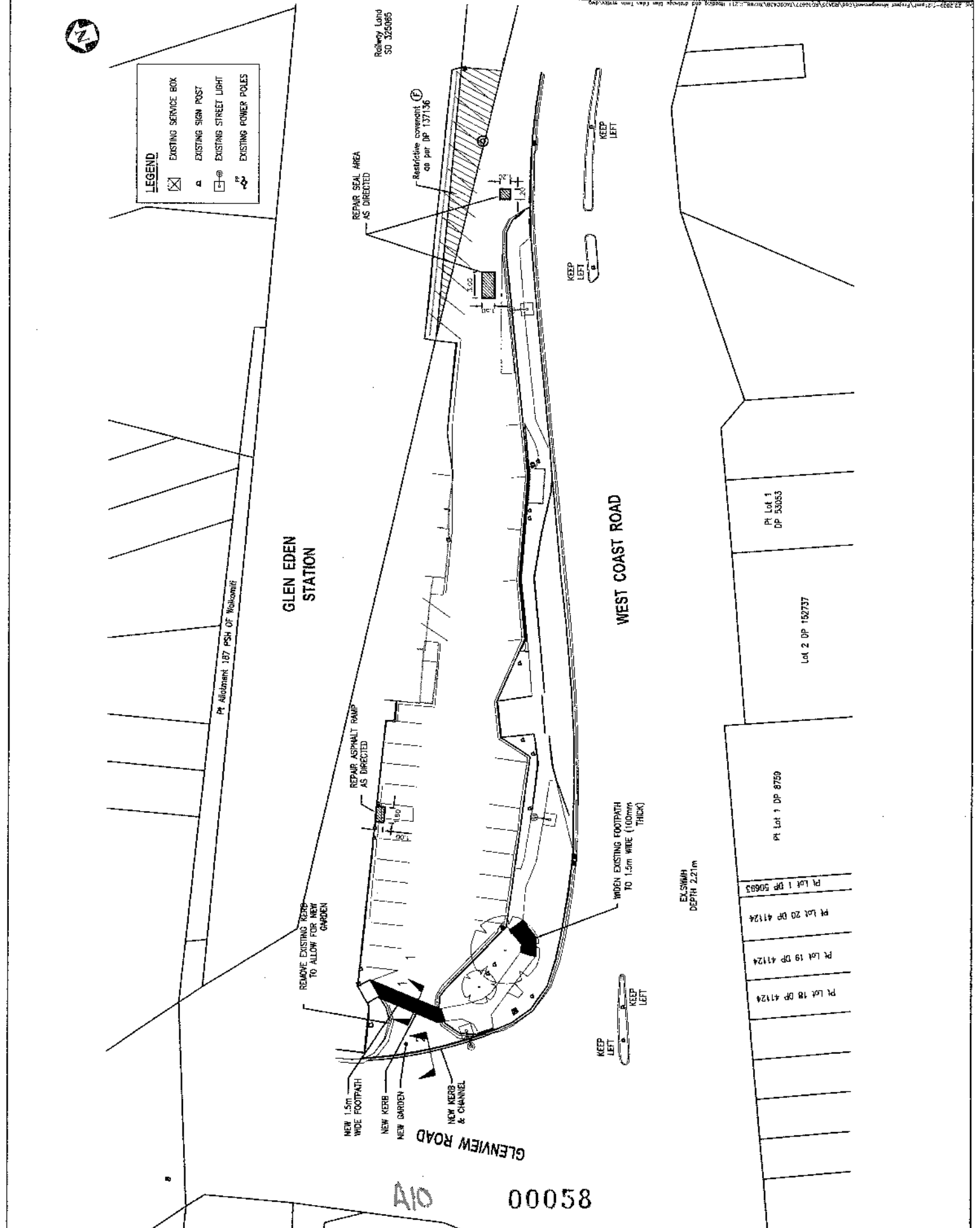

A10 00058

ALL WORK TO BE ACCORDANCE WITH WCC STANDARD DRAWING SD.3.02
 CONTRACT NO: TA08049A
 PROJECT: PEDESTRIAN FACILITY IMPROVEMENTS AROUND TRAIN STATIONS
 OPTION 1 - SWALE

- NOTES:**
1. FOOTPATHS TO BE IN ACCORDANCE WITH WCC STANDARD DRAWING SD.3.02
 2. KERB AND CHANNEL TO BE MACHINER LAD VERTICAL KERB AND CHANNEL IN ACCORDANCE WITH WCC STANDARD DRAWING SD.3.04
 3. ALL NEW KERB AND CHANNELS TO HAVE UNDERCHANNEL DRAINS INSTALLED IN ACCORDANCE WITH WCC STANDARD DRAWING SD.3.06
 4. CATCHPIT TO BE IN ACCORDANCE WITH WCC STANDARD DRAWING SD.3.06
 5. VEHICLE ACCESS TO BE MAINTAINED TO PROPERTIES AT ALL TIMES
 6. LOCATIONS OF NEW STREET LIGHTS TO BE CONFIRMED ON SITE WITH THE ENGINEER
 7. EXISTING FOOTPATH TO BE DEMOLISHED AND REMOVED OFF SITE OVER EXTENTS OF WORKS AS INDICATED ON THE DRAWING
 8. SAWCUT EXISTING SEAL WHERE NEW PAVEMENT JOINS EXISTING TREE SYMBOLS ARE INDICATIVE ONLY AND ARE NOT TO SCALE
 9. EXISTING BOLLARDS TO BE REMOVED OFF SITE
 10. CONTRACTOR TO LOCATE AND PROTECT ALL EXISTING SERVICES PRIOR TO WORK COMMENCING

NO.	DESCRIPTION	DATE	BY	CHECKED
1	ISSUED FOR TENDER			
2	REVISED			

MSC Consulting Group Ltd.
 12 - 14 Grove Street, P.O. Box 31,406
 Telokeme 2022, Auckland, New Zealand
 Tel: 09 232 2122 Fax: 09 232 2123 www.msc.co.nz

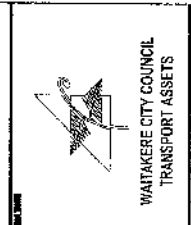

WAITAKERE CITY COUNCIL TRANSPORT ASSETS	
CONTRACT NO: TA08049A	
PEDESTRIAN FACILITY IMPROVEMENTS AROUND TRAIN STATIONS	
WAITAKERE STATION	
ROADING AND DRAINAGE OPTION 1 - SWALE	
DESIGNED	DATE: AUGUST 2009
DRAWN	DATE: 14/08
AT SCALE	AS SHOWN
NO. 30286	REV. NO. C.611
	REV. NO. A

LEGEND

- EXISTING SERVICE
- 8BX
- EXISTING SIGN POST
- EXISTING STREET LIGHT
- EXISTING POWER POLES
- FINISHED PAVEMENT LEVELS

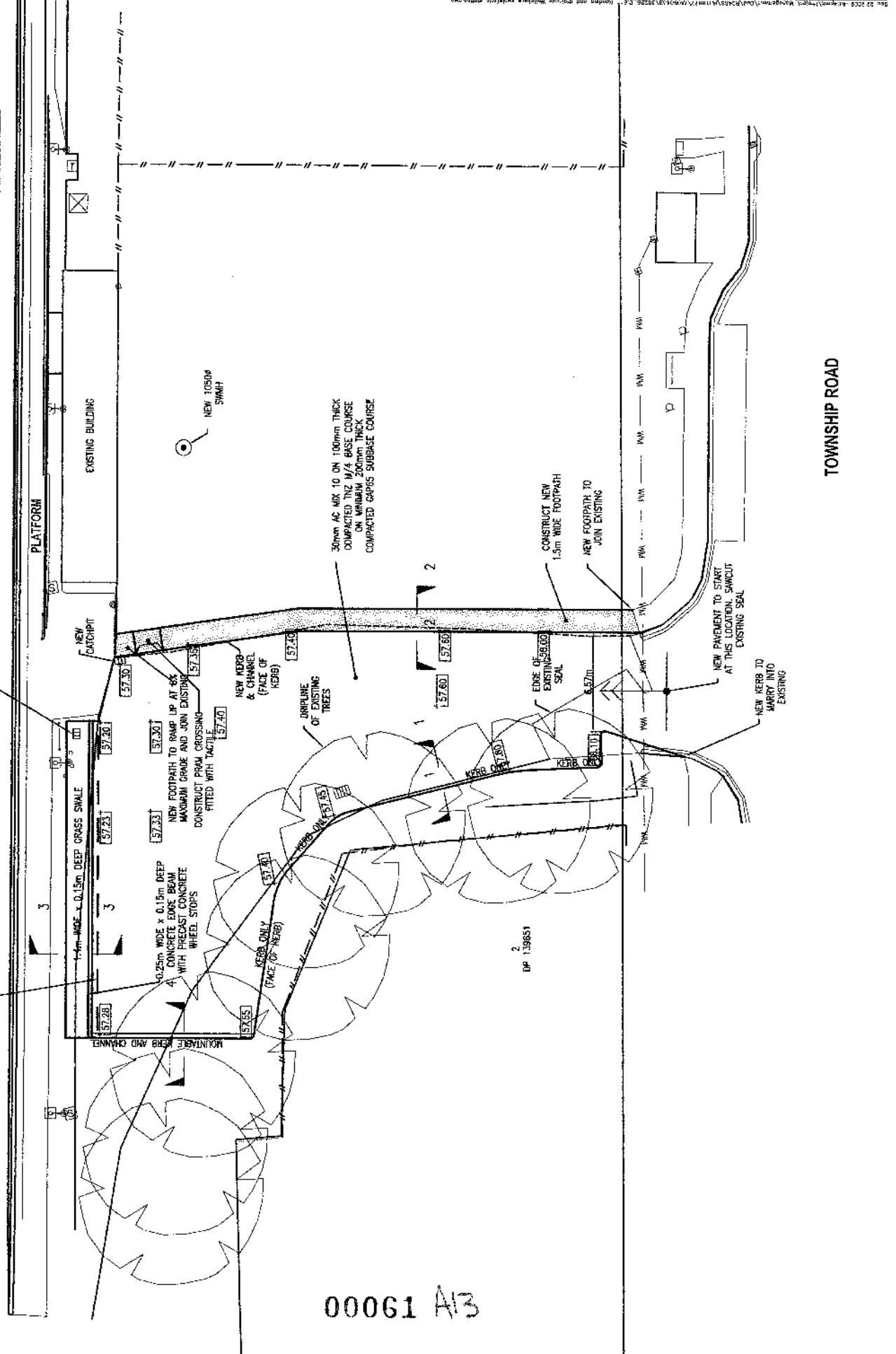

TOWNSHIP ROAD

00061 A/B

Deane Avenue

5

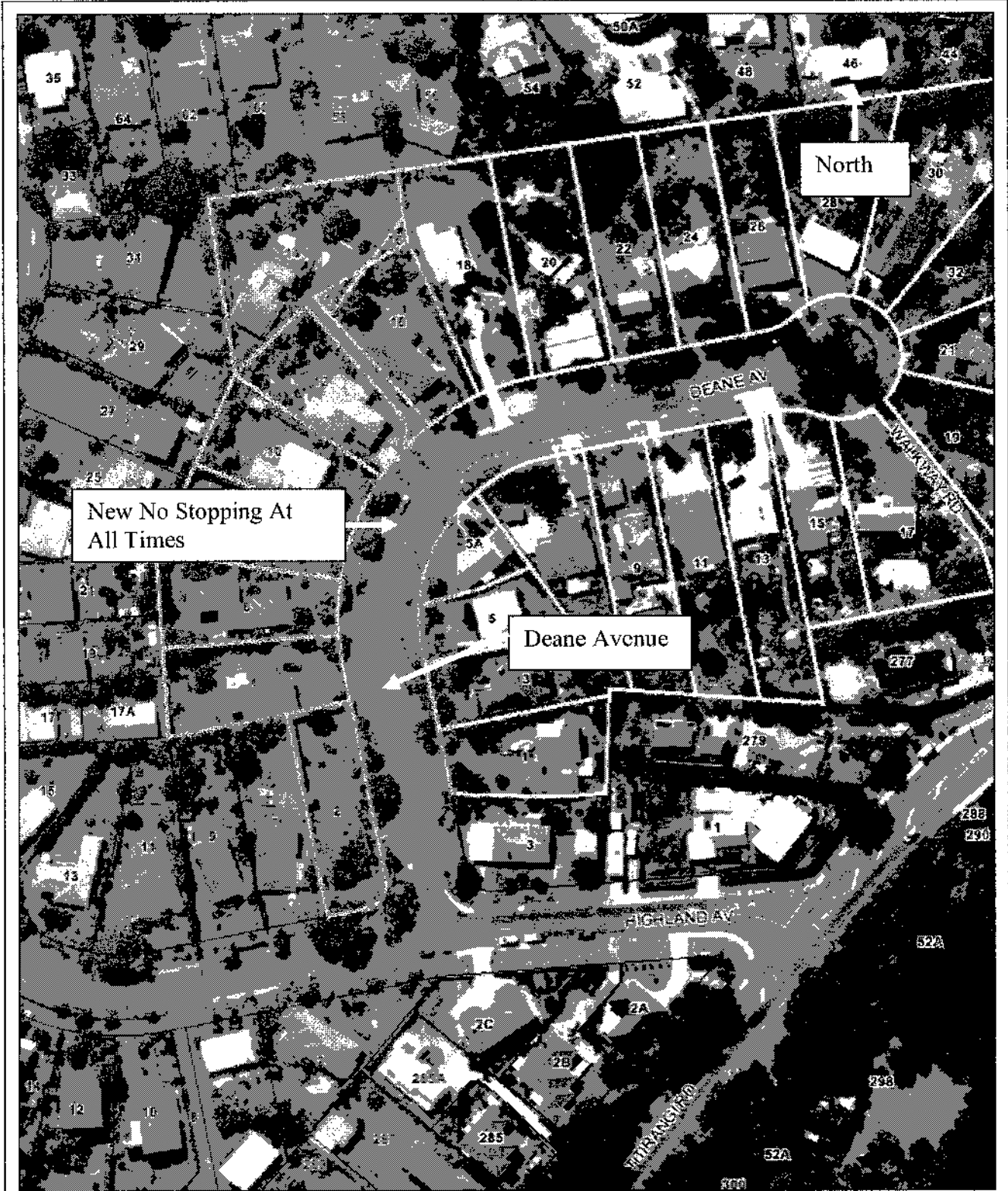

New No Stopping At All Times

Deane Avenue

24/11/2009

Geospatial information from Land Information New Zealand and Digital Cadastre Database (D/CDB) Crown Copyright Reserved

Scale = 1:1,000

Services shown on public internet maps are not public domain unless used as through links. While Council endeavours to provide accurate spatial data no guarantee as to the completeness and accuracy of the data shown on this plan can be given. All information including levels and locations are not to be relied upon for any purpose. For enquiries about the information shown please phone the call centre 09 929 4144.



00077 A14

Wood Bay Road

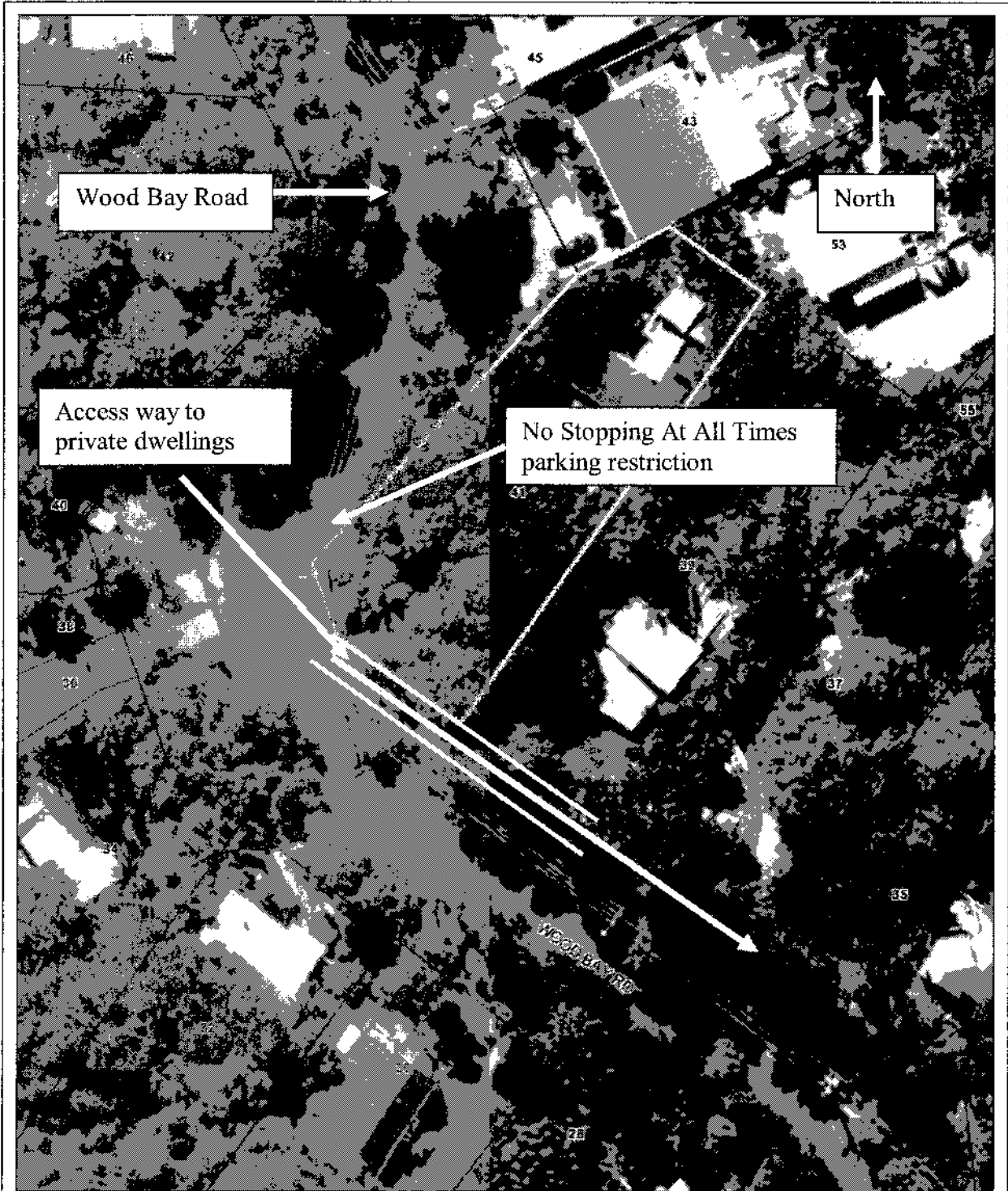

28/11/2009

Cadastral information from:
Land Information New Zealand
Digital Cadastral Database (DCDB)
Crown Copyright Reserved

Scale = 1:4000 A4

Services shown on public domain land are not public domain unless used as through roads. While Council endeavours to provide accurate aerial data, we guarantee as to the completeness and accuracy of the data shown on this plan can be given. All information, including levels and boundary lines, is for information only and should be verified on site. For enquiries about the information shown please phone the call centre (09) 438 1111.



CFCWF Application: WAIATARUA RESIDENTS & RATEPAYERS ASSN

Funding Round: 2009

Printed: 11 Jan 2010

CA

Organisation:

Address: 911 West Coast Road
Waiatarua
WAITAKERE 0604

Ward Location: Waitakere
Parent Body:
Incorpor. Society: Not Applicable
Membership:
GST Registered: Not Applicable
GST #:

Fax:
Phone:

Other Funding:

Round		Project Summary	Requested	Allocated	Completed
2003	CFHALLS	General running expenses & maintenance	\$3,000.00	\$2,800.00	yes
2004	CFHALLS	Chairs	\$3,000.00	\$2,450.00	yes
2005	CFHALLS	Tables	\$3,000.00	\$3,000.00	yes
2006	CFHALLS	Equipment and promotional material.	\$2,800.00	\$2,580.00	yes
2008	CFCWF	Purchase of new equipment	\$1,500.00	\$1,500.00	yes
2008/1	CFHALLS	Cleaner/caretaker	\$1,600.00	\$1,600.00	yes

Application:

CWF App #: 1252
Contact: Dave
Surname: Pocock
Phone: 814-9697
Evening: 027 490 4064

Contact: Tony
Surname: Bacon
Phone: 814-9860
Evening:

Purpose of Grant: Replacement of two aging table tennis tables

Project Details: Describe the programme, project or service for which you wish to apply for funding- We wish to replace two ageing table tennis tables for our Wednesday night table tennis group. We recently brought one new one to increase table numbers to three to accommodate increasing numbers. The tables we wish to replace are heavy and are getting quite wobbly after 4 years of solid use.

What community benefits will result from your project- the group activity is administered by Tony Bacon and Les Duffield on behalf of the Waiatarua and is totally for community minded activity which participants are charged a minimal \$2.00 per head to cover basic overheads. We supply tables, bats and balls all inclusive.

Who will benefit- Anyone regardless of age or sex are more than welcome to attend and current age ranges from 14-65 years of age so this is a benefit to the whole community.

Comments:

Project Start Date:		Project End Date:	
Major. of Particip.:	Waitakere	Part Funding OK:	Yes
Committee:	Waitakere Community Board	Spec. Ethn. Group:	All Ethnicities
Cult/Ethnic Group:	OTHER - Other	Strat. Outcome:	COMMS - Strong Communities
Priority Group:		Project Type:	EQUIPMENT - Equipment

Cost Description	Cost	Income Description	Income
2x table tennis tables	\$900.00	Total Contribution:	\$0.00
Total Cost:	\$900.00		

Eligible: Yes **Requested:** \$900.00 **Recommended:** \$800.00

A16

CFCWF Application: KARAMATURA HERITAGE FARM TRUST

Funding Round: 2009

Printed: 11 Jan 2010

Organisation:

Address: 1126 Huia Road
 Huia
 WAITAKERE 0604

Ward Location: Waitakere

Parent Body:

Incorpor. Society: Yes

Membership:

Fax:

Phone: 8118672

GST Registered: No

GST #:

Other Funding:

Application:

CWF App #: 1253

Contact: Carl

Surname: Harding

Phone: 811-8672

Evening:

Contact: George

Surname: Wadsworth

Phone: 811-8972

Evening:

Purpose of Grant: Upgrade of our farm trailer to safety standards

Project Details: What are you seeking funding for- to upgrade our farm trailer to safety standards so we can provide hay rides for the children on farm day and open days. Transport the not so agile grandparents to various parts of the farm with their grandchildren.

Comments: Trust commenced operations on 1/04/2009

Income to date - \$2,275.00
 Expenditure to date - \$902.00
 Surplus to date - \$1,373.00

Project Start Date:

Major. of Particip.: Waitakere

Committee: Waitakere Community Board

Cult/Ethnic Group: OTHER - Other

Priority Group:

Project End Date:

Part Funding OK: Yes

Spec. Ethn. Group: All Ethnicities

Strat. Outcome: COMMS - Strong Communities

Project Type: EQUIPMENT - Equipment

Cost Description	Cost	Income Description	Income
Equipment to improve the safety of the trailer	\$485.23	Total Contribution:	\$0.00
Total Cost:	\$485.23		

Eligible: Yes

Requested: \$485.23

Recommended: \$385.23

Organisation:

Address: 41 Whatipu Road
Huia
WAITAKERE 0604

Ward Location: Waitakere
Parent Body: Ministry of Education
Incorpor. Society: Yes
Membership:
GST Registered: No
GST #:

Fax:
Phone: 8118098

Other Funding:

Application:

CFW App #: 1254
Contact: Helen
Surname: Pellett
Phone: 816-8040
Evening: 021 042 4159

Contact: Jean
Surname: Stewart
Phone: 811-8098
Evening:

Purpose of Grant: Purchase of outdoor playhouse and other equipment

Project Details: Describe the programme, project or service for which you wish to apply for funding- we are the Huia Playgroup and our project is to upgrade the whole outdoor playground at the Huia Playground/ Huia Ratepayers Hall. So far we have had a grant and fixed the drainage problem and also payed for the area to be re barked. We held a fundraising dance and raised \$961.00 (for previous works undertaken). We look to spend that and any grant donations on a playhouse and other outdoor equipment e.g. seesaw and veggie garden. Huia playgroup is a volunteer run group. We run every Friday providing a safe, fun and stimulating meeting place for preschoolers and their parents.

What community benefits will result from your project- the community benefits from the new playground will be many. The playground will benefit both playgroup members the local community and any users of the hall, which in turn will benefit the ratepayers association, making the hall a attractive place for people with children to hold events. Completion of this project by us the volunteers at Huia playgroup will strengthen community ties and interest in the local community for all our members.

Comments:

Project Start Date:		Project End Date:	
Major. of Particip.:	Waitakere	Part Funding OK:	Yes
Committee:	Waitakere Community Board	Spec. Ethn. Group:	All ethnicities
CuN/Ethnic Group:	OTHER - Other	Strat. Outcome:	COMMS - Strong Communities
Priority Group:	CHILD - Children	Project Type:	EQUIPMENT - Equipment

Cost Description	Cost	Income Description	Income
Magic rainbow garden setting	\$1,575.00	Fundraising	\$75.00
Total Cost:	\$1,575.00	Total Contribution:	\$75.00

Eligible: Yes **Requested:** \$1,500.00 **Recommended:** \$1,199.38

A18

CFCWF Application: ORATIA RESIDENTS & RATEPAYERS ASSOCIATION

Funding Round: 2009

Printed: 11 Jan 2010

Organisation:

Address: PO Box 20184
Glen Eden
WAITAKERE 0641

Ward Location: Waitakere
Parent Body:
Incorpor. Society: Not Applicable
Membership:
GST Registered: Yes
GST #: 38/971/174

Fax:
Phone: 8182499

Other Funding:

Round		Project Summary	Requested	Allocated	Completed
2003	CFHALLS	Small hall - Playground upgrade	\$3,000.00	\$2,950.00	yes
2003	CFHALLS	Settlers Hall - Playground upgrade	\$3,000.00	\$2,950.00	yes
2005	CFHALLS	Cupboards for Settlers Hall	\$2,500.00	\$2,500.00	yes
2006	CFHALLS	Upgrades to Settlers Hall	\$2,756.00	\$2,526.00	yes
2006	CFHALLS	Upgrades to Small hall	\$1,900.00	\$1,759.00	yes
2007/2	CFHALLS	Settlers Hall - coverage of open deck	\$3,000.00	\$3,000.00	yes
2007/2	CFHALLS	Small Hall - Storage	\$3,000.00	\$3,000.00	yes

Application:

CWF App #: 1255
Contact: Neil
Surname: Allport
Phone: 818-2499
Evening: 027 481 6925

Contact: David
Surname: Harre
Phone: 818-7816
Evening:

Purpose of Grant: Albionvales 130th Birthday Celebration.

Project Details: Describe the programme, project or service for which you wish to apply for funding- to help celebrate Albionvale's 130th Birthday in Oratia.

What community benefits will result from your project - Oratia museum, Oratia Residents will be able to view Albion Vale House the museum in working stage, steam engine will also be working.

Who will benefit - residents and visitors will be able too see a piece of Oratia history come alive for a day. Albionvale and the Oratia residents have a 100 year history of events and picnics usually on new years day, but this birthday we have decided to celebrate early.

Comments:

Project Start Date:
Major. of Particip.: Waitakere
Committee: Waitakere Community Board
Cult/Ethnic Group: OTHER - Other
Priority Group:

Project End Date:
Part Funding OK: Yes
Spec. Ethn. Group: All ethnicities
Strat. Outcome: COMMS - Strong Communities
Project Type: PROJECT - Project / Events

Cost Description	Cost	Income Description	Income
Portaloos	\$150.00	Total Contribution:	\$0.00
Museums	\$180.00		
Potatoes	\$40.00		
Music, local	\$100.00		
Total Cost:	\$470.00		

Eligible: Yes **Requested:** \$470.00 **Recommended:** \$ 400.00

AR